



# Manual welding torches MTGs / MTWs



Fronius International, PM Welding Torches  
Information Class: Confidential

MTG**s**

MIG Torch Gascooled

**S**tandard welding torch



MTW**s**

MIG Torch Watercooled

**S**tandard welding torch

# Manual welding torches

## MTGs / MTWs

- **New generation of manual welding torches with a focus on ...**
  - ... Steel applications
  - ... Simple and convenient handling
  - ... Robustness
  - ... Good price/performance ratio
- 
- **Target customers:** Small and medium-sized enterprises



# Manual welding torches

## MTGs / MTWs

- Sales start from 15.11.2024
- Official product launch of the products with the Fortis power source in June 2025



# Variants gascooled



**MTG 270s**



**MTG 400s**



**MTG 320s**



**MTG 500s**

# Variants watercooled



**MTW 320s**



**MTW 400s**



**MTW 500s**

# Variants & technical data

Gascooled	Power / duty cycle	Power / duty cycle	Wire diameter
MTG 270s	270A / 40% CO <sub>2</sub> 200A / 40% mixed gas	170A / 100% CO <sub>2</sub> 140A / 100% mixed gas	0.8 - 1.2 mm
MTG 320s	320A / 40% CO <sub>2</sub> 260A / 40% mixed gas	210A / 100% CO <sub>2</sub> 170A / 100% mixed gas	0.8 - 1.6 mm
MTG 400s	400A / 40% CO <sub>2</sub> 320A / 40% mixed gas	260A / 100% CO <sub>2</sub> 210A / 100% mixed gas	0.8 - 1.6 mm
MTG 500s	500A / 35% CO <sub>2</sub> 420A / 35% mixed gas	300A / 100% CO <sub>2</sub> 260A / 100% mixed gas	0.8 - 1.6 mm
Watercooled	Power / duty cycle		Wire diameter
MTW 320s	320A / 100% CO <sub>2</sub> and mixed gas		0.8 - 1.6 mm
MTW 400s	400A / 100% CO <sub>2</sub> and mixed gas		0.8 - 1.6 mm
MTW 500s	500A / 100% CO <sub>2</sub> and mixed gas		0.8 - 1.6 mm



## Variants:

**Operation:** Standard, Up/Down **Welding torch lengths:** 3.5m, 4.5m, 6m **Central connections:** FSC, Euro

# Manual welding torches

## MTGs / MTWs

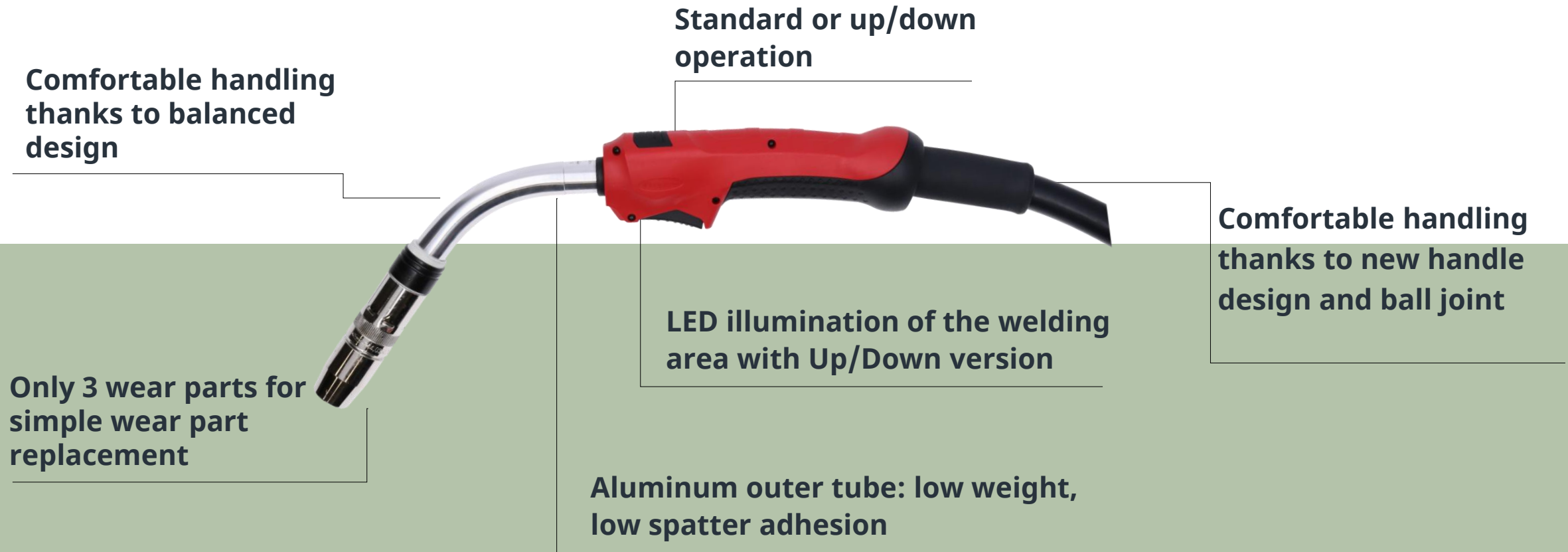



# UserInterface

**Standard**



- **Without operation** on the welding torch
- **Without LED**

**Up/Down**

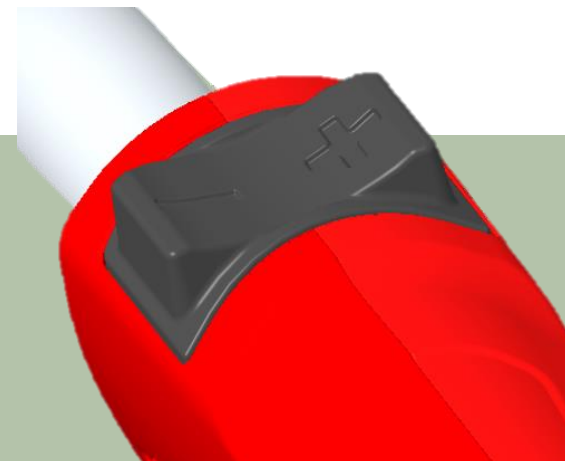

- **New Up/Down user interface**
  - Change the welding power in synergic mode using the Up/Down buttons
- **With LED lighting**
  - is activated by means of a motion sensor

# Up/Down UserInterface

Increased ease of use thanks to the new design of the up/down buttons

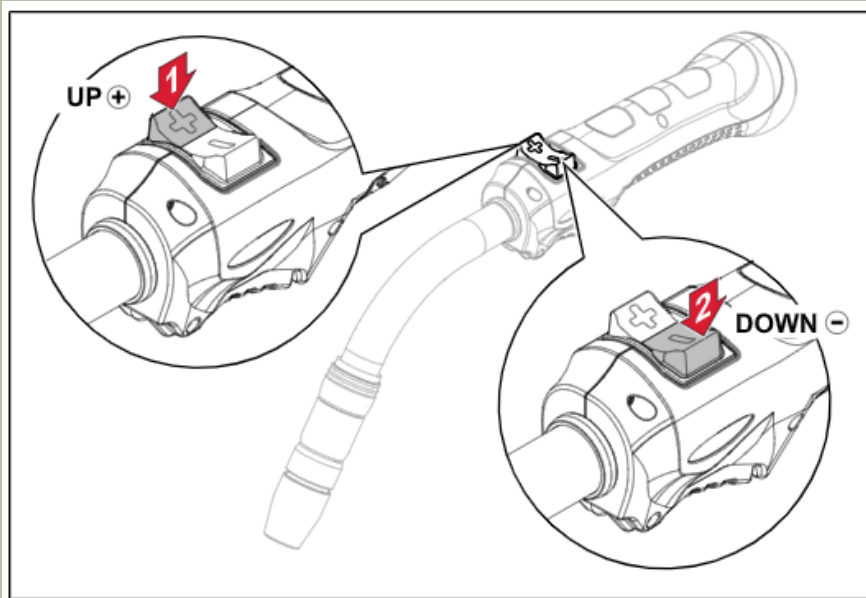
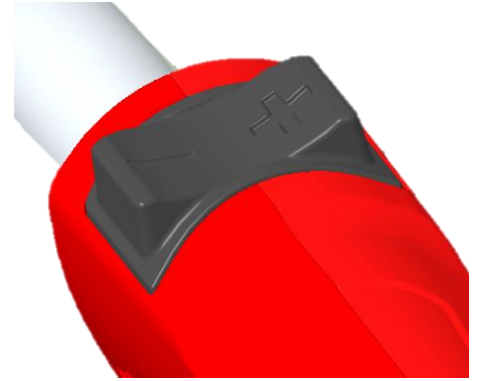

- - is executed on the left
- + is executed on the right
- Easier to press buttons while welding
- Prevents the minus button from being pressed unintentionally

# LED illumination of the welding area

Illumination of the welding point  
before and after welding

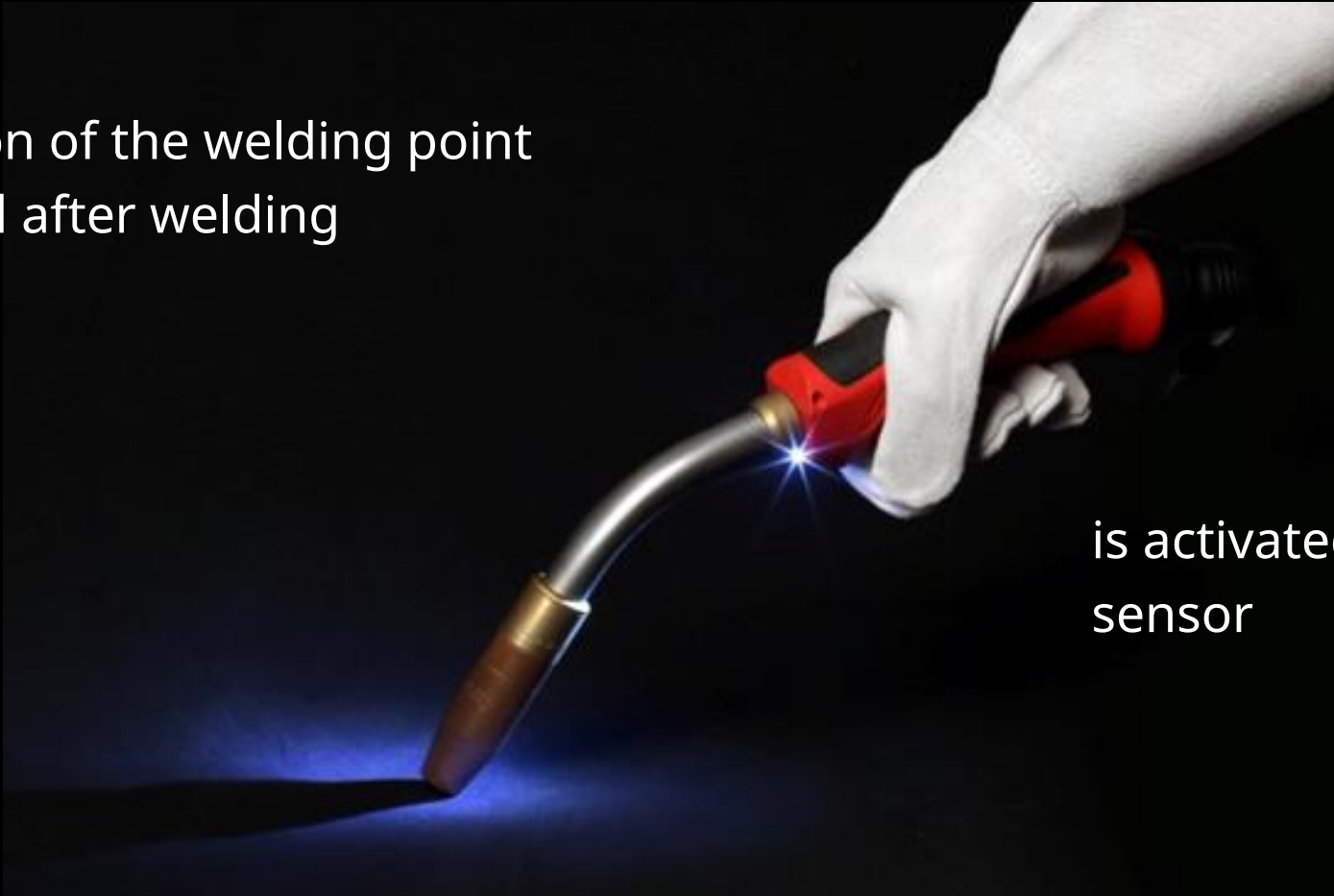

is activated by means of a motion  
sensor

# In Balance



Torch body length and angle are optimally aligned (balanced)  
for each torch type



# Gascooled

- MTG 270s Torch body angle 45°

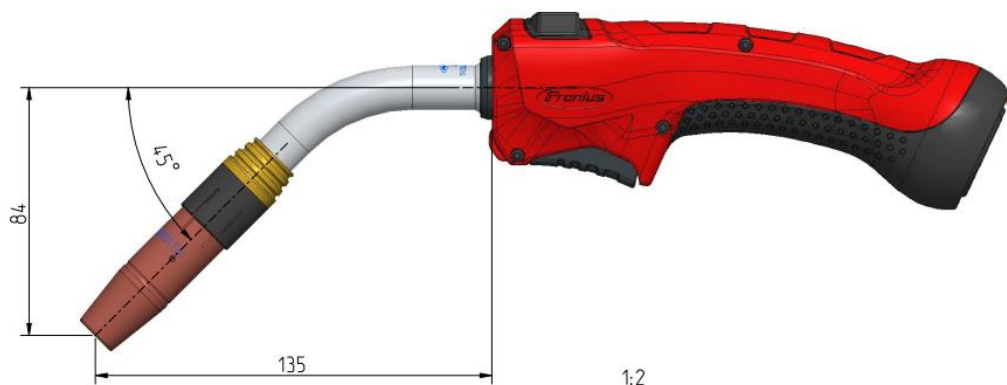

- MTG 320s Torch body angle 45°

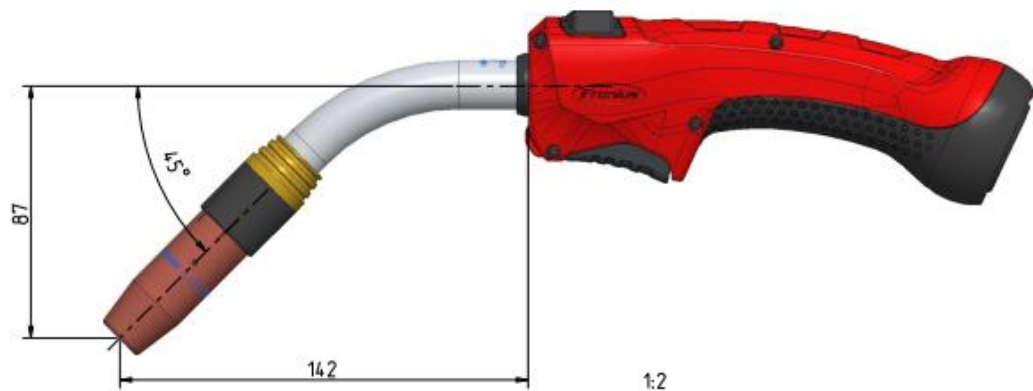

- MTG 400s Torch body angle 55°

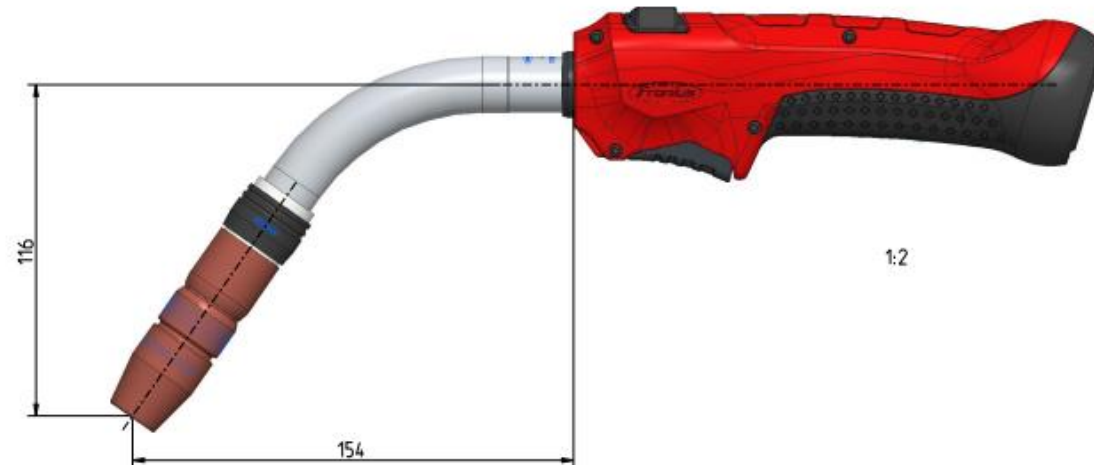

- MTG 500s Torch body angle 55°

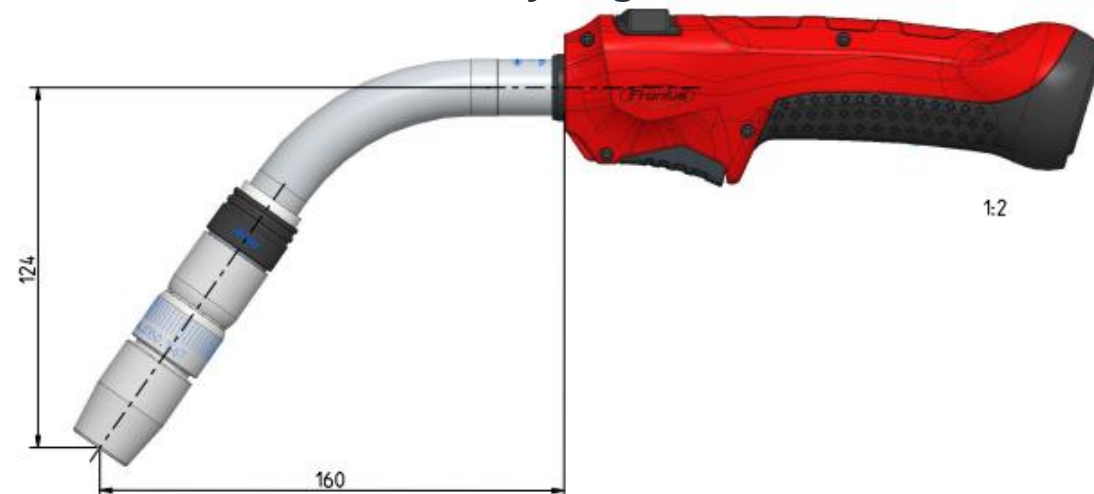

# Watercooled

- MTW 320s Torch body angle 45°

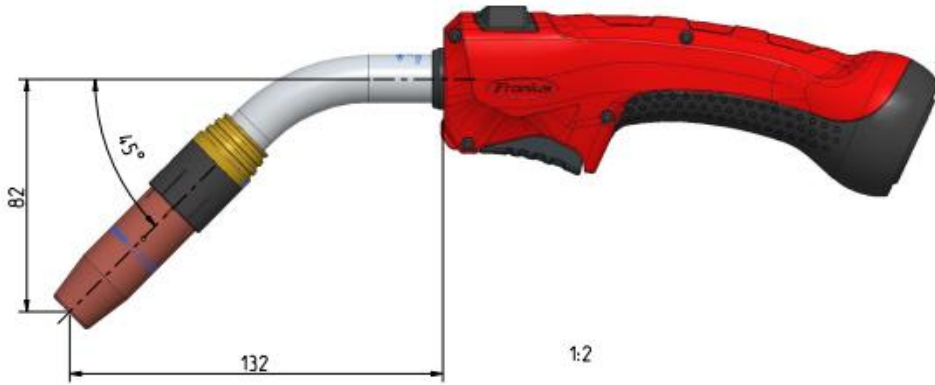

- MTW 400s Torch body angle 45°

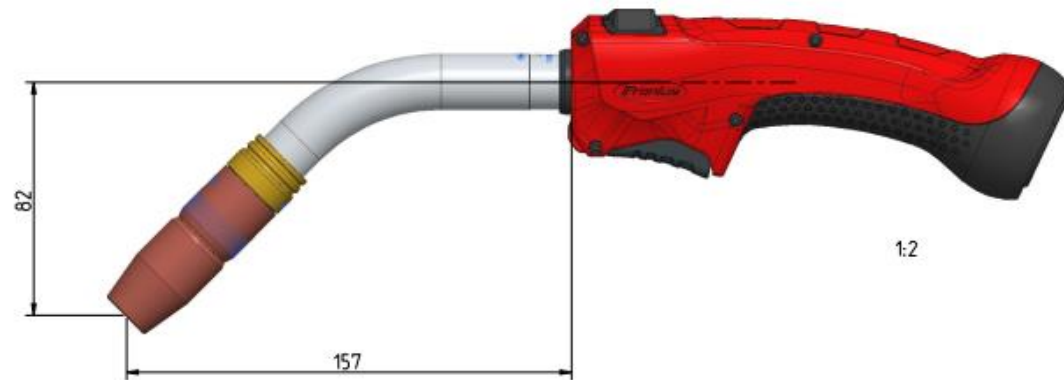

- MTW 500s Torch body angle 45°

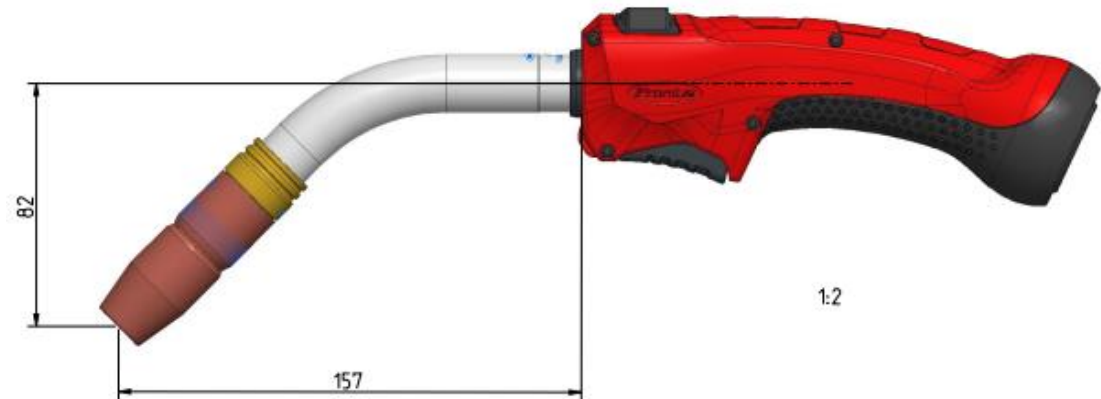

# Handles

- Two handle sizes
- MTG 270s, MTG 320s,
- MTW 320s, MTW 400s, MTW 500s
- MTG 400s, MTG 500s



# Central connections

## FSC connection

- for Fortis, TPS/i (from software version 4.1.1), TransSteel, iWave power sources



## Euro connection

- For competitor power sources and TPS with Euro connection
- Standard user interface only (no Up/Down, no LED)





# Function overview

Function	MTGs / MTWs	MTG i / MTW i
Steel welding	Very good	Very good
Aluminum, CuSi, CrNi welding	Good	Very good
Distance to the power source / wire feeder	Max 6m and up to 25m with the FlexDrive	Up to 16m with the PullMig and up to 25m with the FlexDrive
CMT welding	No	Yes, with the PullMig CMT
Multilock variant	No	Yes
Fume extraction set	No	Yes
Standard variant with LED	No	Yes
Special hose pack length	No	Yes
Special torch body geometries	No	Yes
Trigger on the top	No	Yes
Potentiometer	No	Yes
T-Handle	No	Yes
Long torch trigger	Yes	Yes
Heat protection shield	Yes	Yes

Wear parts

# Only 3 wear parts

- Simplified handling due to reduction of wear parts
- Insulation is integrated in the gas nozzle

- **MTG 270s, MTG 320s, MTW 320s:**

- Plug-in gas nozzle: easier handling

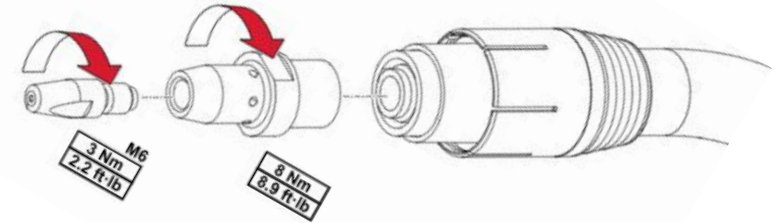
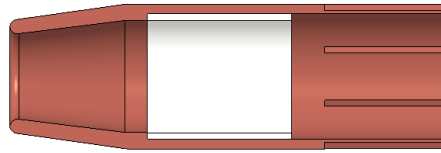

- **MTG 400s, MTG 500s, MTW 400s, MTW 500s:**

- Screwed sandwich gas nozzle with integrated insulation

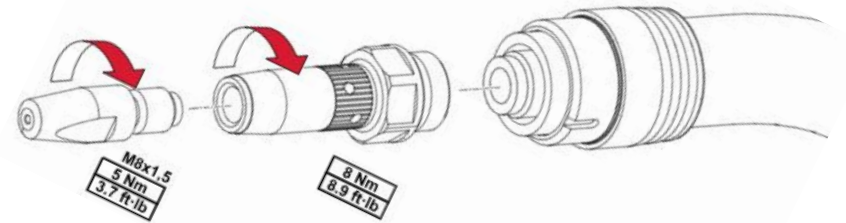
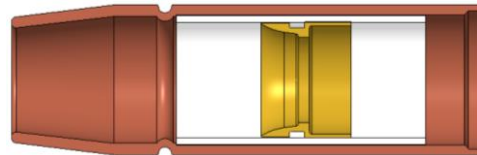

# Basic equipment

- Contact tip SQ, bare steel inner liner and clamping piece are supplied as standard. There is no need to order a basic kit.
  - MTG 270s:  $\varnothing 1.0\text{mm}$
  - MTG 320s - 500s:  $\varnothing 1.2\text{mm}$
  - MTW 320s - 500s:  $\varnothing 1.2\text{mm}$
- 
- If a different wire diameter or a different base material is processed, a basic kit of the TPS/i generation can be ordered in addition. For welding torch length 6m, please order the individual components separately



**Contents:** inner liner L=5m, 2 pcs. contact tips, clamping piece

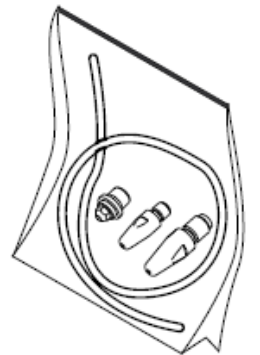

# Packages & scaled prices wear parts

## Contact tips

- Package unit: 10 pc. (xx,xxxx,xxxx,**10**)
- Packages with price advantage:
  - From 10 packages á 10 pc. (= 100 pc.)
  - From 100 packages á 10 pc. (= 1.000 pc.)



## Gas nozzles, Nozzle stocks, Clamping pieces

- Package unit: 5 pc. (xx,xxxx,xxxx,**5**)
- Packages with price advantage:
  - From 10 packages á 5 Stk. (= 50 pc.)
  - From 40 packages á 5 Stk. (= 200 pc.)

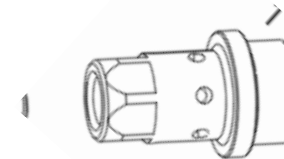
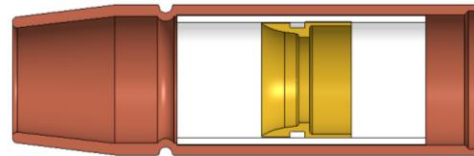

# Gascooled wear parts

## MTG 270s

- 1) 42.0001.1634.5 Nozzle stock M6/SW13x30
- 2) Contact tip M6
- 3) 42,0001,1564,5 Gas nozzle con.  $\varnothing 12/\varnothing 20 \times 66$

## MTG 320s

- 1) 42,0001,1701,5 Nozzle stock M6/SW15x32
- 2) Contact tip M6
- 3) 44.0350.3234.5 Gas nozzle con  $\varnothing 13/\varnothing 22 \times 67$

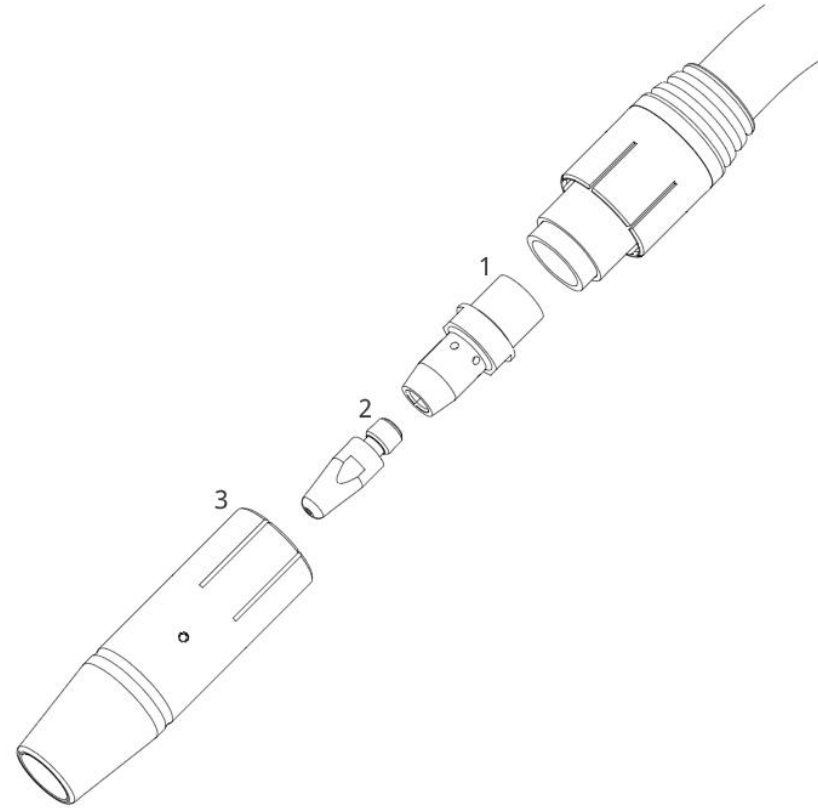

# Gascooled wear parts

## MTG 400s

- 1) 42.0001.6639.5 Nozzle stock M8x1.5/SW15x52.9 MS
- 2) Contact tip M8x1.5
- 3) 44.0350.2028.5 Gas nozzle  $\varnothing 15/\varnothing 25 \times 75$

## MTG 500s

- 1) 42.0001.1145.5 Nozzle stock M8x1.5/SW16x62.9 MS
- 2) Contact tip M8x1.5
- 3) 44.0350.1567.5 Gas nozzle  $\varnothing 17/\varnothing 27 \times 85$  HD

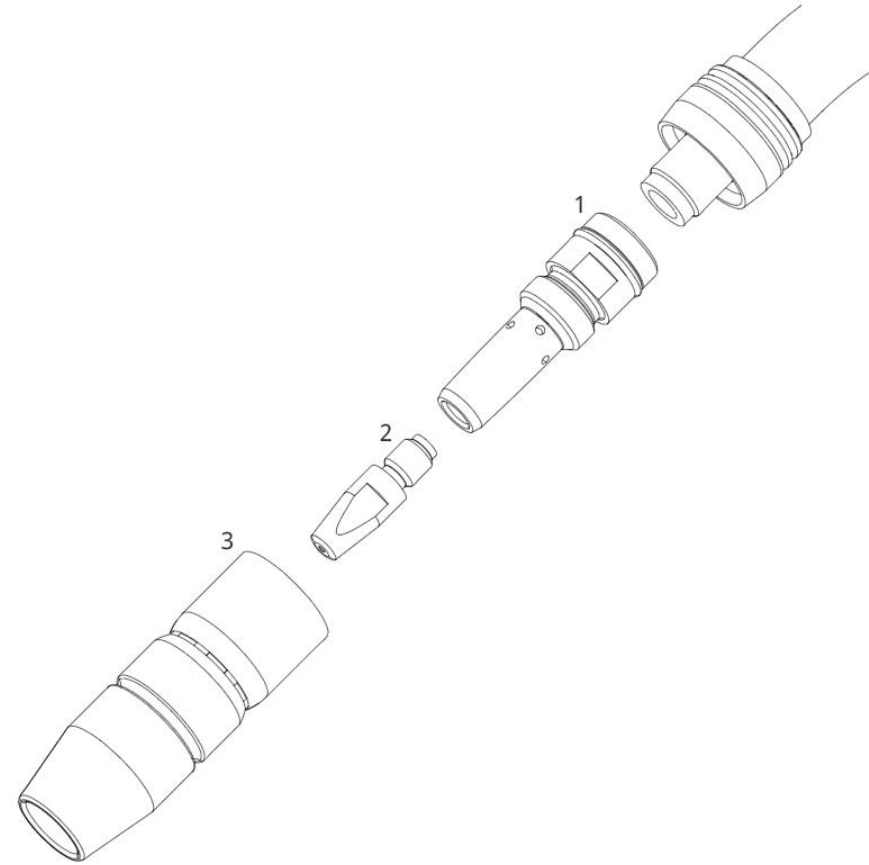

# Watercooled wear parts

## MTW 320s

- 1) 42,0001,1701,5 Nozzle stock M6/SW15x32
- 2) Contact tip M6
- 3) 44.0350.3234.5 Gas nozzle con  $\varnothing 13/\varnothing 22 \times 67$

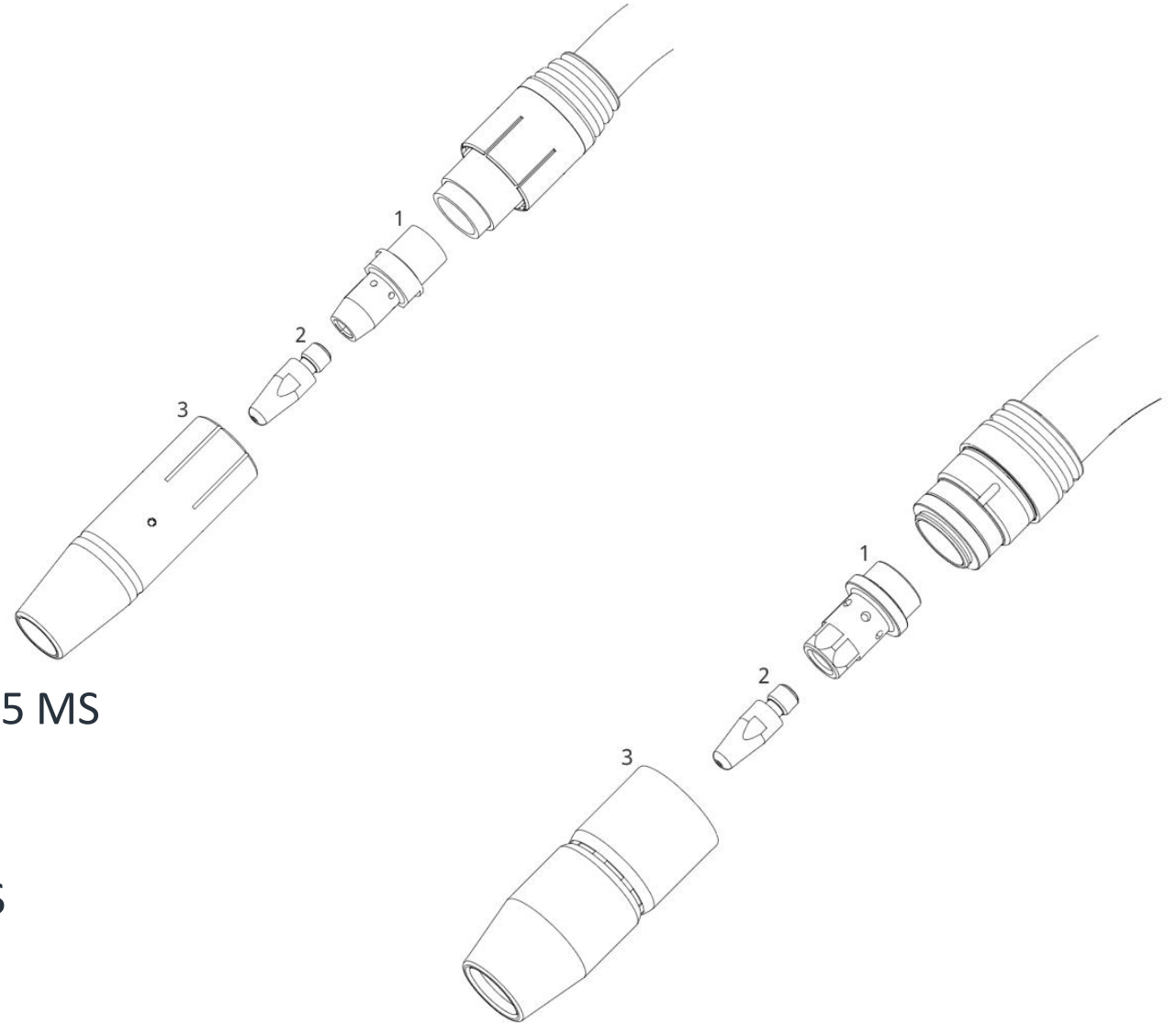

## MTW 400s / MTW 500s

- 1) 42.0001.2641 Nozzle stock M8x1.5/SW16x26.5 MS
- 2) Contact tip M8x1.5
- 3) 44.0350.4767.5 Gas nozzle  $\varnothing 15/\varnothing 25 \times 62.5$  CT S



# Contact tips SQ (Standard Quality) for steel

- **Contact tip SQ M6**

- 42.0001.7025.10 Contact tip 0.9 / M6 /  $\varnothing 8 \times 24$
- 42.0001.7026.10 Contact tip 1.0 / M6 /  $\varnothing 8 \times 24$
- 42.0001.7027.10 Contact tip 1.2 / M6 /  $\varnothing 8 \times 24$

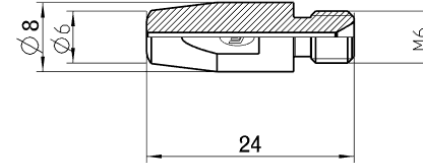

- **Contact tip SQ M8x1.5**

- 42.0001.7028.10 Contact tip 0.9 / M8x1.5 /  $\varnothing 10 \times 32$
- 42.0001.7029.10 Contact tip 1.0 / M8x1.5 /  $\varnothing 10 \times 32$
- 42.0001.7030.10 Contact tip 1.2 / M8x1.5 /  $\varnothing 10 \times 32$

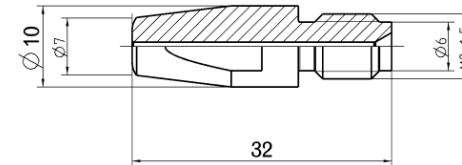

# Contact tips CuCrZr for steel



- **Contact tips CuCrZr M6 for steel**

- 42.0001.4461.10 Contact tip 0.8/M6/ø8x24
- 42.0001.4462.10 Contact tip 0.9/M6/ø8x24
- 42.0001.4463.10 Contact tip 1.0/M6/ø8x24
- 42.0001.6527.10 Contact tip 1.1/M6/ø8x24
- 42.0001.4464.10 Contact tip 1.2/M6/ø8x24
- 42.0001.6529.10 Contact tip 1.3/M6/ø8x24
- 42.0001.4465.10 Contact tip 1.4/M6/ø8x24
- 42.0001.6522.10 Contact tip 1.5/M6/ø8x24
- 42.0001.4466.10 Contact tip 1.6/M6/ø8x24

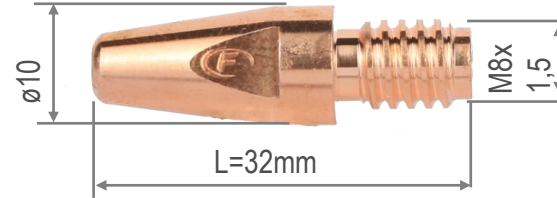

- **Contact tips CuCrZr M8x1.5 for steel**

- 42.0001.6464.10 Contact tip 0.8/M8x1.5/ø8x24
- 42.0001.6465.10 Contact tip 0.9/M8x1.5/ø8x24
- 42.0001.6466.10 Contact tip 1.0/M8x1.5/ø8x24
- 42.0001.6483.10 Contact tip 1.1/M8x1.5/ø8x24
- 42.0001.6467.10 Contact tip 1.2/M8x1.5/ø8x24
- 42.0001.6484.10 Contact tip 1.3/M8x1.5/ø8x24
- 42.0001.6468.10 Contact tip 1.4/M8x1.5/ø8x24
- 42.0001.6485.10 Contact tip 1.5/M8x1.5/ø8x24
- 42.0001.6469.10 Contact tip 1.6/M8x1.5/ø8x24

# Contact tips CuCrZr for aluminum

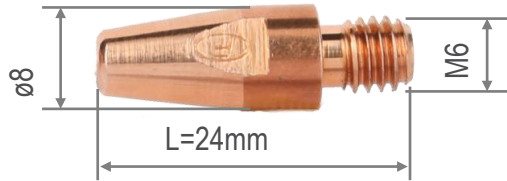

- **Contact tips CuCrZr M6 for aluminum**
- 42.0001.6525.10 Contact tip 0.8/M6/ $\varnothing 8 \times 24$  Al
- 42.0001.6526.10 Contact tip 1.0/M6/ $\varnothing 8 \times 24$  Al
- 42.0001.6528.10 Contact tip 1.2/M6/ $\varnothing 8 \times 24$  Al
- 42.0001.6523.10 Contact tip 1.6/M6/ $\varnothing 8 \times 24$  Al

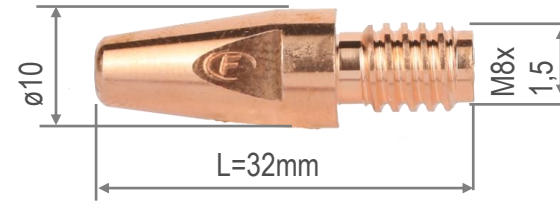

- **Contact tips CuCrZr M8x1.5 for aluminum**
- 42.0001.6537.10 Contact tip 0.8/M8x1.5/ $\varnothing 10 \times 32$  Al
- 42.0001.4750.10 Contact tip 1.0/M8x1.5/ $\varnothing 10 \times 32$  Al
- 42.0001.4751.10 Contact tip 1.2/M8x1.5/ $\varnothing 10 \times 32$  Al
- 42.0001.4752.10 Contact tip 1.6 /M8x1.5/ $\varnothing 10 \times 32$  Al

# Steel inner liner without insulation for gas and watercooled torches

Gas sealing via diameter-specific clamping piece - almost no gas loss



# Steel inner liner for gas- and watercooled | coil length 5m, 15m, 50m

40,0002,0040,005 Bare steel inner liner **0,8 / 5m** Iø1,4x1,5mm

40,0002,0040,015 Bare steel inner liner **0,8 / 15m** Iø1,4x1,5mm

40,0002,0040,050 Bare steel inner liner **0,8 / 50m** Iø1,4x1,5mm

40,0002,0041,005 Bare steel inner liner **1,0 / 5m** Iø1,6x1,6mm

40,0002,0041,006 Bare steel inner liner **1,0 / 6m** Iø1,6x1,6mm

40,0002,0041,015 Bare steel inner liner **1,0 / 15m** Iø1,6x1,6mm

40,0002,0041,050 Bare steel inner liner **1,0 / 50m** Iø1,6x1,6mm



40,0002,0042,005 Bare steel inner liner **1,2 / 5m** Iø1,9x1,5mm

40,0002,0042,006 Bare steel inner liner **1,2 / 6m** Iø1,9x1,5mm

40,0002,0042,015 Bare steel inner liner **1,2 / 15m** Iø1,9x1,5mm

40,0002,0042,050 Bare steel inner liner **1,2 / 50m** Iø1,9x1,5mm

40,0002,0043,005 Bare steel inner liner **1,6 / 5m** Iø2,5x1,2mm

40,0002,0043,015 Bare steel inner liner **1,6 / 15m** Iø2,5x1,2mm

40,0002,0043,050 Bare steel inner liner **1,6 / 50m** Iø2,5x1,2mm

# Steel inner liner coated, universally applicable

- 40,0002,0052,005 Steel inner liner C **0,8 / 5 m** Coated IØ1,4x1,53mm
- 40,0002,0052,015 Steel inner liner C **0,8 / 15 m** Coated IØ1,4x1,53mm
- 40,0002,0052,050 Steel inner liner C **0,8 / 50 m** Coated IØ1,4x1,53mm
- 40,0002,0053,005 Steel inner liner C **1,0 / 5 m** Coated IØ1,6x1,53mm
- 40,0002,0053,015 Steel inner liner C **1,0 / 15 m** Coated IØ1,6x1,53mm
- 40,0002,0053,050 Steel inner liner C **1,0 / 50 m** Coated IØ1,6x1,53mm
- 40,0002,0054,005 Steel inner liner C **1,2 / 5 m** Coated IØ1,9x1,53mm
- 40,0002,0054,015 Steel inner liner C **1,2 / 15 m** Coated IØ1,9x1,53mm
- 40,0002,0054,050 Steel inner liner C **1,2 / 50 m** Coated IØ1,9x1,53mm
- 40,0002,0055,005 Steel inner liner C **1,6 / 5 m** Coated IØ2,5x1,2mm
- 40,0002,0055,015 Steel inner liner C **1,6 / 15 m** Coated IØ2,5x1,2mm
- 40,0002,0055,050 Steel inner liner C **1,6 / 50 m** Coated IØ2,5x1,2mm



# Bare CrNi inner liner for gas- and watercooled/ coil lengths 5m, 15m, 50m

- 40.0002.0044.005 Bare CrNi inner liner **0.8 / 5m** Iø1.4x1.5mm
- 40.0002.0044.015 Bare CrNi inner liner **0.8 / 15m** Iø1.4x1.5mm
- 40.0002.0044.050 Bare CrNi inner liner **0.8 / 50m** Iø1.4x1.5mm
- 40.0002.0045.005 Bare CrNi inner liner **1.0 / 5m** Iø1.6x1.6mm
- 40,0002,0045,015 Bare CrNi inner liner **1.0 / 15m** Iø1.6x1.6mm
- 40,0002,0045,050 Bare CrNi inner liner **1,0 / 50m** Iø1,6x1,6mm
- 40.0002.0046.005 Bare CrNi inner liner **1.2 / 5m** Iø1.9x1.5mm
- 40,0002,0046,015 Bare CrNi inner liner **1,2 / 15m** Iø1,9x1,5mm
- 40,0002,0046,050 Bare CrNi inner liner **1,2 / 50m** Iø1,9x1,5mm
- 40.0002.0047.005 Bare CrNi inner liner **1.6 / 5m** Iø2.5x1.2mm
- 40,0002,0047,015 Bare CrNi inner liner **1.6 / 15m** Iø2.5x1.2mm
- 40,0002,0047,050 Bare CrNi inner liner **1,6 / 50m** Iø2,5x1,2mm



# Combi inner liner for aluminum watercooled

- 44.0350.3392 Combi inner liner W Al / **0.8 / 3.8m** ID1.2 / AD4.7
- 44.0350.3396 Combi inner liner W Al / **0.8 / 4.8m** ID1.2 / AD4.7
- 44.0350.3393 Combi inner liner W Al / **1.0 / 3.8m** ID1.5 / AD4.7
- 44.0350.3397 Combi inner liner W Al / **1.0 / 4.8m** ID1.5 / AD4.7
- 44.0350.3394 Combi inner liner W Al / **1.2 / 3.8m** ID1.8 / AD4.7
- 44.0350.3398 Combi inner liner W Al / **1.2 / 4.8m** ID1.8 / AD4.7
- 44.0350.3395 Combi inner liner W Al / **1.6 / 3.8m** ID2.4 / AD4.7
- 44.0350.3399 Combi inner liner W Al / **1.6 / 4.8m** ID2.4 / AD4.7





# Combi inner liner with bronze piece L=40mm for aluminum gas cooled and CuSi gas- and water cooled

- 44.0350.3404 Combi inner liner G Al / **0.8 / 3.8m** CuSi G / W / ID1.2 / AD4.7
- 44.0350.3408 Combi inner liner G Al / **0.8 / 4.8m** CuSi G / W / ID1.2 / AD4.7
- 44.0350.3405 Combi inner liner G Al / **1.0 / 3.8m** CuSi G / W / ID1.5 / AD4.7
- 44.0350.3409 Combi inner liner G Al / **1.0 / 4.8m** CuSi G / W / ID1.5 / AD4.7
- 44.0350.3406 Combi inner liner G Al / **1.2 / 3.8m** CuSi G / W / ID1.8 / AD4.7
- 44.0350.3410 Combi inner liner G Al / **1.2 / 4.8m** CuSi G / W / ID1.8 / AD4.7
- 44.0350.3407 Combi inner liner G Al / **1.6 / 3.8m** CuSi G / W / ID2.4 / AD4.7
- 44.0350.3411 Combi inner liner G Al / **1.6 / 4.8m** CuSi G / W / ID2.4 / AD4.7



# Combi inner liner with bronze piece L=320mm for aluminum and CuSi gas cooled

- 44.0350.5513 Combi inner liner G /0.8/3.8m
- 44.0350.5518 Combi inner liner G /0.8/4.8m
- 44.0350.5514 Combi inner liner G /1.0/3.8m
- 44.0350.5519 Combi inner liner G /1.0/4.8m
- 44.0350.5515 Combi inner liner G /1.2/3.8m
- 44.0350.5520 Combi inner liner G /1.2/4.8m
- 44.0350.5516 Combi inner liner G /1.6/3.8m
- 44.0350.5521 Combi inner liner G /1.6/4.8m



# Clamping piece – color coded



Gray  
ø0,8mm  
44,0350,3315,5 Fe / CrNi  
44,0350,3314,5 Al / CuSi



Blue  
ø0,9/ø1,0mm  
44,0350,3317,5



Red  
ø1,2mm  
44,0350,3318,5



Black  
Ø1,4/1,6mm  
44,0350,3320,5

# Clamping piece

- **Used for all materials and inner liners**

- **Tool-free assembly of the inner liner**

- 1) Clamping piece is placed on the inner liner

- 2) Screwing by turning to the right

Screw the clamping piece onto the inner liner as far as it will go. The inner liner must be visible through the hole in the cap

- 3) Slide the clamping piece incl. inner liner into the FSC

- 4) Fixation in the FSC with a 90° turn

(marking of the correct fixing position available)

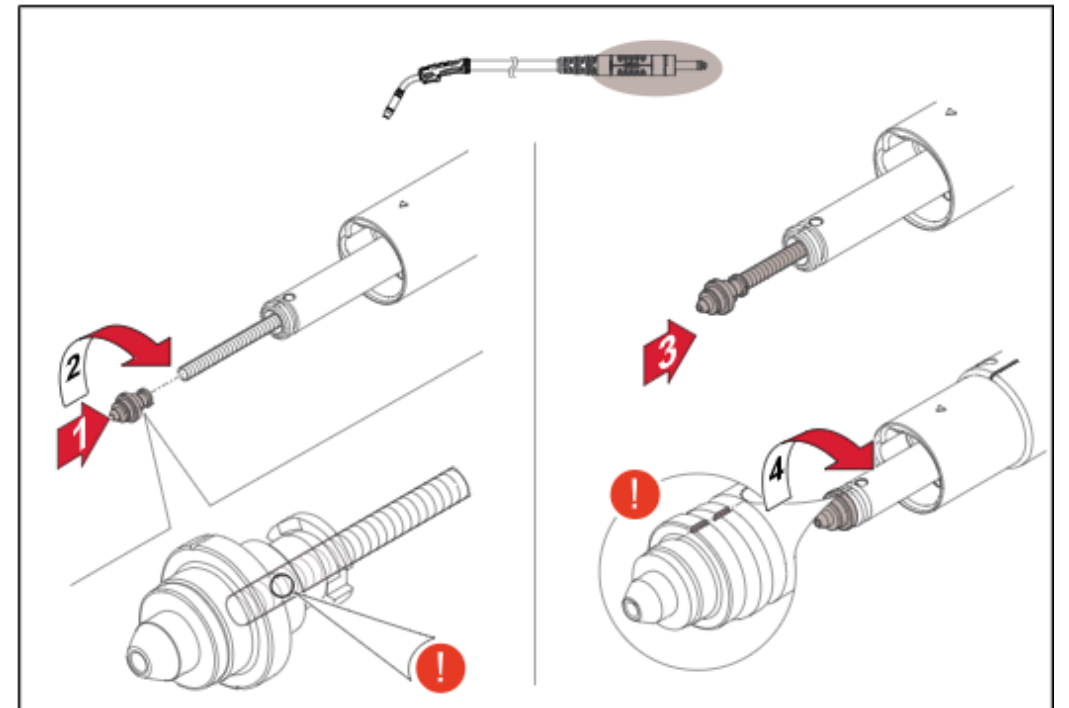

# Basic kits part numbers

## – Basic kits for steel

- 44.0350.5117 BK Fe  $\varnothing$ 0.8 /G/W/5m
- 44.0350.5118 BK Fe  $\varnothing$ 0.9 /G/W/5m
- 44.0350.5119 BK Fe  $\varnothing$ 1.0 /G/W/5m
- 44.0350.5120 BK Fe  $\varnothing$ 1.2 /G/W/5m
- 44.0350.5121 BK Fe  $\varnothing$ 1.4 /G/W/5m
- 44.0350.5122 BK Fe  $\varnothing$ 1.6 /G/W/5m

## – Basic kits Universal for all materials

- 44.0350.1104 BK Universal  $\varnothing$ 0.8/G/W/5m
- 44.0350.1105 BK Universal  $\varnothing$ 0.9/G/W/5m
- 44.0350.1107 BK Universal  $\varnothing$ 1.0/G/W/5m
- 44.0350.1114 BK Universal  $\varnothing$ 1.2/G/W/5m
- 44.0350.1115 BK Universal  $\varnothing$ 1.4/G/W/5m
- 44.0350.1131 BK Universal  $\varnothing$ 1.6/G/W/5m

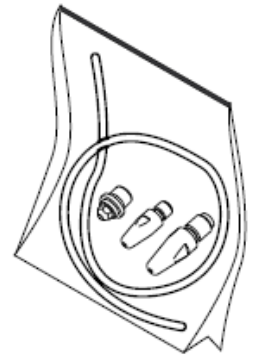

### **Variants:**

**For Euro welding torches, please order the basic kit with .001**

# Basic kits part numbers

## – Basic kits for CrNi

- 44.0350.5158 BK CrNi  $\varnothing$ 0.8 /G/W/5m
- 44.0350.5159 BK CrNi  $\varnothing$ 0.9 /G/W/5m
- 44.0350.5160 BK CrNi  $\varnothing$ 1.0 /G/W/5m
- 44.0350.5161 BK CrNi  $\varnothing$ 1.2 /G/W/5m
- 44.0350.5162 BK CrNi  $\varnothing$ 1.4 /G/W/5m
- 44.0350.5163 BK CrNi  $\varnothing$ 1.6 /G/W/5m

## – Basic kits for aluminum

- 44.0350.5144 BK Al  $\varnothing$ 0.8 /G CuSi  $\varnothing$ 0.8 G/W/5m
- 44.0350.5145 BK Al  $\varnothing$ 0.9 /G CuSi  $\varnothing$ 0.9 G/W/5m
- 44.0350.5146 BK Al  $\varnothing$ 1.0 /G CuSi  $\varnothing$ 1.0 G/W/5m
- 44.0350.5147 BK Al  $\varnothing$ 1.2 /G CuSi  $\varnothing$ 1.2 G/W/5m
- 44.0350.5148 BK Al  $\varnothing$ 1.4 /G CuSi  $\varnothing$ 1.4 G/W/5m
- 44.0350.5149 BK Al  $\varnothing$ 1.6 /G CuSi  $\varnothing$ 1.6 G/W/5m

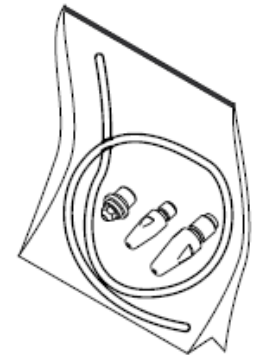

### **Variants:**

**For Euro welding torches, please order the basic kit with .001**

Part numbers

# Part numbers gascooled

Variants	Item number	Article description	UserInterface	Available with Euro connection ending with .001	Original equipment
MTG 270s	4,036,540	MTG 270s /FSC/3.5m	Standard	X	Ø1.0mm
	4,036,541	MTG 270s /FSC/4.5m	Standard	X	
	4,036,542	MTG 270s /FSC/6.0m	Standard	X	
	4,036,543	MTG 270s /FSC/UD/3.5m/Led	Up/down with LED		
	4,036,544	MTG 270s /FSC/UD/4.5m/Led	Up/down with LED		
	4,036,545	MTG 270s /FSC/UD/6.0m/Led	Up/down with LED		
MTG 320s	4,036,546	MTG 320s /FSC/3.5m	Standard	X	Ø1.2mm
	4,036,547	MTG 320s /FSC/4.5m	Standard	X	
	4,036,548	MTG 320s /FSC/6.0m	Standard	X	
	4,036,549	MTG 320s /FSC/UD/3.5m/Led	Up/down with LED		
	4,036,550	MTG 320s /FSC/UD/4.5m/Led	Up/down with LED		
	4,036,551	MTG 320s /FSC/UD/6.0m/Led	Up/down with LED		
MTG 400s	4,036,552	MTG 400s /FSC/3.5m	Standard	X	Ø1.2mm
	4,036,553	MTG 400s /FSC/4.5m	Standard	X	
	4,036,554	MTG 400s /FSC/6.0m	Standard	X	
	4,036,555	MTG 400s /FSC/UD/3.5m/Led	Up/down with LED		
	4,036,556	MTG 400s /FSC/UD/4.5m/Led	Up/down with LED		
	4,036,557	MTG 400s /FSC/UD/6.0m/Led	Up/down with LED		
MTG 500s	4,036,558	MTG 500s /FSC/3.5m	Standard	X	Ø1.2mm
	4,036,559	MTG 500s /FSC/4.5m	Standard	X	
	4,036,560	MTG 500s /FSC/6.0m	Standard	X	
	4,036,561	MTG 500s /FSC/UD/3.5m/Led	Up/down with LED		
	4,036,562	MTG 500s /FSC/UD/4.5m/Led	Up/down with LED		
	4,036,563	MTG 500s /FSC/UD/6m/Led	Up/down with LED		



# Part numbers watercooled

Variants	Item number	Article description	UserInterface	Available with Euro connection ending with .001	Original equipment
MTW 320s	4,036,564	MTW 320s /FSC/3.5m	Standard	X	Ø1.2mm
	4,036,565	MTW 320s /FSC/4.5m	Standard	X	
	4,036,566	MTW 320s /FSC/6.0m	Standard	X	
	4,036,567	MTW 320s /FSC/UD/3.5m/Led	Up/down with LED		
	4,036,568	MTW 320s /FSC/UD/4.5m/Led	Up/down with LED		
	4,036,569	MTW 320s /FSC/UD/6.0m/Led	Up/down with LED		
MTW 400s	4,036,570	MTW 400s /FSC/3.5m	Standard	X	Ø1.2mm
	4,036,571	MTW 400s /FSC/4.5m	Standard	X	
	4,036,572	MTW 400s /FSC/6.0m	Standard	X	
	4,036,573	MTW 400s /FSC/UD/3.5m/Led	Up/down with LED		
	4,036,574	MTW 400s /FSC/UD/4.5m/Led	Up/down with LED		
	4,036,575	MTW 400s /FSC/UD/6.0m/Led	Up/down with LED		
MTW 500s	4,036,576	MTW 500s /FSC/3.5m	Standard	X	Ø1.2mm
	4,036,577	MTW 500s /FSC/4.5m	Standard	X	
	4,036,578	MTW 500s /FSC/6.0m	Standard	X	
	4,036,579	MTW 500s /FSC/UD/3.5m/Led	Up/down with LED		
	4,036,580	MTW 500s /FSC/UD/4.5m/Led	Up/down with LED		
	4,036,581	MTW 500s /FSC/UD/6.0m/Led	Up/down with LED		

# Pricing

# Pricing

- MTGs / MTWs welding torches are on average 23% cheaper than comparable TPS/i welding torches

TPS/i manual welding torches



Ø - 23%

MTGs / MTWs manual welding torches



# Pricing Euro connector

- For the first time, welding torches with Euro connector have the same price as welding torches with an FSC connector

FSC connector



=

Euro connector



# Pricing watercooled

## – Watercooled with FSC connector

TPS/i manual welding torch		MSRP*
4,035,954	MTW 400i /FSC/4,5m/LED	€ 494,00
44,0350,5119	Basic kit Fe 1,2	€ 31,15
<b>Sum</b>		<b>€ 525,15</b>



Standard welding torches watercooled  
average -27%

MTWs manual welding torch		MSRP*
4,036,571	MTW 400s /FSC/4,5m	€ 385,00
Basic kit is included		
<b>Sum</b>		<b>€ 385,00</b>

## – Watercooled with Euro connector

TPS/i manual welding torch		MSRP*
4,035,951,001	MTW 400d /E/3,5m	€ 493,00
44,0350,5119,001	Basic kit Fe 1,2	€ 31,15
<b>Sum</b>		<b>€ 524,15</b>



Euro welding torches watercooled  
average -30%

MTWs manual welding torch		MSRP*
4,036,570,001	MTW 400s /E/3,5m	€ 363,00
Basic kit is included		
<b>Sum</b>		<b>€ 363,00</b>

\* manufacturer's suggested retail price

# Pricing watercooled

## – Watercooled with Up/Down and FSC connector

TPS/i manual welding torch		MSRP*
4,035,958	MTW 500i /FSC/UD/3,5m	€ 581,00
44,0350,5119	Basic kit Fe 1,2	€ 31,15
<b>Sum</b>		<b>€ 612,15</b>



UpDown welding torches watercooled  
average -18%

MTWs manual welding torch		MSRP*
4,036,579	MTW 500s /FSC/UD/3,5m	€ 503,00
Basic kit is included		
<b>Sum</b>		<b>€ 503,00</b>

\* manufacturer's suggested retail price

# Pricing gascooled

## – Gascooled with FSC connector

TPS/i manual welding torch		MSRP*
4,035,936	MTG 400i /FSC/4,5m/LED	€ 434,00
44,0350,5119	Basic kit Fe 1,2	€ 31,15
<b>Sum</b>		<b>€ 465,15</b>



Standard welding torches gascooled  
average -23%

MTGs manual welding torch		MSRP*
4,036,553	MTG 400s /FSC/4,5m	€ 379,00
Basic kit is included		
<b>Sum</b>		<b>€ 379,00</b>

## – Gascooled with Euro connector

TPS/i manual welding torch		MSRP*
4,035,930,001	MTG 320d /E/4,5m	€ 412,00
44,0350,5119,001	Basic kit Fe 1,2	€ 31,15
<b>Sum</b>		<b>€ 443,15</b>



Euro welding torches gascooled  
average -26.5%

MTGs manual welding torch		MSRP*
4,036,547,001	MTG 320s /E/4,5m	€ 323,00
Basic kit is included		
<b>Sum</b>		<b>€ 363,00</b>

\* manufacturer's suggested retail price

# Pricing gascooled

## – Gascooled with Up/Down and FSC connector

TPS/i manual welding torch		MSRP*
4,035,928	MTG 320i /FSC/UD/3,5m	€ 581,00
44,0350,5119	Basic kit Fe 1,2	€ 31,15
<b>Sum</b>		<b>€ 612,15</b>



Up/Down welding torches gascooled  
average -17%

MTGs manual welding torch		MSRP*
4,036,549	MTG 320s /FSC/UD/3,5m/Led	€ 406,00
Basic kit is included		
<b>Sum</b>		<b>€ 406,00</b>

\* manufacturer's suggested retail price



# Options

# Torch trigger extension

– 44,0350,5229 Torch trigger extension kit

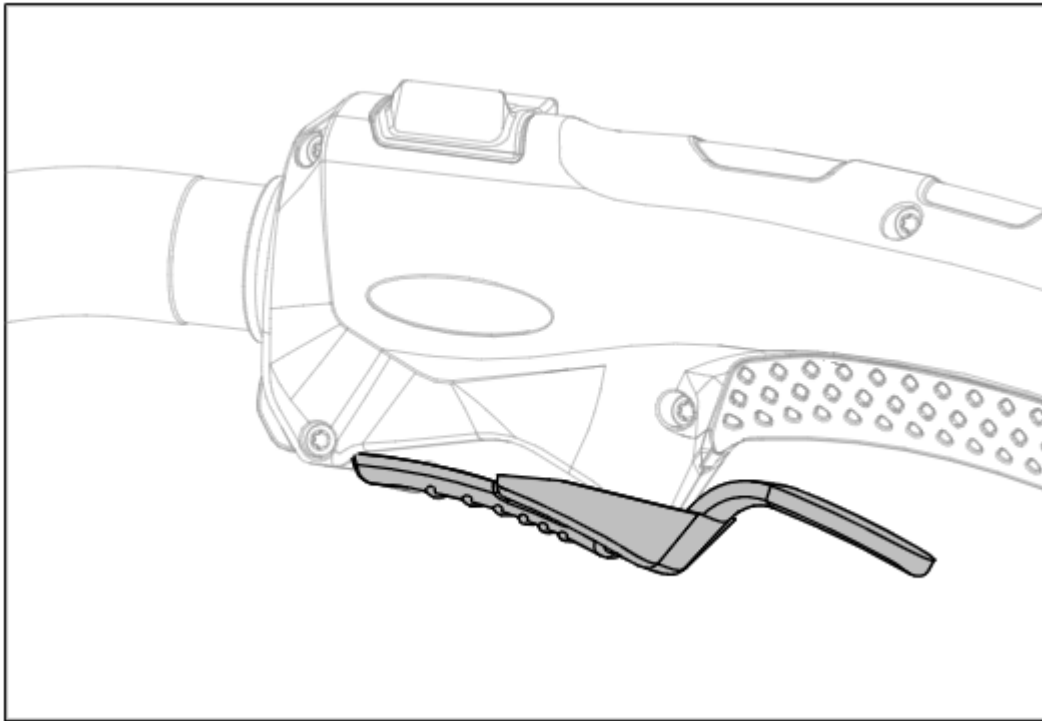

# Heat protection shield

– 42.0405.0753 Heat protection shield (only for power class 400A and 500A)

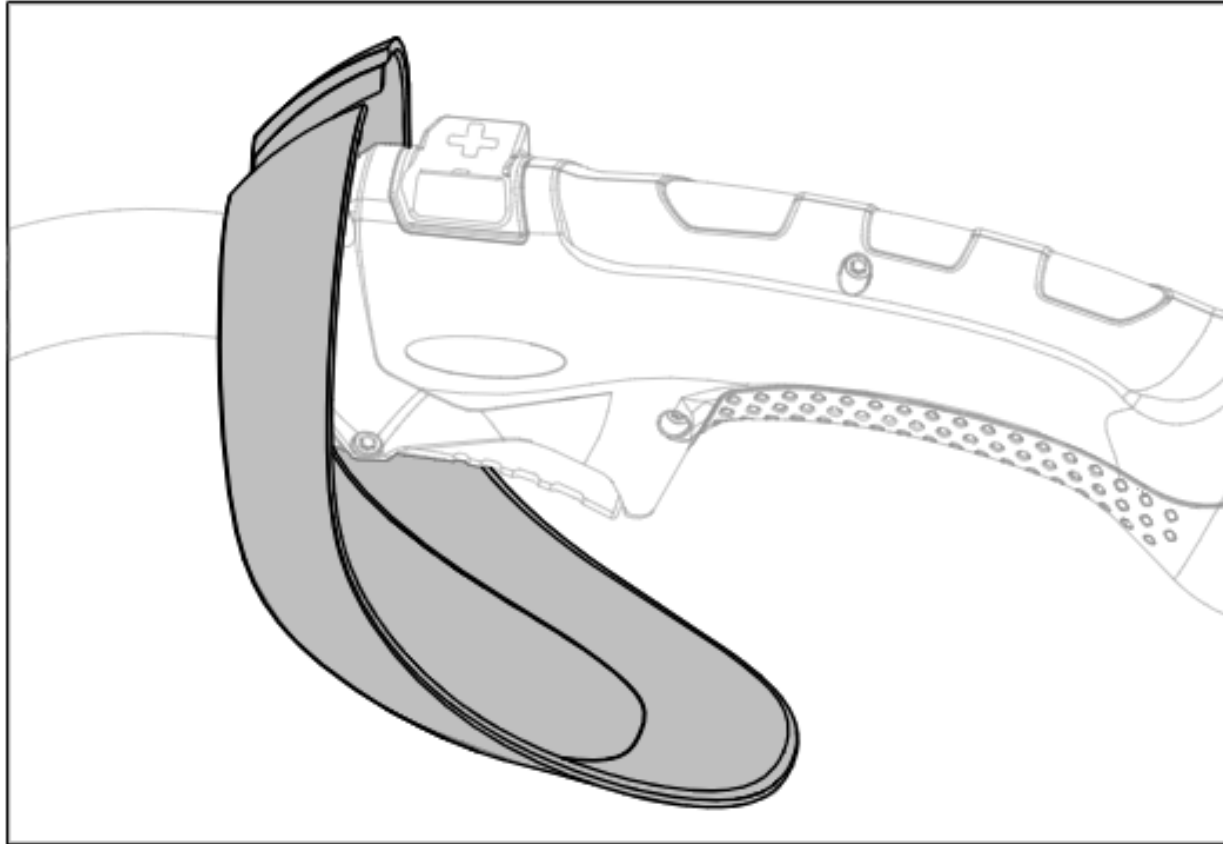

# Gas nozzle milling tool for manual cleaning

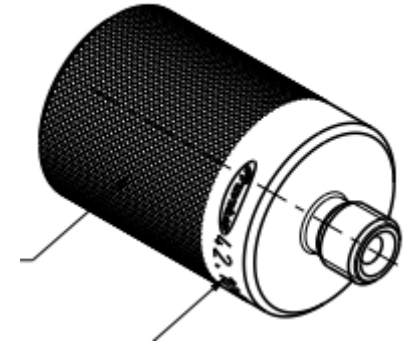

- A standard gas nozzle milling tool can be mounted on the handle.
- This means that they are also suitable for manually cleaning manual welding torches.
- Article number: 42,1000,1242 Handle for Gas nozzle milling tool

Welding torch Type	Article number milling tool
MTG 400s	44,0450,0005 Milling tool Aø14,5/Iø12,8/ø11
MTG 500s	44,0450,0032 Milling tool Aø16,5x50/Iø13/ø11
MTW 400s/500s	44,0450,0116 Milling tool Aø14,5x39/Iø13/ø11

# Adapter welding torches on TPS and VS power sources or competitor power sources

- **FSC welding torches water cooled to F++**

44,0350,3331 Adapter-ZA F++/FSC-S-W

44,0350,3950 Adapter-ZA F++/FSC-S-W UpDown

- **FSC welding torches to Euro-ZA**

44,0350,3329 Adapter-ZA Euro/FSC

44,0350,3948 Adapter-ZA Euro/FSC UpDown

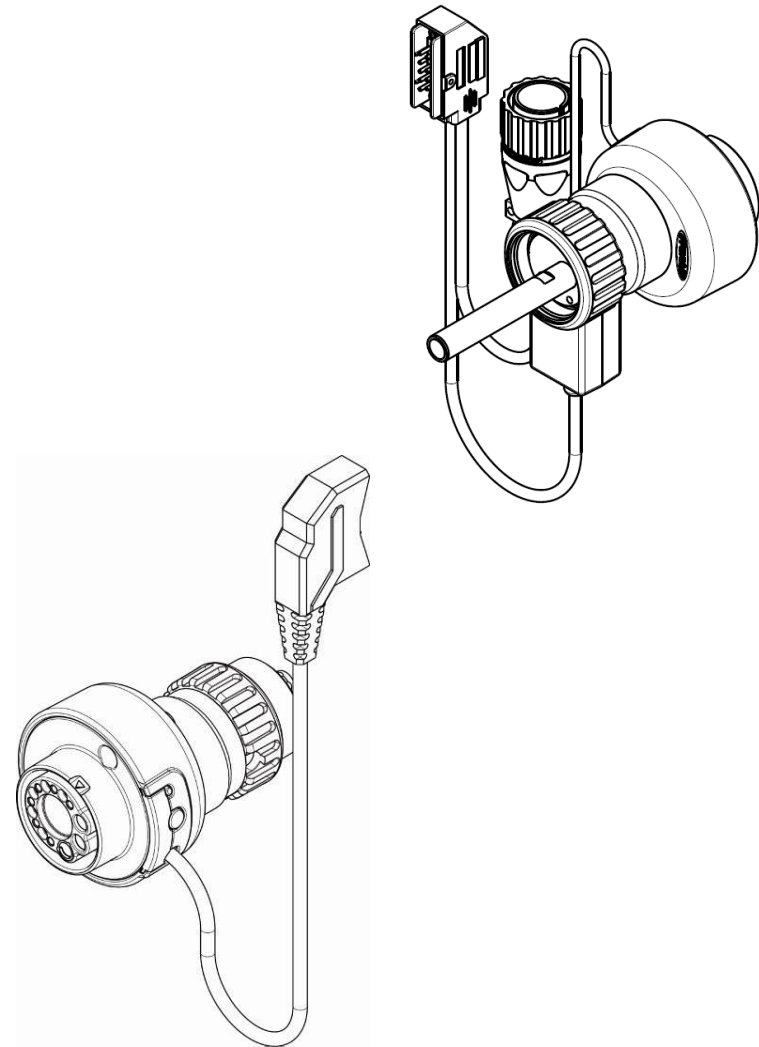

Technical information

# Temperature comparison Gas nozzle

Welding power: **500A / DC 100%**

At 50-55°C the gas nozzle can be touched with bare hands.

- **MTW 500i**

- Gas nozzle temperature after 10 minutes welding: **400 °C**
- 55 °C after approx. 1 min. 30 sec.
- 50 °C after approx. 1 min. 40 sec.

- **MTW 500s**

- Gas nozzle temperature after 10 minutes welding: **480 °C**
- 55 °C after approx. 4 min.
- 50 °C after approx. 4 min. 45 sec.



# Temperature comparison MTW 500i vs MTW 500s

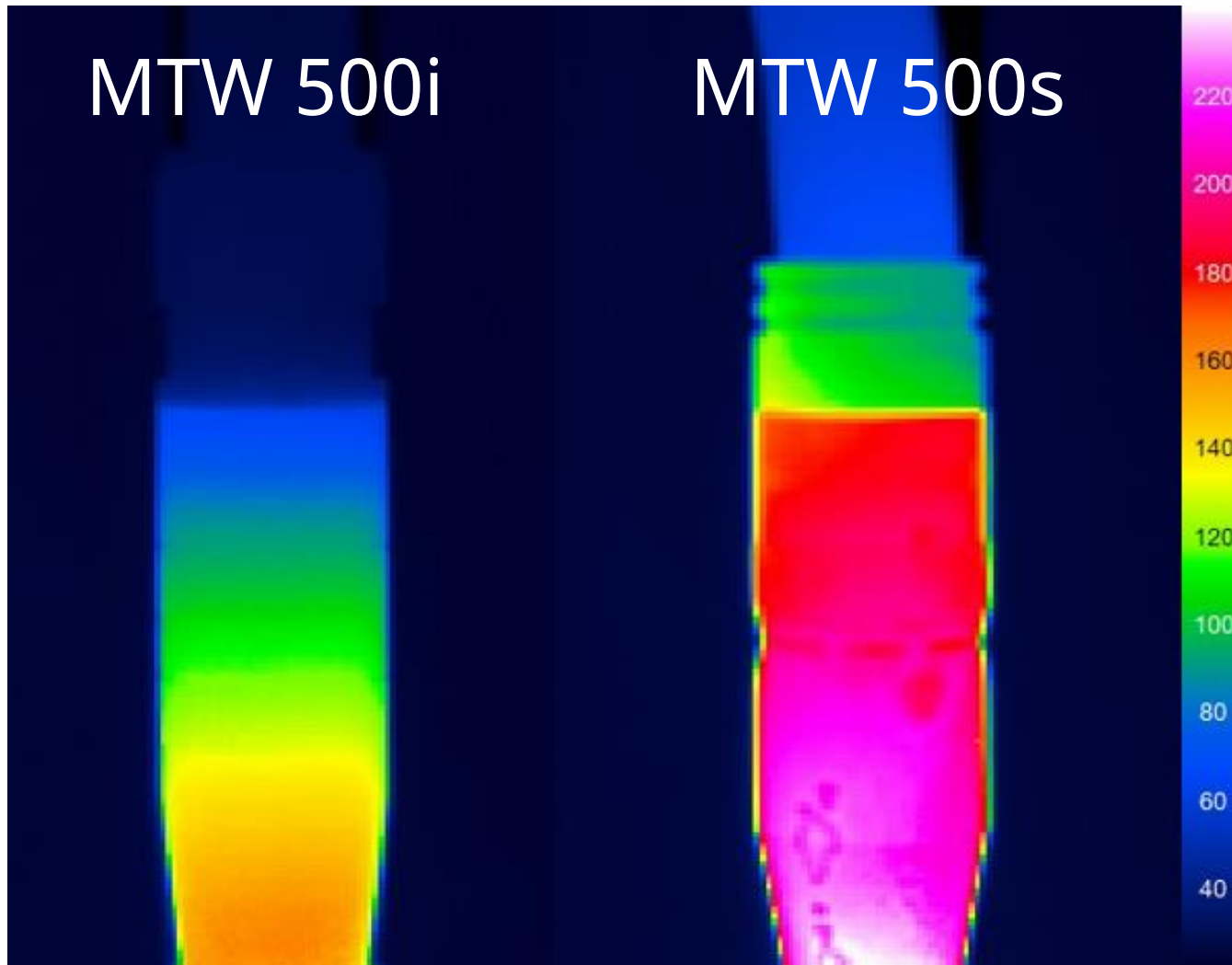

Test setup:

Heating cartridge

$P_{zu} = 125W$

Heat up for 10 minutes

– **MTW 500i is about 30% cooler**

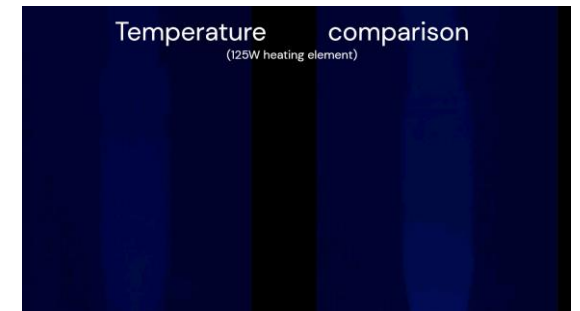



# Compare stability

- i-Series → Stainless steel outer tubes → approx. 10% more stable
- s-Series → Aluminum outer tubes

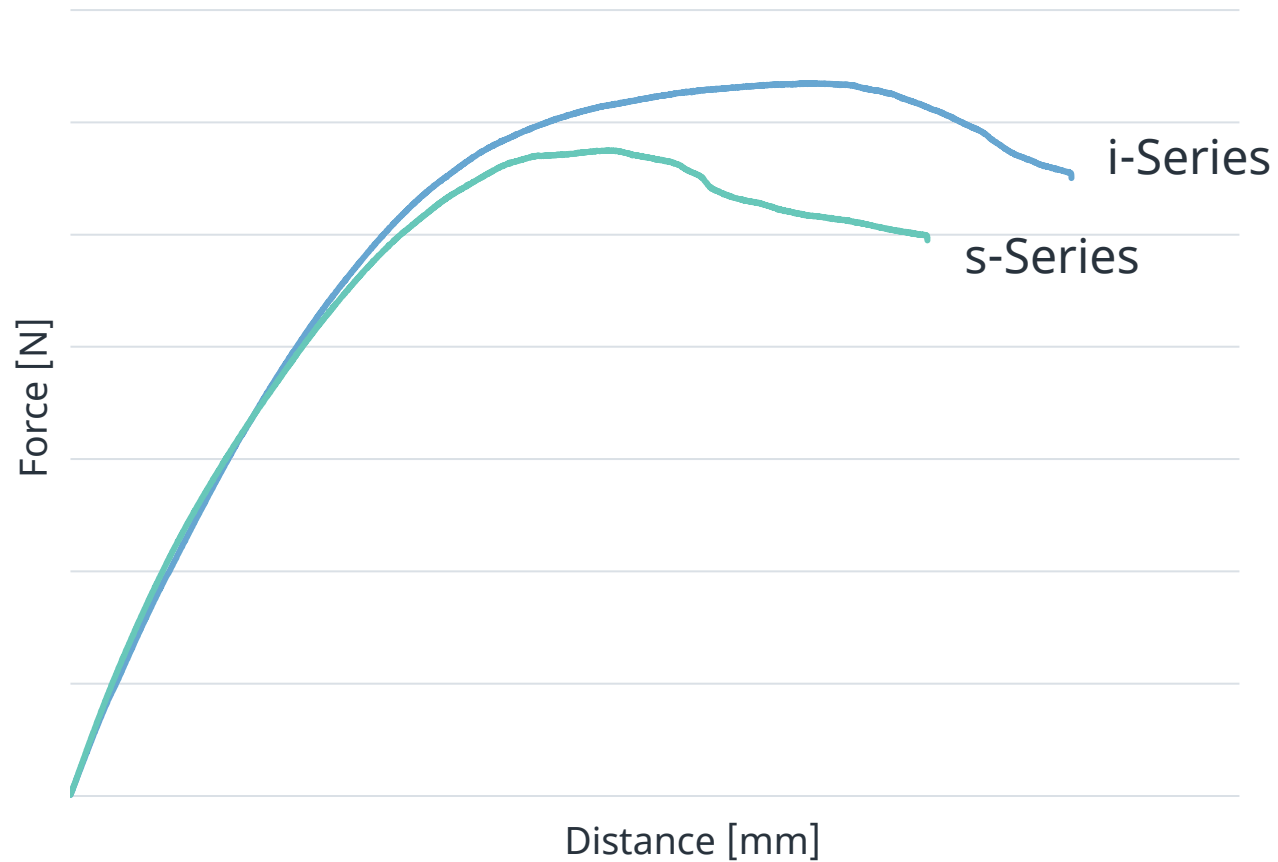

# Power and coax cable size

## – Gascooled

Variants	Coaxial cable
MTG 270s	25mm <sup>2</sup>
MTG 320s	35mm <sup>2</sup>
MTG 400s	50mm <sup>2</sup>
MTG 500s	70mm <sup>2</sup>

## – Watercooled

Variants	Power cable
MTW 320s	10mm <sup>2</sup>
MTW 400s	3.5m, 4.5m: 10mm <sup>2</sup> 6m: 16mm <sup>2</sup>
MTW 500s	16mm <sup>2</sup>

Compatibility of wear  
parts MTW 400/500i and  
MTW 400/500s

# Wear parts MTW 400/500s compatible with MTW 400/500i

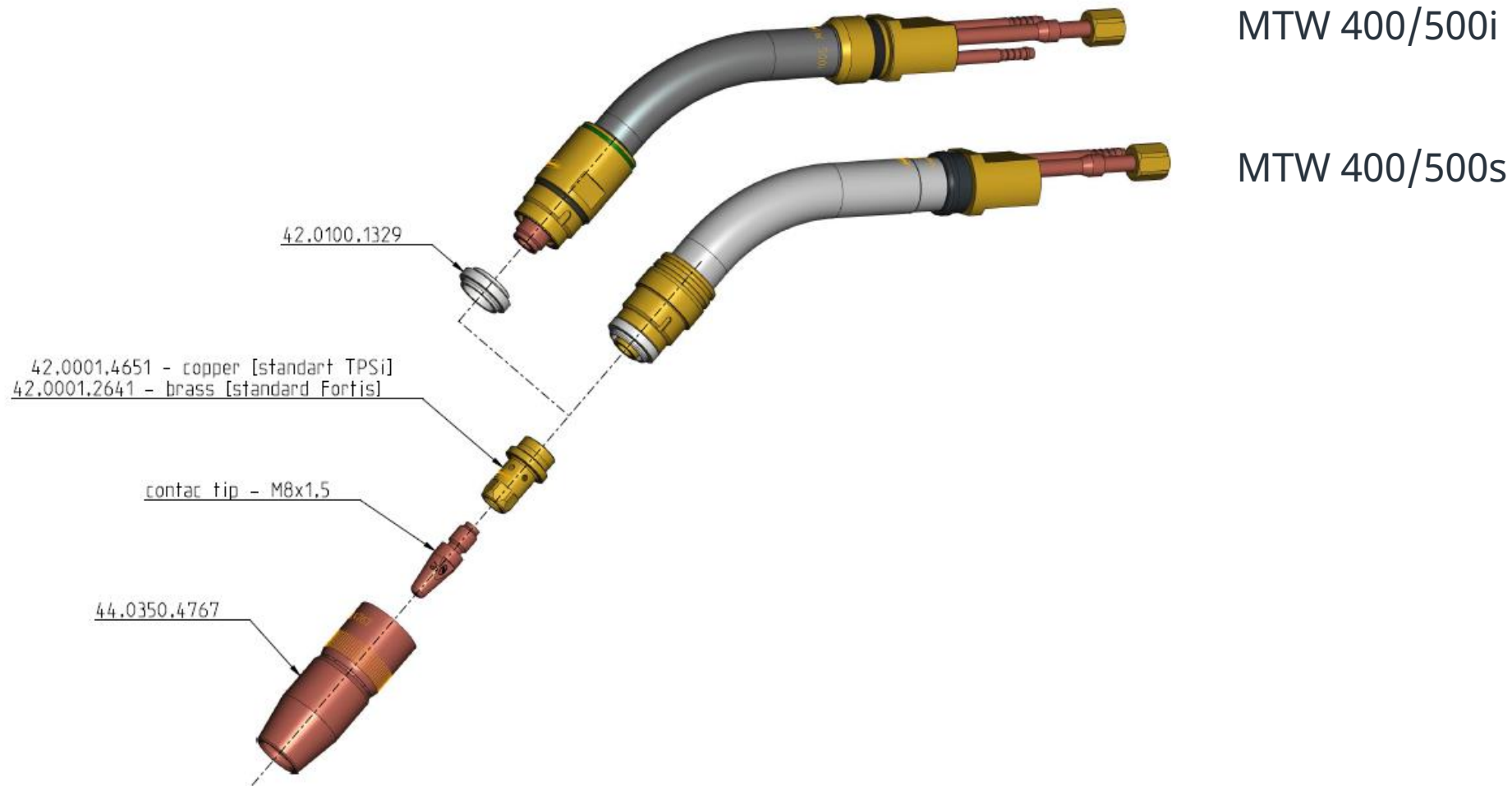

# Spatter guard system MTW 400/500i compatible with MTW 400/500s

42.0100.1329

42.0001.4037 - copper

42.0405.0854  
HD - 42.0100.0591

contac tip - M8x1,5

TAB. 2  
standard - 42.0001.4050

MTW 400/500i

MTW 400/500s

**TAB. 2** gas nozzle

d1		d2		d3		L		Part No.	
mm	inch	mm	inch	mm	inch	mm	inch		
13	0.51	25	0.98	16,4	0.64	59	2.32	42,0001,4085	
15	0.59	25	0.98	18,6	0.73	59	2.32	42,0001,4048	
13	0.51	25	0.98	16,4	0.64	61	2.40	42,0001,4086	
15	0.59	25	0.98	18,1	0.71	61	2.40	42,0001,4474	
15	0.59	27	1.06	20,2	0.80	61	2.40	42,0001,4789	
17	0.71	25	0.98	20,8	0.82	61	2.40	42,0001,4476	
13	0.51	25	0.98	16,4	0.64	61	2.40	42,0001,4497	Al
13	0.51	25	0.98	16,4	0.64	63	2.48	42,0001,4080	
15	0.59	25	0.98	18,6	0.73	61	2.40	42,0001,4496	Al
15	0.59	25	0.98	18,6	0.73	63	2.48	42,0001,4051	
17	0.71	25	0.98	20,8	0.82	61	2.40	42,0001,4494	Al
17	0.71	25	0.98	20,8	0.82	63	2.48	42,0001,4050	
17	0.71	27	1.06	20,8	0.82	63	2.48	42,0001,4216	
21	0.82	25	0.98	25,0	0.98	63	2.48	42,0001,4054	
15	0.59	25	0.98	18,6	0.73	68	2.68	42,0001,4052	
17	0.71	25	0.98	20,8	0.82	68	2.68	42,0001,4049	

M23x2



All information is without guarantee in spite of careful editing – liability excluded.

Intellectual property and copyright: all rights reserved.  
Copyright law and other laws protecting intellectual property apply to the content of this presentation and the documentation enclosed (including texts, pictures, graphics, animations etc.) unless expressly indicated otherwise. It is not permitted to use, copy or alter the content of this presentation for private or commercial purposes without explicit consent of Fronius.