



PullMig CMT TPS/i

Fronius International, Name Surname, xx.xx.20xx Information Class: Confidential



PullMig CMT TPS/i

– Hose packs (MHP = MIG HosePack, PM = PullMig):



	Technical data standard	Technical data CMT
MHP 280i G PM CMT	280A 40% duty cycle	180 A 40% duty cycle
MHP 400i W PM CMT	400A 100% duty cycle	280 A 100% duty cycle

Versions: Standard LED / UpDown / Jobmaster Lengths: 3,85m / 5,85m / 7,85m



SpeedNet

Highlights

Multilock with integrated water stop

360° rotatable, with anti twist guard

Slip-free handle with soft components

Stainless steel outer tube for max. stability

Optimally cooled
Screwed gas nozzle,
Tapered contact tips
for perfect heat transfer

Flexible, rotating rubber anti kink feature for better handling

LED-illumination
For illumination of the welding area
Control via two-stage gun trigger

Slip-free handle with soft components



Multilock torch bodies MTB = **MIG Torch Body**



MTB 250i G



MTB 250i W



MTB 330i W



MTB 320i G



MTB 400i W



MTB 400i G



MTB 500i W



MTB 700i W

Multilock Torch Bodies MTB flex = **MIG Torch Body**



MTB 200i G ML flex



MTB 330i W ML flex



MTB 360i G ML flex



MTB 400i W ML flex

Flex Neck – bending test

- Gascooled torch bodies can be bent 1.000 times
- Watercooled torch bodies can be bent 600 times

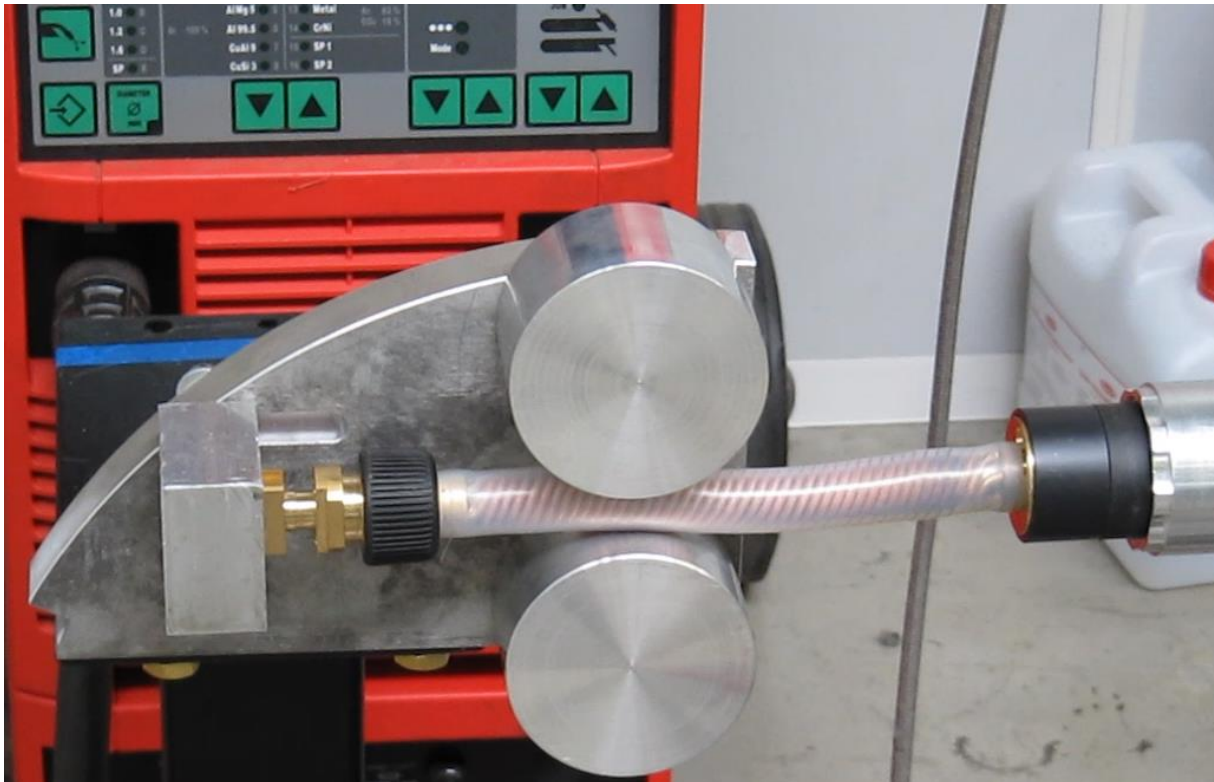

Multilock torch body versions

Union nut is fixed and protects the Multilock connector (important for watercooled torch bodies)



Highlight
Fixed 0° position by an anti twist guard



Wear parts and
Basic kits

Basic kits for PullMig CMT

- Fe $\varnothing 0,8$ / $\varnothing 0,9$ / $\varnothing 1,0$ / $\varnothing 1,2$ / $\varnothing 1,4$ / $\varnothing 1,6$
- CrNi $\varnothing 0,8$ / $\varnothing 0,9$ / $\varnothing 1,0$ / $\varnothing 1,2$ / $\varnothing 1,4$ / $\varnothing 1,6$

Content: Contact tip M6, Contact tip M8x1,5, Wire guide nozzle, Drive and pressure rolls, inner liner and clamping piece, clamping piece, roller tool, wrench, bigger clamping piece for wire buffer for $\varnothing 1,6$

- Aluminum (G) & CuSi $\varnothing 0,8$ / $\varnothing 0,9$ / $\varnothing 1,0$ / $\varnothing 1,2$ / $\varnothing 1,4$ / $\varnothing 1,6$
- Aluminum (W) $\varnothing 0,8$ / $\varnothing 0,9$ / $\varnothing 1,0$ / $\varnothing 1,2$ / $\varnothing 1,4$ / $\varnothing 1,6$

Content: Contact tip M6, Contact tip M8x1,5, Wire guide nozzle, Drive and pressure rolls, torch body liner, Inner liner and clamping piece, clamping piece, roller tool, wrench, bigger clamping piece for wire buffer for $\varnothing 1,6$

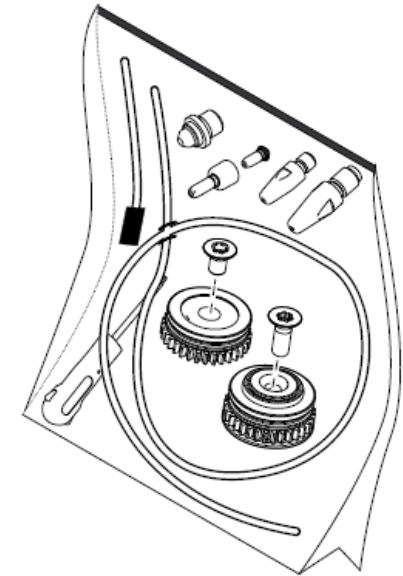

Feed rollers PullMig

- Feed rollers for diameter 0,8K / 0,9K / 1,0K / 1,2K / 1,4K/ 1,6K
- Combination groove with 75°
- Optimized for a perfect wire feeding
- Material: heat treatable steel

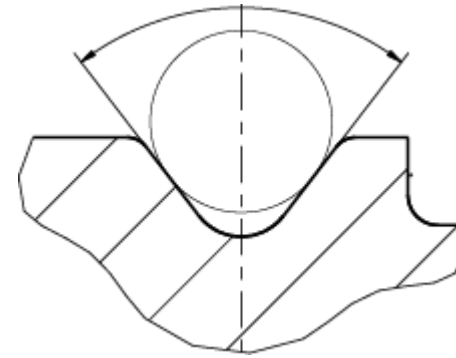

Wear parts

- Screwed gas nozzle
 - Easy operation
 - Optimum heat transfer
 - no loss of gas through the slots
 - Coated gas nozzles available for aluminum welding
- All wearing parts are replaceable
 - also gas nozzle holder can be changed from repair department

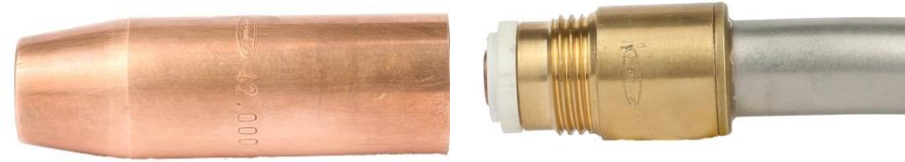

Contact tips

– Types:

- M6 – external diameter 8mm (MTG 250i, MTW 250i)
- M8x1,5 – external diameter 10mm (MTG 320i, MTG 400i, MTW 320i, MTW 500i, MTW 700i)

– Properties:

- Material: CuCrZr
- No central bore in the contact tip
 - Guiding of the innerliner via nozzle stock

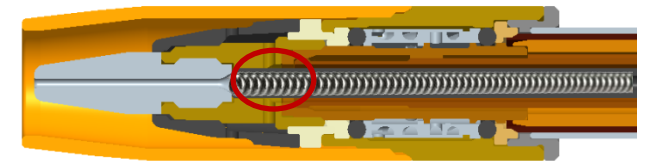
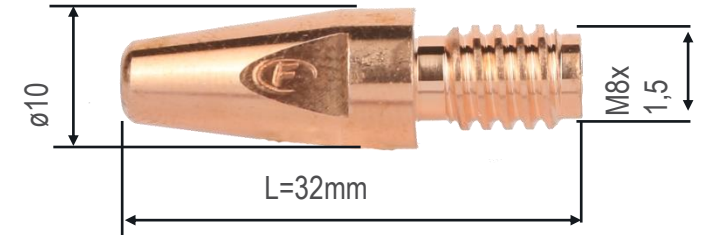
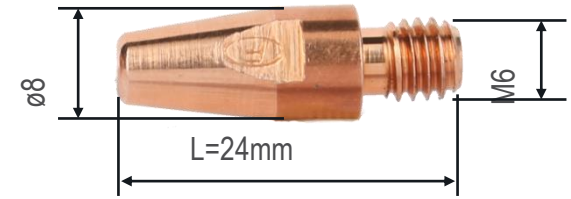

Highlight

Perfectly cooled
welding torches

Cooling of water cooled welding torches

MTW500i

- Cooling was pulled forward as far as possible and also on the outside
- At 500A the gas nozzle can be replaced after about 1 min 30 sec by hand without gloves.

example: **MTW500i**

Highlight

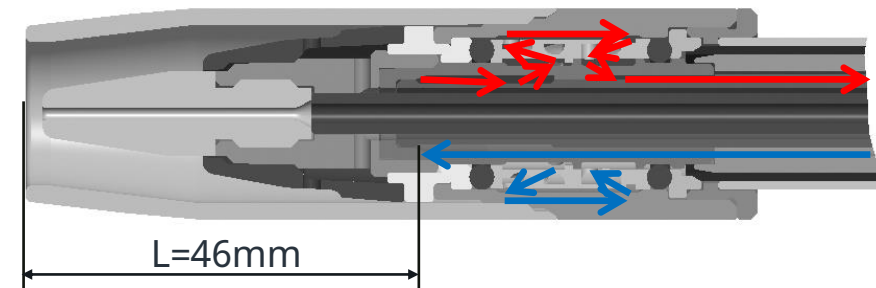

For comparison: cooling of **AW5000**

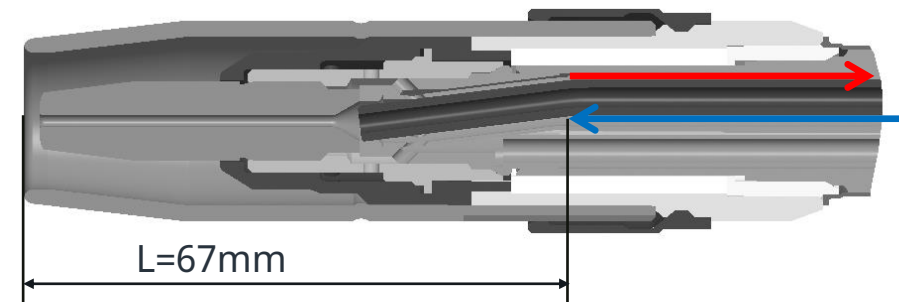

Cooling of Multilock welding torches

Patented

Highlight

- With integrated water stop
- Also without mounted torch body water can circulate
 - Cooler keeps running for 2 minutes after welding
 - Hosepack and coolant liquid are cooled even torch body is removed
- When the torch body is connected, the water circulates to 100% above the torch body and the wearing parts

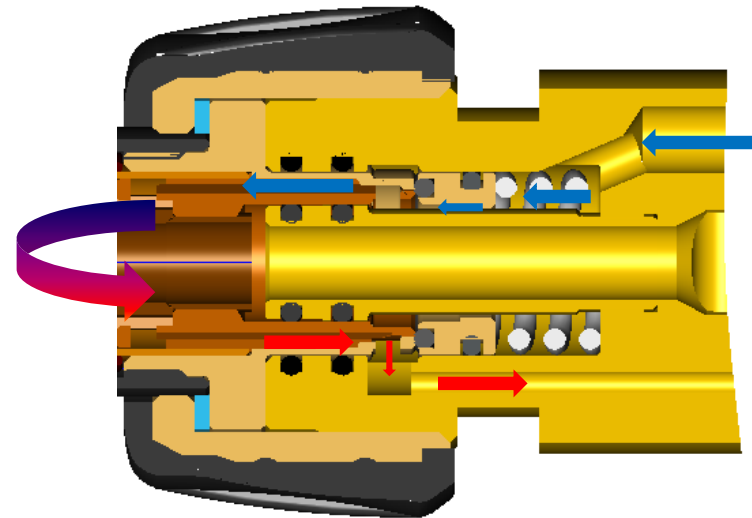
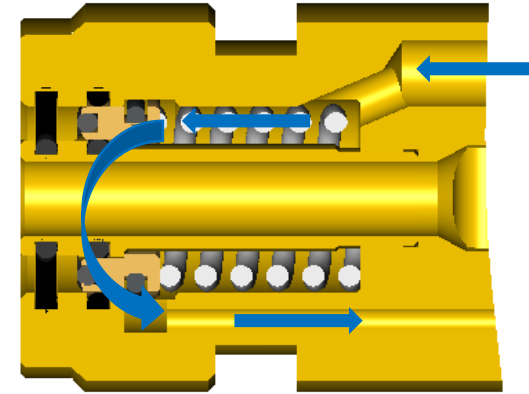

Further
characteristics

Characteristics

- Same handle for Standard, Up/Down and Jobmaster
- Conversion from Standard LED to Up/Down and Jobmaster possible
- Full graphic OLED display (organic LED) on Jobmaster pc board
- Potentiometer available as option or for retrofit



Characteristics

- No PPU-alignment due to torch device ID and real value sensor
- Wire inching without opening the feed rollers possible
- Weight in 1m height: 1,96kg
- Maximum hose pack length: 9,85m
- Viewing window for rollers



Simple manual adjusting of the contact pressure incl. display

- Steplessly adjustable contact pressure

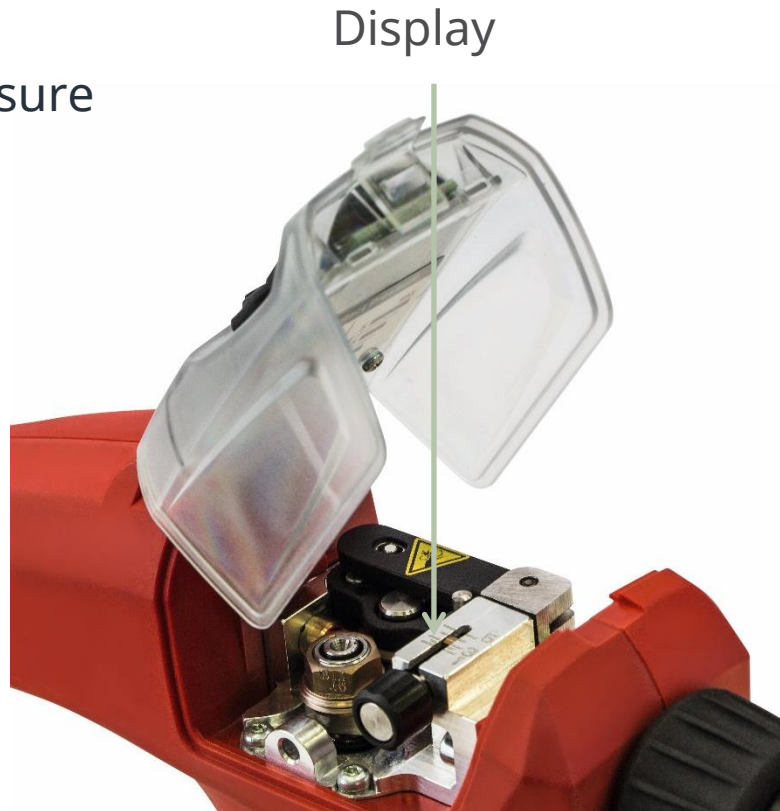

Recommended contact pressure is indicated on cover



Motor

- Weight: 257g (73g lighter than motor of PullMig CMT TPS)
- Max. speed: 60m/min
- Dynamic: 667m/s² (twice as dynamic as PullMig CMT TPS)
- Motor and encoder are protected from water entry
- Encoder: 2500 cpr (twice as accurate as PullMig CMT TPS)
- Same performances as CMT Robotics motor

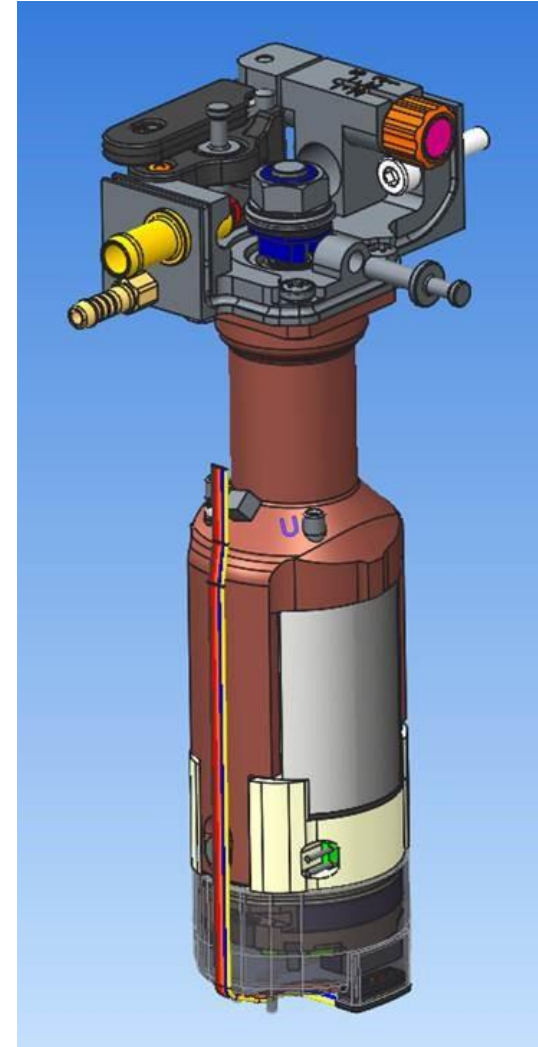

UpDown buttons for left and right hander

- Due to 3 positions of +/- buttons, operation in almost every position is possible
- Buttons can be deactivated directly on the torch (setting is stored at the torch)
- Suitable for left and right handed welders

– Switch panel 1: on the upper side



– Switch panel 2: left side of handle



– Switch panel 3: right side of handle



Current cable sizes

	Current cable
MHP 280i G PM CMT	50mm ²
MHP 400i W PM CMT	25mm ²



All information is without guarantee in spite of careful editing – liability excluded.

Intellectual property and copyright: all rights reserved.
Copyright law and other laws protecting intellectual property apply to the content of this presentation and the documentation enclosed (including texts, pictures, graphics, animations etc.) unless expressly indicated otherwise. It is not permitted to use, copy or alter the content of this presentation for private or commercial purposes without explicit consent of Fronius.