

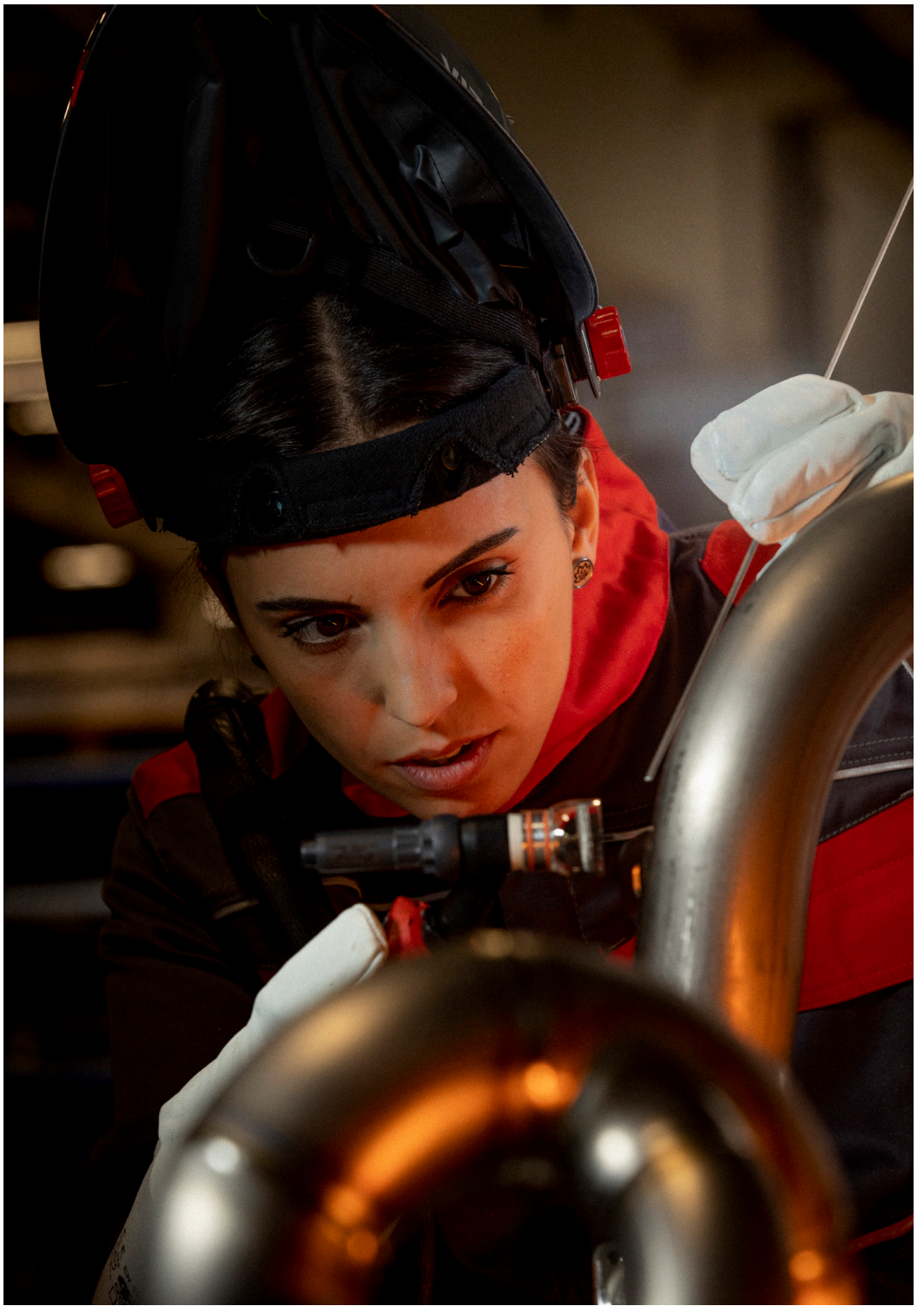

INDUSTRIAL WELDING SYSTEMS 2025



FRONIUS INDUSTRIAL WELDING SYSTEMS

THE PERFECT SOLUTION

WHATEVER YOUR WELDING CHALLENGE

Manual welding demands a lot from both the user and the equipment. Welding equipment needs to be flexible and dependable. It needs to deliver outstanding weld quality, operate efficiently, and last for a long time.

Fronius Industrial Welding Systems are the answer to these challenges. Our welding machines are technology-driven products with the highest levels of quality, cost effectiveness, energy efficiency, and robust design for any working environment. The precise digital control ensures an exceptionally stable arc and 100% reproducible welding results. Intuitive and smart operating concepts make your life easier.

Every Fronius welding machine is an innovative and powerful solution. We offer technology forward products for every welding process. Whether you're using Stick, MIG, or TIG, we have options that make every application better.

Our welding machines are used in metalworking, light and heavy fabrication, service, repair, vehicle maintenance, mechanical and industrial plant construction, and educational institutions. Millions of users around the world put their trust in the quality and performance of Fronius welding equipment. We invite you to learn why.

In this catalog you will find Fronius' innovative welding equipment for manual applications in ready-to-weld packages, and their respective order numbers.

For more information on our industrial welding systems please visit www.fronius.us



www.fronius.us



[/froniuswelding](https://www.youtube.com/channel/UCfroniuswelding)



[/froniususa](https://www.instagram.com/froniususa)



[/fronius-usa](https://www.linkedin.com/company/fronius-usa)



[/fronius.usa](https://www.facebook.com/fronius.usa)

CONTENTS

Contact us at
sales.usa@fronius.com

GMAW	TPS/i	/ 5
	Dual feeder	/ 15
GMAW/GTAW	Boom packages	/ 19
GTAW	iWave	/ 41
	DynamicWire	/ 56
	Exento	/ 59
PPE	Protective Equipment	/ 67
TORCHES	GMAW, GTAW, Exento	/ 71
OPTIONS	Hardware, Software, Carts	/ 83

CATALOG & PRICING VALIDITY:

Prices are effective January 1, 2025 through December 31, 2025 and do not include sales tax or delivery. Fronius USA reserves the right to change prices or equipment configuration at any time without notice. Specifications will be those in effect at the time the order is entered at Fronius USA. All prices are FOB Fronius USA, LLC in Portage, IN. For any orders under \$250 a \$100 processing charge will be added.

CANCELLATION AND RETURN GOODS POLICY.

All returned goods require the written authorization of Fronius USA prior to return and are subject to a 15% restocking charge, must be returned unused and in original unopened container. Orders canceled prior to shipment are not charged to purchaser. Orders canceled after shipment are subject to our returned goods policy.



TPS/i

THE INTELLIGENT ARC REVOLUTION



- / COMPACT DESIGN
- / FOR UNIVERSAL USE
- / SUPERIOR WELD PROPERTIES
- / DESIGNED FOR CV/CC WELDING
- / PUSH PULL & PULSE CAPABLE



TPS/i

APPLICATION INDUSTRIES

LIGHT AND HEAVY FABRICATION

The TPS/i series started the Fronius Intelligent revolution. Every welding process - MIG, TIG DC and Stick - can be carried out using this multiprocess welder. Additional options include a reversed polarity kit and push pull features.

**AVAILABLE TPS/I PROCESSES**

/ The TPS/i range comes equipped with Standard and Pulse processes along with trial licenses of all other TPS/i processes, such as LSC, PMC, and CMT **that can be enabled by the user**. For assistance, contact our TechSupport at (877) 376-6487 or pw-techsupport-us@fronius.com



/ Touch screen controls make many aspects of welding easier. From learning to use the system to making parameter changes on the fly, everything can be accomplished without removing your gloves.



"I couldn't believe how many quality welds we could make at a time, and without going through as many consumables"
- Troy Stokes, Welding Supervisor, Anderson Dahlen

FEATURES

- / Fully digital synergic inverter
- / 1000 Jobs / programs included
- / Spatter Free Ignition (SFI)
- / Synchronpulse
- / RFD Lock out included (1 card / 1 key fob)
- / Ethernet ready for upgrades /Updates
- / Touch screen
- / Improved arc characteristics
- / Color-coded consumables
- / All-in-one welding torch connection (FSC)
- / Rugged design
- / Highly adaptive arc
- / 3 years parts and labor warranty

OPTIONS & ACCESORIES

- / Polarity reversal
- / Advanced processes, LSC, PMC, CMT
- / Wheeled cart
- / Push-pull torch
- / Welding helmet
- / Welding jacket

TPS 320i Key Specifications

Processes	GMAW, GMAW-P, SMAW, DC GTAW
Open circuit voltage	68V
Dimensions (L-W-H)	27.8" x 11.8" x 20.1"
Weight	94.4 lbs
Safety Seals	CSA

Mains Voltage	3x200 Vac (-10% / 15%)			3x230 Vac (-10% / 15%)			3x460 Vac (-10% / 15%)		
Max Fuse protection	35A slow-blow								
Min generator requirement	16.2 kW						18.1 kW		
Mains cable	AWG 10						AWG 14		
Voltage range MIG	14.2 - 30.0 Vdc								
Voltage range TIG	10.1 - 22.8 Vdc								
Voltage range STICK	20.4 - 32.8 Vdc								
Current range MIG	3 - 320 A								
Current range TIG	3 - 320 A								
Current range STICK	10 - 320 A								
DUTY CYCLE	40%	60%	100%	40%	60%	100%	40%	60%	100%
104° F	320	260	240	320	260	240	320	260	240
77° F		320	300		320	300		320	300

TPS 320i



AIR COOLED



Included:
320i MIG Torch US STYLE
Part number 4,036,407
Parts breakdown on page 74.

TPS 320i C MV

MIG / TIG / STICK

Standard Package:

/ 320A MV compact power source
/ Integrated wire feeder
/ MIG Torch, aircooled, 15'
/ TU Cart4 Pro (carriage/mount)
/ Ground Cable, 16', earth clamp
/ Consumables, .035 & .045 steel
/ Flow meter with gas adapter
/ Pre-Assembled & tested

/ Package # 49,0400,0057

/ MSRP: \$10,944

Package price is calculated as configured. Any changes, substitutions, or deletions may increase the package price.
Carts not included, unless listed (ex. TU Cart4 Pro). Gas bottles are never included in packages.



WATER COOLED



TPS 320i C MV

MIG / TIG / STICK

Standard Package:

/ 320A compact power source
/ Integrated wire feeder
/ MIG Torch, water cooled, 14'
/ MV Cooling Unit
/ TU Cart4 Pro (carriage/mount)
/ Ground Cable, 16', earth clamp
/ Consumables, .035 & .045 steel
/ Flow meter with gas adapter
/ Pre-Assembled & tested

/ Package # 49,0400,0058

/ MSRP: \$13,401



Included:
500i MIG Torch
Part number: 4,035,960
Parts breakdown on page 75.



WATER COOLED



TPS 320i C MV

Aluminum - MIG / TIG / STICK

Standard Package:

- / 320A compact power source
- / Integrated wire feeder
- / Push Pull MIG Torch, water cooled
- / MV Cooling Unit
- / TU Cart4 Pro (carriage/mount)
- / Ground Cable, 16', earth clamp
- / Consumable setup, .045 aluminum
- / Flow meter with gas adapter
- / Pre-Assembled & tested

/ MSRP: \$17,365

19' torch length:

/ Package # 49,0400,0060

25' torch length:

/ Package # 49,0400,0080

33' torch length:

/ Package # 49,0400,0081



Included:
320i Push Pull MIG Torch

Part numbers: 4,047,807 and
44,0350,3173
Parts breakdown on page 78.

TPS 320i



WATER COOLED



TPS 320i C MV CMT

MIG / TIG / STICK

Standard Package:

- / 320A compact power source
- / CMT software
- / Internal wire feeder
- / Push/Pull WC CMT MIG Torch
- / MV Cooling Unit
- / TU Cart4 Pro (carriage/mount)
- / Ground Cable, 16', earth clamp
- / Consumables, .035 & .045 steel
- / Flow meter with gas adapter
- / Pre-Assembled & tested

/ Package # 49,0400,0059

/ MSRP: \$23,768



Included:

400i CMT Torch

Part number: 4,047,813 and
44,0350,3168

Parts breakdown on page 79.

Package price is calculated as configured. Any changes, substitutions, or deletions may increase the package price. Carts not included, unless listed (ex. TU Cart4 Pro). Gas bottles are never included in packages.



WATER COOLED



TPS 320i MV CMT

MIG / TIG / STICK

Standard Package:

- / 320A multivoltage power source
- / CMT software
- / WF 25i wire feeder
- / Push/Pull WC CMT MIG Torch
- / MV Cooling Unit
- / TU Cart4 Pro (carriage/mount)
- / Ground Cable, 16', earth clamp
- / Consumable setup, .035 / .045
- / Consumable package
- / Flow meter with gas adapter
- / Pre-Assembled & tested

/ Package # 49,0400,0103

/ MSRP: \$24,942



Included:

400i CMT Torch

Part number: 4,047,813 and
44,0350,3168

Parts breakdown on page 79.



WATER COOLED



Included:
320i Push/Pull MIG Torch
Part number: 4,047,807 and
44,0350,3173
Parts breakdown on page 78.

TPS 320i MV

Aluminum - MIG / TIG / STICK

Standard Package:

- / 320A power source
- / WF 25i wire feeder
- / Push/Pull MIG Torch
- / MV Cooling Unit
- / TU Cart4 Pro (carriage/mount)
- / Ground Cable, 16', earth clamp
- / Consumables, .035 & .045 steel
- / Flow meter with gas adapter
- / Pre-Assembled & tested

/ MSRP: \$18,420

19' torch length:

/ Package # 49,0400,0066

25' torch length:

/ Package # 49,0400,0082

33' torch length:

/ Package # 49,0400,0083

TPS 320i



AIR COOLED



TPS 320i MV for Boom*

MIG / TIG / STICK

Standard Package:

- / 320A MV power source
- / WF 25i wire feeder
- / MIG Torch, aircooled, 15'
- / Ground Cable, 16', earth clamp
- / Hosepack
- / Consumables, .035 & .045 steel
- / Flow meter with gas adapter
- / Pre-Assembled & tested
- / *Boom not included, see page 19 for boom options

/ MSRP: \$12,914

16.4' length hosepack:

/ Package # 49,0400,0106

32.8' length hosepack:

/ Package # 49,0400,0063



Included:
320i US Style MIG Torch

Part number: 4,036,407
Parts breakdown on page 70.





WATER COOLED



TPS 320i MV for Boom*

MIG / TIG / STICK

Standard Package:

- / 320A power source
- / MV Cooling Unit
- / WF 25i wire feeder
- / MIG Torch, water cooled, 14'
- / Ground Cable, 16', earth clamp
- / Hosepack
- / Consumables, .035 & .045 steel
- / Flow meter with gas adapter
- / Pre-Assembled & tested
- / *Boom not included, see page 19 for boom options

/ MSRP: \$15,488



Included:

500i MIG Torch

Part number: 4,035,960

Parts breakdown on page 71.

16.4' length hosepack:

/ Package # 49,0400,0107

32.8' length hosepack:

/ Package # 49,0400,0064

TPS 320i



AIR COOLED



Included:
320i US Style MIG Torch
Part number: 4,036,407
Parts breakdown on page 74.

TPS 320i MV

MIG / TIG / STICK

Standard Package:

/ 320A power source
/ WF 25i wire feeder
/ MIG Torch, aircooled, 15'
/ TU Cart4 Pro (carriage/mount)
/ Ground Cable, 16', earth clamp
/ Consumables, .035 & .045 steel
/ Flow meter with gas adapter
/ Pre-Assembled & tested

/ Package # 49,0400,0061

/ MSRP: \$11,934

Package price is calculated as configured. Any changes, substitutions, or deletions may increase the package price. Carts not included, unless listed (ex. TU Cart4 Pro). Gas bottles are never included in packages.



WATER COOLED



Included:
500i MIG Torch
Part number: 4,035,960
Parts breakdown on page 75.

TPS 320i MV

MIG / TIG / STICK

Standard Package:

/ 320A power source
/ WF 25i wire feeder
/ MIG Torch, water cooled, 14'
/ MV Cooling Unit
/ TU Cart4 Pro (carriage/mount)
/ Ground Cable, 16', earth clamp
/ Consumables, .035 & .045 steel
/ Flow meter with gas adapter
/ Pre-Assembled & tested

/ Package # 49,0400,0062

/ MSRP: \$14,452

New WF25i Dual

Two torches,
two wire spools,
one welding system.

The WF25i Dual ensures stable wire feeding and is compatible with the TPS/i and iWave. A range of mounting options offers maximum flexibility. Changing the active process line is as simple as touching a button on the welding torch.

For further information visit:
www.fronius.com/dual-wire-feeder



	WF 25i Dual incl. D450 spool holder
Wire drive	2 x 4-roller drive
Wire diameter	0.8–1.6 mm (0.03–0.06 in.)
Wirefeed speed	1–25 m/min (39.37–984.25 ipm)
Wire spool diameter	max. 2 x 17.71 in (450mm)
Wire spool weight	max. 2 x 60 lbs
Protection class	IP20
Length	24.3 in. (61.6 cm)
Width	19.9 in. (50.6 cm)
Height	16.7 in. (42.4 cm)
Weight	85 lbs (38.5kg)

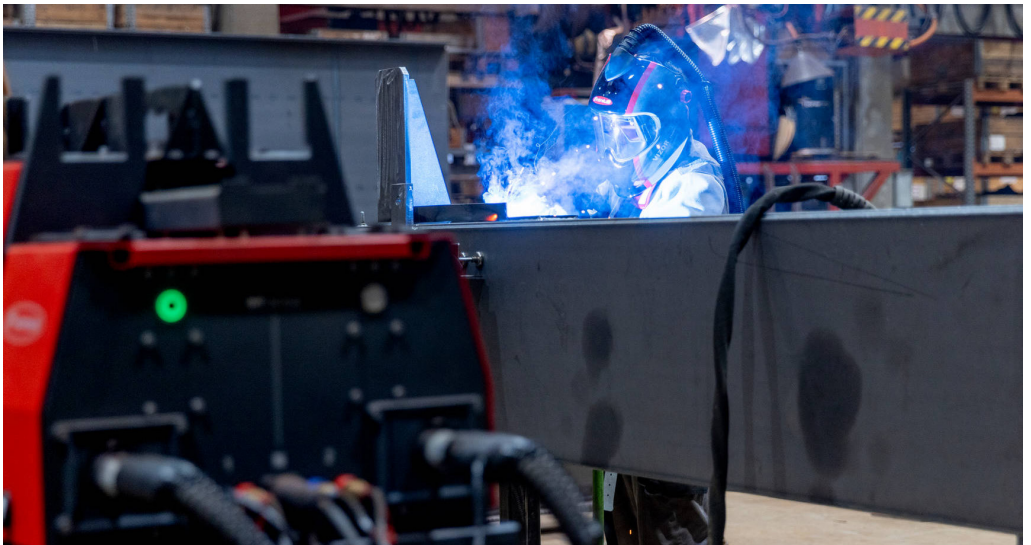

TPS 320i



AIR COOLED



TPS 320i with DualFeeder

MIG / TIG / STICK

Standard Package:

- / 320A power source
- / WF 25i wire feeder
- / MIG Torch, aircooled, 15'
- / TU Cart4 Pro (carriage/mount)
- / Ground Cable, 16', earth clamp
- / Consumables, .035 & .045 steel
- / Flow meter with gas adapter
- / Pre-Assembled & tested

/ Package # 49,0400,0088

/ MSRP: \$19,336

Included:

Two 400i MIG Torches

Part number: 4,036,423

Parts breakdown on page 74.



Package price is calculated as configured. Any changes, substitutions, or deletions may increase the package price. Carts not included, unless listed (ex. TU Cart4 Pro). Gas bottles are never included in packages.



WATER COOLED



TPS 320i MV with DualFeeder

MIG / TIG / STICK

Standard Package:

- / 320A power source
- / WF 25i wire feeder
- / MIG Torch, water cooled, 14'
- / MV Cooling Unit
- / TU Cart4 Pro (carriage/mount)
- / Ground Cable, 16', earth clamp
- / Consumables, .035 & .045 steel
- / Flow meter with gas adapter
- / Pre-Assembled & tested

/ Package # 49,0400,0089

/ MSRP: \$21,945

Included:

Two 500i MIG Torches

Part number: 4,035,960

Parts breakdown on page 75.





AIR COOLED



Included:
Two 400i MIG Torches
Part number: 4,036,423
Parts breakdown on page 74.

TPS 320i MV with DualFeeder for Boom*

MIG / TIG / STICK

Standard Package:

/ 320A power source
/ WF 25i wire feeder
/ MIG Torch, water cooled, 15'
/ Ground Cable, 16', earth clamp
/ Hosepack
/ Consumables, .035 & .045 steel
/ Flow meter with gas adapter
/ Pre-Assembled & tested

*Boom mount kit included, see page 19 for boom options

*Pictured RC panel and spool holders are not included. If you are using spool wire quantity 2 of 4,100,489 spool holders are required

/ MSRP: \$16,369

16.4' length hosepack:

/ Package # 49,0400,0090

32.8' length hosepack:

/ Package # 49,0400,0091

TPS 320i



WATER COOLED



Included:
Two 500i MIG Torches
Part number: 4,035,960
Parts breakdown on page 75.

TPS 320i MV with DualFeeder for Boom*

MIG / TIG / STICK

Standard Package:

- / 320A MV power source
- / WF 25i wire feeder
- / MIG Torch, water cooled, 14'
- / MV Cooling Unit
- / Ground Cable, 16', earth clamp
- / Hosepack
- / Consumables, .035 & .045 steel
- / Flow meter with gas adapter
- / Pre-Assembled & tested

*Boom mount kit included, see page 19 for boom options

*Pictured RC panel and spool holders are not included. If you are using spool wire quantity 2 of 4,100,489 spool holders are required

/ MSRP: \$18,651

16.4' length hosepack:

/ Package # 49,0400,0092

32.8' length hosepack:

/ Package # 49,0400,0093



12' Boom on pallet base*
/ Package # 42,0440,0325
/ MSRP: \$4,852

15' Boom on pallet base*
/ Package # 42,0440,0324
/ MSRP: \$5,128
*pallet base not pictured



10' Boom on mobile cart
/ Package # 42,0440,0327
/ MSRP: \$ 7,492

Fronius ready boom systems

Compatible with TransSteel and TPSi standard packages for boom welding systems. Contact us for iWave boom options.

- / Improves efficiency
- / improves ergonomics
- / less strain on manual welders - instead of moving the machine, the boom moves with the welding professional
- / Increases working radius

Boom packages include boom arm on pallet or mobile base, as selected.

** Standard welding packages for boom applications include the mounting brackets and fasteners required for Fronius ready booms systems.



TPS 400i

FEATURES

- / Fully digital synergic inverter
- / Touch screen
- / Improved arc characteristics
- / Color-coded consumables
- / All-in-one welding torch connection (FSC)
- / Highly portable
- / Rugged design
- / Highly adaptive arc
- / 3 years parts and labor warranty

OPTIONS & ACCESORIES

- / Polarity reversal
- / Advanced processes, LSC, PMC, CMT
- / Wheeled cart
- / Push-pull torch
- / Welding helmet
- / Welding jacket

TPS 400i Key Specifications

Processes	GMAW, GMAW-P, SMAW, DC GTAW
Open circuit voltage	67V
Dimensions (L-W-H)	27.8" x 11.8" x 20.1"
Weight	103.8 lbs
Safety Seals	CSA

Mains Voltage	3x200 Vac (-10% / 15%)			3x230 Vac (-10% / 15%)			3x460 Vac (-10% / 15%)		
Max Fuse protection	35A slow-blow								
Min generator requirement	22.5 kW			23.3 kW			23.8kW		
Mains cable	AWG 6						AWG 10		
Voltage range MIG	14.2 - 34.0 Vdc								
Voltage range TIG	10.1 - 26.0 Vdc								
Voltage range STICK	20.4 - 36.0 Vdc								
Current range MIG	3 - 400 A								
Current range TIG	3 - 400 A								
Current range STICK	10 - 400 A								
DUTY CYCLE	40%	60%	100%	40%	60%	100%	40%	60%	100%
104° F	400	360	320	400	360	320	400	360	320
77° F			400			400			400



AIR COOLED



Included:
400i US Style MIG Torch
Part number: 4,036,423
Parts breakdown on page 74.

TPS 400i MV

MIG / TIG / STICK

Standard Package:

/ 400A MV power source
/ WF 25i wire feeder
/ MIG Torch, aircooled, 15'
/ TU Cart4 Pro (carriage/mount)
/ Ground Cable, 16', earth clamp
/ Consumables, .035 & .045 steel
/ Flow meter with gas adapter
/ Pre-Assembled & tested

/ Package # 49,0400,0067

/ MSRP: \$12,932

Package price is calculated as configured. Any changes, substitutions, or deletions may increase the package price.
Carts not included, unless listed (ex. TU Cart4 Pro). Gas bottles are never included in packages.



WATER COOLED



Included:
500i MIG Torch
Part number: 4,035,960
Parts breakdown on page 75.

TPS 400i MV

MIG / TIG / STICK

Standard Package:

/ 400A power source
/ WF 25i wire feeder
/ MIG Torch, water cooled, 14'
/ MV Cooling Unit
/ TU Cart4 Pro (carriage/mount)
/ Ground Cable, 16', earth clamp
/ Consumables, .035 & .045 steel
/ Flow meter with gas adapter
/ Pre-Assembled & tested

/ Package # 49,0400,0068

/ MSRP: \$15,369

TPS 400i



AIR COOLED



TPS 400i MV for Boom*

MIG / TIG / STICK

Standard Package:

- / 400A power source
- / WF 25i wire feeder
- / MIG Torch, air cooled, 15'
- / Ground Cable, 16', earth clamp
- / Consumables, .035 & .045 steel
- / Flow meter with gas adapter
- / Pre-Assembled & tested

*Boom not included, see page 19 for boom options

/ MSRP: \$13,913

16.4' length hosepack:

/ Package # 49,0400,0108

32.8' length hosepack:

/ Package # 49,0400,0069



Included:
 400i US Style MIG Torch
 Part number: 4,036,423
 Parts breakdown on page 74.



WATER COOLED



Included:

500i MIG Torch

Part number: 4,035,960

Parts breakdown on page 75.

TPS 400i MV for Boom*

MIG / TIG / STICK

Standard Package:

- / 400A power source
- / WF 25i wire feeder
- / MIG Torch, water cooled, 14'
- / MV Cooling Unit
- / Ground Cable, 16', earth clamp
- / Consumables, .035 & .045 steel
- / Flow meter with gas adapter
- / Pre-Assembled & tested

*Boom not included, see page 19 for boom options

/ MSRP: \$16,313

16'.4 length hosepack:

/ Package # 49,0400,0109

32.8' length hosepack:

/ Package # 49,0400,0070

TPS 400i



WATER COOLED



Included: 400i CMT Torch

Part numbers: 4,047,813 and
44,0350,3168
Parts breakdown on page 79.

TPS 400i MV CMT

MIG / TIG / STICK

Standard Package:

- / 400A power source
- / CMT software
- / WF 25i wire feeder
- / Push/Pull CMT WC MIG Torch 19'
- / MV Cooling Unit
- / TU Cart4 Pro (carriage/mount)
- / Ground Cable, 16', earth clamp
- / Consumables, .035 & .045 steel
- / Flow meter with gas adapter
- / Pre-Assembled & tested

/ Package # 49,0400,0104

/ MSRP: \$25,860

Package price is calculated as configured. Any changes, substitutions, or deletions may increase the package price.
Carts not included, unless listed (ex. TU Cart4 Pro). Gas bottles are never included in packages.



WATER COOLED



TPS 400i with DualFeeder

MIG / TIG / STICK

Standard Package:

- / 400A power source
- / WF 25i Dual wire feeder
- / 2 MIG Torches, water cooled, 15'
- / MV Cooling Unit
- / TU Cart4 Pro (carriage/mount)
- / Ground Cable, 16', earth clamp
- / Consumables, .035 & .045 steel
- / Flow meter with gas adapter
- / Pre-Assembled & tested

/ Package # 49,0400,0095

/ MSRP: \$22,900

Included: Two 500i WC MIG Torches

Part numbers: 4,035,960
Parts breakdown on page 75.





WATER COOLED



Included:

400i MIG Torch

Part numbers: 4,047,807 and
44,0350,3173

Parts breakdown on page 78.

TPS 400i MV

Aluminum - MIG / TIG / STICK

Standard Package:

- / 400A power source
- / WF 25i wire feeder
- / Push/Pull WC MIG Torch
- / MV Cooling Unit
- / TU Cart4 Pro (carriage/mount)
- / Ground Cable, 16', earth clamp
- / Consumables .045 aluminum
- / Flow meter with gas adapter
- / Pre-Assembled & tested

/ MSRP: \$19,337

19' torch length:

/ Package # 49,0400,0072

25' torch length:

/ Package # 49,0400,0084

33' torch length:

/ Package # 49,0400,0085

TPS 400i



AIR COOLED



TPS 400i with DualFeeder
MIG / TIG / STICK

Standard Package:

- / 400A MV power source
- / WF 25i Dual wire feeders
- / 2 MIG Torches, aircooled, 15'
- / TU Cart4 Pro (carriage/mount)
- / Ground Cable, 16', earth clamp
- / Consumables, .035 & .045 steel
- / Flow meter with gas adapter
- / Pre-Assembled & tested

/ Package # 49,0400,0094

/ MSRP: \$20,550

Included:
500i US Style MIG Torch
Part number: 4,036,499
Parts breakdown on page 74.



**Services
and
Training**



From calibration to software upgrades and repair classes to welding processes, Fronius offers a variety of services and training to ensure you get the most out of your welding.

For questions about services contact: **pw-techsupport-us@fronius.com**

For available classes contact: **pw_wba_usa@fronius.com**

Service examples

- / Welding Machine Calibration
- / Welding Trials
- / Onsite Support

Class examples

- / Authorized Service and Repair
- / TPSi and iWave Weld Training
- / Weld Equipment Operations, Preventative Maintenance, and Consumable Upkeep

Training is available in-person or as instructor-led virtual classes.



WATER COOLED



TPS 400i MV with DualFeeder for Boom*

MIG / TIG / STICK

Standard Package:

- / 400A power source
- / WF 25i Dual wire feeder
- / 2 MIG Torches, water cooled, 14'
- / MV Cooling Unit
- / Ground Cable, 16', earth clamp
- / Consumables, .035 & .045 steel
- / Flow meter with gas adapter
- / Pre-Assembled & tested

*Boom mount kit included, see page 19 for boom options

*Pictured RC panel and spool holders are not included. If you are using spool wire quantity 2 of 4,100,489 spool holders are required

/ MSRP: \$19,699

16.4 length hosepack:

/ Package # 49,0400,0099

32.8' length hosepack:

/ Package # 49,0400,0100

Included:

Two 500i WC MIG Torches

Part number: 4,035,960

Parts breakdown on page 75.



TPS 400i



AIR COOLED



TPS 400i MV with DualFeeder for Boom*

MIG / TIG / STICK

Standard Package:

- / 400A power source
- / WF 25i Dual wire feeder
- / 2 MIG Torches, air cooled, 15'
- / Ground Cable, 16', earth clamp
- / Consumables, .035 & .045 steel
- / Flow meter with gas adapter
- / Pre-Assembled & tested

*Boom mount kit included, see page 19 for boom options

*Pictured RC panel and spool holders are not included. If you are using spool wire quantity 2 of 4,100,489 spool holders are required

/ MSRP: \$17,564

16.4' length hosepack:

/ Package # 49,0400,0097

32.8' length hosepack:

/ Package # 49,0400,0098

Included:

Two 500i MIG Torches

Part number: 4,036,499

Parts breakdown on page 74.



We take responsibility

We believe in sustainability

Long service life, repairability, and recyclability. Like all Fronius products, iWave is designed and produced with sustainability in mind. We use the latest technology to help protect people and the environment, and ensure a worthwhile future for coming generations.



Reducing the mental and physical load

For us, sustainability also means protecting people from physical and mental stress.

The new iWave operating concept, technologies for noise reduction during welding, or ergonomic aspects such as the working height of the systems or the design of the welding torch, all help to make the welder's life easier.

Environment and resources

During development of the new iWave series, we focused on bringing long-lasting and repairable systems into the market. A recyclable plastic housing and components that can be individually serviced and replaced help protect our environment. New technologies reduce power losses and gas consumption, thereby conserving resources.



TPS 500i

TPS 500i Key Specifications

Processes	GMAW, GMAW-P, SMAW, DC GTAW
Open circuit voltage	68V
Dimensions (L-W-H)	27.8" x 11.8" x 20.1"
Weight	103.8 lbs
Safety Seals	CSA

Mains Voltage	3x200 Vac (-10% / 15%)	3x230 Vac (-10% / 15%)	3x460 Vac (-10% / 15%)						
Max Fuse protection	63A slow-blow		35A slow-blow						
Min generator requirement	32.2 kW	31.8 kW	32.6 kW						
Mains cable	AWG 6		AWG 10						
Voltage range MIG	14.2 - 39.0 Vdc								
Voltage range TIG	10.1 - 30.0 Vdc								
Voltage range STICK	20.4 - 40.0 Vdc								
Current range MIG	3 - 500 A								
Current range TIG	3 - 500 A								
Current range STICK	10 - 500 A								
DUTY CYCLE	40%	60%	100%	40%	60%	100%	40%	60%	100%
104° F	500	430	360	500	430	360	500	430	360





AIR COOLED



Included:
500i US Style MIG Torch

Part numbers: 4,036,499
Parts breakdown on page 74.

TPS 500i MV

MIG / TIG / STICK

Standard Package:

- / 500A MV power source
- / WF 25i wire feeder
- / MIG Torch, aircooled, 15'
- / TU Cart4 Pro (carriage/mount)
- / Ground Cable, 16', earth clamp
- / Consumables, .035 & .045 steel
- / Flow meter with gas adapter
- / Pre-Assembled & tested

/ Package # 49,0400,0073

/ MSRP: \$13,874

Package price is calculated as configured. Any changes, substitutions, or deletions may increase the package price. Carts not included, unless listed (ex. TU Cart4 Pro). Gas bottles are never included in packages.



WATER COOLED



Included:
500i WC MIG Torch

Part numbers: 4,035,960
Parts breakdown on page 75.

TPS 500i MV

MIG / TIG / STICK

Standard Package:

- / 500A power source
- / WF 25i wire feeder
- / MIG Torch, water cooled, 14'
- / MV Cooling Unit
- / TU Cart4 Pro (carriage/mount)
- / Ground Cable, 16', earth clamp
- / Consumables, .035 & .045 steel
- / Flow meter with gas adapter
- / Pre-Assembled & tested

/ Package # 49,0400,0074

/ MSRP: \$16,313

TPS 500i



AIR COOLED



Included:
500i US Style MIG Torch
Part numbers: 4,036,499
Parts breakdown on page 74.

TPS 500i MV for Boom*

MIG / TIG / STICK

Standard Package:

- / 500A power source
- / WF 25i wire feeder
- / MIG Torch, air cooled, 15'
- / Ground Cable, 16', earth clamp
- / Consumables, .035 & .045 steel
- / Flow meter with gas adapter
- / Pre-Assembled & tested

*Boom not included, see page 19 for boom options

/ MSRP: \$14,856

16.4' hosepack:

/ Package # 49,0400,0110

32.8' hosepack

/ Package # 49,0400,0075



WATER COOLED



TPS 500i MV for Boom*

MIG / TIG / STICK

Standard Package:

- / 500A power source
- / WF 25i wire feeder
- / MIG Torch, water cooled, 15'
- / MV Cooling Unit
- / Hosepack
- / Ground Cable, 16', earth clamp
- / Consumables, .035 & .045 steel
- / Flow meter with gas adapter
- / Pre-Assembled & tested

*Boom not included, see page 19 for boom options

/ MSRP: \$16,358

16.4' hosepack:

/ Package # 49,0400,0111

32.8' hosepack:

/ Package # 49,0400,0076



Included:

500i WC MIG Torch

Part numbers: 4,035,960

Parts breakdown on page 75.

TPS 500i



WATER COOLED



Included:
320i Push/Pull MIG Torch
Part numbers: 4,047,807 and
44,0350,3173
Parts breakdown on page 78.

TPS 500i MV

Aluminum - MIG / TIG / STICK

Standard Package:

- / 500A power source
- / WF 25i wire feeder
- / Push/Pull WC MIG Torch
- / MV Cooling Unit
- / TU Cart4 Pro (carriage/mount)
- / Ground Cable, 16', earth clamp
- / Consumables, .045 aluminum
- / Flow meter with gas adapter
- / Pre-Assembled & tested

/ MSRP: \$20,281

19' length torch:

/ Package # 49,0400,0077

25' length torch:

/ Package # 49,0400,0086

33' length torch:

/ Package # 49,0400,0087



WATER COOLED



TPS 500i MV CMT

MIG / TIG / STICK

Standard Package:

- / 500A power source
- / CMT software
- / WF 25i wire feeder
- / Push/Pull CMT WC MIG Torch, 19'
- / MV Cooling Unit
- / TU Cart4 Pro (carriage/mount)
- / Ground Cable, 16', earth clamp
- / Consumables, .035 & .045 steel
- / Flow meter with gas adapter
- / Pre-Assembled & tested

/ Package # 49,0400,0105

/ MSRP: \$26,771

Included:

400i CMT MIG Torch

Part numbers: 4,047,813 and
44,0350,3168

Parts breakdown on page 79.



TPS 500i



AIR COOLED



Included:

Two 500i MIG Torches

Part number: 4,036,423

Parts breakdown on page 74.

TPS 500i MV with DualFeeder for Boom*

MIG / TIG / STICK

Standard Package:

- / 500A power source
- / WF 25i Dual wire feeder
- / 2 MIG Torches, air cooled, 15'
- / Ground Cable, 16', earth clamp
- / Consumables, .035 & .045 steel
- / Flow meter with gas adapter
- / Pre-Assembled & tested

*Boom mount kit included, see page 15 for boom options
 *Pictured RC panel and spool holders are not included. If you are using spool wire quantity 2 of 4,100,489 spool holders are required

/ MSRP: \$18,535

16.4' length hosepack:

/ Package # 49,0400,0112

32.8' length hosepack:

/ Package # 49,0400,0113



WATER COOLED



TPS 500i MV with DualFeeder for Boom*

MIG / TIG / STICK

Standard Package:

- / 500A power source
- / WF 25i Dual wire feeder
- / 2 WC MIG Torches, 14'
- / MV Cooling Unit
- / Ground Cable, 16', earth clamp
- / Consumables, .045 aluminum
- / Flow meter with gas adapter
- / Pre-Assembled & tested
- *Boom mount kit included, see page 15 for boom options
- *Pictured RC panel and spool holders are not included. If you are using spool wire quantity 2 of 4,100,489 spool holders are required

/ MSRP: \$20,669



Included:
Two 500i WC MIG Torches
Part number: 4,035,960
Parts breakdown on page 75.

16.4' length hosepack:
/ Package # 49,0400,0114

32.8' length hosepack:
/ Package # 49,0400,0115

TPS 500i



AIR COOLED



TPS 500i with DualFeeder

MIG / TIG / STICK

Standard Package:

- / 500A MV power source
- / WF 25i Dual wire feeders
- / 2 MIG Torches, aircooled, 15'
- / TU Cart4 Pro (carriage/mount)
- / Ground Cable, 16', earth clamp
- / Consumables, .035 & .045 steel
- / Flow meter with gas adapter
- / Pre-Assembled & tested

/ Package # 49,0400,0101

/ MSRP: \$21,535

Included:

Two 500i MIG Torches

Part number: 4,036,499

Parts breakdown on page 74.



Package price is calculated as configured. Any changes, substitutions, or deletions may increase the package price. Carts not included, unless listed (ex. TU Cart4 Pro). Gas bottles are never included in packages.



WATER COOLED



TPS 500i with DualFeeder

MIG / TIG / STICK

Standard Package:

- / 500A power source
- / WF 25i Dual wire feeder
- / 2 MIG Torches, aircooled, 15'
- / MV Cooling Unit
- / TU Cart4 Pro (carriage/mount)
- / Ground Cable, 16', earth clamp
- / Consumables, .035 & .045 steel
- / Flow meter with gas adapter
- / Pre-Assembled & tested

/ Package # 49,0400,0102

/ MSRP: \$23,997

Included:

Two 500i WC MIG Torches

Part numbers: 4,035,960

Parts breakdown on page 75.





TPS 600i Key Specifications

Processes	GMAW, GMAW-P, SMAW, DC GTAW
Open circuit voltage	85 V
Dimensions (L-W-H)	27.8" x 11.8" x 20.1"
Weight	103.6 lbs
Safety Seals	CSA

Mains Voltage	3x200 Vac (-10% / 15%)			3x230 Vac (-10% / 15%)			3x460 Vac (-10% / 15%)		
Max Fuse protection	N/A			N/A			63A slow - blow		
Min generator requirement	N/A			N/A			54.4 kW		
Mains cable	N/A			N/A			AWG 6		
Voltage range MIG	N/A			N/A			14.2 - 44.0 Vdc		
Voltage range TIG	N/A			N/A			10.1 - 34.0 Vdc		
Voltage range STICK	N/A			N/A			20.4 - 40.0 Vdc		
Current range MIG	N/A			N/A			3 - 600 A		
Current range TIG	N/A			N/A			3 - 600 A		
Current range STICK	N/A			N/A			10 - 600 A		
DUTY CYCLE	-	-	-	-	-	-	-	60%	100%
104° F	-	-	-	-	-	-	-	600	500

TPS 600i



WATER COOLED



Included:

500i WC MIG Torch

Part numbers: 4,035,960

Parts breakdown on page 75.

TPS 600i

MIG / TIG / STICK

Standard Package:

- / 600A MV power source
- / WF 25i wire feeder
- / MIG Torch, water cooled, 14'
- / MV Cooling Unit
- / TU Cart4 Pro (carriage/mount)
- / Ground Cable, 16', earth clamp
- / Consumables, .035 - .045 steel
- / Flow meter with gas adapter
- / Pre-Assembled & tested

/ Package # 49,0400,0078

/ MSRP: \$20,178

Package price is calculated as configured. Any changes, substitutions, or deletions may increase the package price. Carts not included, unless listed (ex. TU Cart4 Pro). Gas bottles are never included in packages.



WATER COOLED



Included:

500i WC MIG Torch

Part numbers: 4,035,960

Parts breakdown on page 75.

TPS 600i for Boom*

MIG / TIG / STICK

Standard Package:

- / 600A MV power source
- / WF 25i wire feeder
- / MIG Torch, water cooled, 14'
- / MV Cooling Unit
- / TU Cart4 Pro (carriage/mount)
- / Ground Cable, 16', earth clamp
- / Consumables, .035 & .045 steel
- / Flow meter with gas adapter
- / Pre-Assembled & tested

*Boom mount not included,
see page 19 for boom options

/ Package # 49,0400,0079

/ MSRP: \$21,597

iWave

INTELLIGENT TIG WELDING



- / PROFESSIONAL TIG WELDING WITH
MULTIPROCESS CAPABILITY
- / GRAPHICAL TOUCHSCREEN DISPLAY
- / TACKING FUNCTION
- / TOUCH HF
- / UP TO 1,000 WELD SCHEDULES
IN JOB MODE



iWave 300i

APPLICATION INDUSTRIES

FABRICATION, FOOD & BEVERAGE, AEROSPACE, AUTOMOTIVE, POWER GEN., TRANSPORTATION

The iWave is a professional-grade TIG welder with multiprocess capability. When high quality is demanded, the iWave provides a precise, stable arc with an easy-to-use touch screen interface.



/ GRAPHICAL, DYNAMIC MENU NAVIGATION – in 30+ languages

Our intuitive menu structure is straightforward and self-explanatory. Change settings easily and get right back to welding, without taking your gloves off.



/ ONE SYSTEM FOR ALL PROCESSES (IWAVE 300I – 500I)

In addition to all the TIG functions, with the iWave Multiprocess PRO you can also weld all MIG process variants. Take advantage of the modular concept and expand your high-tech welding system platform to suit your own specific needs with the Welding Packages Standard, Pulse, PMC, LSC, or CMT.

FEATURES

- / TAC – special tack mode
- / Automatic cap-shaping
- / Graphical touchscreen display
- / RPI easy ignition technology
- / Wireless networking & Bluetooth
- / 30+ languages
- / Weld schedule storage
- / Weld parameter protection
- / 3 years parts and labor warranty

OPTIONS & ACCESORIES

- / Torch controls
- / Wire feed for MIG only
- / Advanced welding processes
- / Gas and wire monitoring
- / Data monitoring

iWave 300i Key Specs

Processes	CV, Pulse, DC TIG, AC TIG, Stick
Open circuit voltage	102 Vdc
Dimensions (L-W-H)	27.8" x 11.8" x 28.41"
Weight	64.5 lbs
Safety Seals	UL, CSA

Mains Voltage	3 x 200 Vac (-10% /+6%)			3 x 230 Vac (-10% /+6%)			3 x 460 Vac (-10% / +6%)		
Max Fuse protection	35A slow - blow			35A slow - blow			16A slow -blow		
Min generator requirement	17.8 kW			17.5 kW			17.5 kW		
Mains cable	4 x AWG 8			4 x AWG 8			4 x AWG 10		
Voltage range MIG (multiprocess machine only)	14.2 - 29 Vdc			14.2 0 29 Vdc			14.2 0 29 Vdc		
Voltage range TIG	10.1 - 26.0 Vdc			10.1 - 26.0 Vdc			10.1 - 26.0 Vdc		
Voltage range STICK	20.4 - 36.0 Vdc			20.4 - 36.0 Vdc			20.4 - 36.0 Vdc		
Current range MIG (multiprocess machine only)	3 - 300 A			3 - 300 A			3 - 300 A		
Current range TIG	3 - 300 A			3 - 300 A			3 - 300 A		
Curent range STICK	10 - 300 A			10 - 300 A			10 - 300 A		
DUTY CYCLE	40%	60%	100%	40%	60%	100%	40%	60%	100%
104° F	300A	260A	240A	300A	260A	240A	300A	260A	240A

iWave 300i



WATER COOLED

**iWave 300i AC/DC TIG**

TIG / STICK

Standard Package:

- / 300A AC/DC welding power source
- / Cooling unit
- / TIG torch 26.3'
- / TU Cart4 Pro (carriage / mount)
- / Remote control foot pedal 16'
- / Ground cable, earth clamp 13'
- / Flow meter with gas adapter
- / Pre-assembled & tested

**Included:**
300P TIG Torch 26' (8m)Part numbers: 4,051,387 and
44,0350,4412

Parts breakdown on page 81.

/ Package #49,0400,0119**/ MSRP: \$13,890**

Package price is calculated as configured. Any changes, substitutions, or deletions may increase the package price.
Carts not included, unless listed (ex. TU Cart4 Pro). Gas bottles are never included in packages.



AIR COOLED

**iWave 300i AC/DC TIG**

TIG / STICK

Standard Package:

- / 300A AC/DC welding power source
- / TIG torch 26.3'
- / TU Cart4 Pro (carriage / mount)
- / Remote control foot pedal 16'
- / Ground cable, earth clamp 13'
- / Flow meter with gas adapter
- / Pre-assembled & tested

**Included:**
220P TIG Torch 26' (8m)Part numbers: 4,051,306 and
44,0350,5461

Parts breakdown on page 80.

/ Package #49,0400,0121**/ MSRP: \$11,950**



WATER COOLED



Included:
300P TIG Torch 26' (8m)

Part numbers: 4,051,387 and
44,0350,4412
Parts breakdown on page 81.

500i MIG Torch

Part numbers: 4,035,960
Parts breakdown on page 75.



iWave 300i AC/DC Multiprocess

MIG / TIG / STICK

Standard Package:

- / 300A AC/DC welding power source
- / Cooling unit
- / WF 25i wire feeder
- / TIG torch 26.3'
- / MIG torch 14.7'
- / Remote control foot pedal 16'
- / Ground cable, earth clamp 13'
- / TU Cart4 Pro (carriage / mount)
- / Dual bottle holder
- / Flow meter with gas adapter
- / Pre-assembled & tested

/ Package #49,0400,0118

/ MSRP: \$20,048

Package price is calculated as configured. Any changes, substitutions, or deletions may increase the package price.
Carts not included, unless listed (ex. TU Cart4 Pro). Gas bottles are never included in packages.



AIR COOLED



Included:
220P TIG Torch 26' (8m)

Part numbers: 4,051,306 and
44,0350,5461
Parts breakdown on page 80.

320i MIG Torch

Part numbers: 4,036,407
Parts breakdown on page 70.



iWave 300i AC/DC Multiprocess

MIG / TIG / STICK

Standard Package:

- / 300A AC/DC welding power source
- / WF 25i wire feeder
- / TIG torch 26.3'
- / MIG torch, 15'
- / Remote control foot pedal 16'
- / Ground cable, earth clamp 13'
- / TU Cart4 Pro (carriage / mount)
- / Dual bottle holder
- / Flow meter with gas adapter
- / Pre-assembled & tested

/ Package #49,0400,0120

/ MSRP: \$18,003

iWave 400i

iWave 400i Key Specs

Processes	CV, Pulse, DC TIG, AC TIG, Stick
Open circuit voltage	102 Vdc
Dimensions (L-W-H)	27.8" x 11.8" x 28.41"
Weight	150.8 lbs
Safety Seals	UL, CSA

Mains Voltage	3 x 200 Vac (-10% /+6%)			3 x 230 Vac (-10% /+6%)			3 x 460 Vac (-10% / +6%)		
Max Fuse protection	63A slow - blow			63A slow - blow			35A slow -blow		
Min generator requirement	29.3 kW			29.5 kW			29.1 kW		
Mains cable	4 x AWG 6			4 x AWG 6			4 x AWG 10		
Voltage range MIG (multiprocess machine only)	14.2 - 34.0 V			14.2 - 34.0 V			14.2 - 34.0 V		
Voltage range TIG	10.1 - 26.0 Vdc			10.1 - 26.0 Vdc			10.1 - 26.0 Vdc		
Voltage range STICK	20.4 - 36.0 Vdc			20.4 - 36.0 Vdc			20.4 - 36.0 Vdc		
Current range MIG (multiprocess machine only)	3 - 400 A			3 - 400 A			3 - 400 A		
Current range TIG	3 - 400 A			3 - 400 A			3 - 400 A		
Curent range STICK	10 - 400 A			10 - 400 A			10 - 400 A		
DUTY CYCLE	40%	60%	100%	40%	60%	100%	40%	60%	100%
104° F	400A	360A	320A	400A	360A	320A	400A	360A	320A



WATER COOLED



Included:
400i TIG Torch 26'

Part numbers: 4,051,330 and
44,0350,4414
Parts breakdown on page 80.



iWave 400i AC/DC TIG / STICK

Standard Package:

- / 400A AC/DC welding power source
- / Cooling unit
- / TIG torch 26'
- / Remote control foot pedal 16'
- / Ground cable, earth clamp 13'
- / TU Cart4 Pro (carriage / mount)
- / Dual bottle holder
- / Flow meter with gas adapter
- / Pre-assembled & tested

/ Package #49,0400,0122

/ MSRP: \$18,273



WATER COOLED



Included:
TIG Torch 26'

Part numbers: 4,051,330 and
44,0350,4414
Parts breakdown on page 80.

500i MIG Torch

Part numbers: 4,035,960
Parts breakdown on page 75.



iWave 400i DC Multiprocess
MIG / DC TIG / STICK

Standard Package:

/ 400A AC/DC welding power source
/ MIG torch 14'
/ TIG torch 26'
/ Remote control foot pedal 16'
/ Ground cable, earth clamp 13'
/ TU Cart4 Pro (carriage / mount)
/ Dual bottle holder
/ Flow meter with gas adapter
/ Pre-assembled & tested

/ Package #49,0400,0125
/ MSRP: \$20,438

Package price is calculated as configured. Any changes, substitutions, or deletions may increase the package price.
Carts not included, unless listed (ex. TU Cart4 Pro). Gas bottles are never included in packages.



WATER COOLED



Included:
TIG Torch 26'

Part numbers: 4,051,330 and
44,0350,4414
Parts breakdown on page 80.



iWave 400i DC
DC TIG / STICK

Standard Package:

/ 400A DC welding power source
/ TIG torch 26'
/ Remote control foot pedal 16'
/ Ground cable, earth clamp 13'
/ TU Cart4 Pro (carriage / mount)
/ Flow meter with gas adapter
/ Pre-assembled & tested

/ Package #49,0400,0123
/ MSRP: \$14,305

iWave 400i



AIR COOLED

Included:
 220P TIG Torch 26'

Part numbers: 4,051,306 and
 44,0350,5461
 Parts breakdown on page 80.

Two 500i MIG Torches
 Part numbers: 4,036,499
 Parts breakdown on page 74.

**iWave 400i DC Multiprocess
 with DualFeeder**
 MIG / DC TIG / STICK

Standard Package:

/ 400A DC welding power source
 / WF 25i Dual wire feeder
 / 2 MIG Torches, aircooled, 15'
 / TIG torch 26'
 / Remote control foot pedal 16'
 / Ground cable, earth clamp 13'
 / TU Cart4 Pro (carriage / mount)
 / Flow meter with gas adapter
 / Pre-assembled & tested

/ Package #49,0400,0136
/ MSRP: \$26,033

Package price is calculated as configured. Any changes, substitutions, or deletions may increase the package price.
 Carts not included, unless listed (ex. TU Cart4 Pro). Gas bottles are never included in packages.



WATER COOLED

Included:
 220P TIG Torch 26'

Part numbers: 4,051,330 and
 44,0350,4414
 Parts breakdown on page 78.

Two 500i MIG Torches
 Part numbers: 4,035,960
 Parts breakdown on page 75.

iWave 400i DC with DualFeeder
 MIG / DC TIG / STICK

Standard Package:

/ 400A DC welding power source
 / Cooling unit
 / WF 25i Dual wire feeder
 / 2 MIG torches 14'
 / TIG torch 26'
 / Remote control foot pedal 16'
 / Ground cable, earth clamp 13'
 / TU Cart4 Pro (carriage / mount)
 / Flow meter with gas adapter
 / Pre-assembled & tested

/ Package #49,0400,0137
/ MSRP: \$29,097



WATER COOLED



Included:
400P TIG Torch 26' (8m)

Part numbers: 4,051,330 and
44,0350,4414
Parts breakdown on page 80.

500i MIG Torch

Part numbers: 4,035,960
Parts breakdown on page 75.

iWave 400i AC/DC MultiProcess
MIG / TIG / STICK

Standard Package:

- / 400A AC/DC welding power source
- / Cooling unit
- / WF 25i wire feeder
- / MIG torch 14'
- / TIG torch 26'
- / Remote control foot pedal 16'
- / Ground cable, earth clamp 13'
- / TU Cart4 Pro (carriage / mount)
- / Dual bottle holder
- / Flow meter with gas adapter
- / Pre-assembled & tested

/ Package #49,0400,0124

/ MSRP: \$24,704

Package price is calculated as configured. Any changes, substitutions, or deletions may increase the package price.
Carts not included, unless listed (ex. TU Cart4 Pro). Gas bottles are never included in packages.



WATER COOLED



Included:
400P TIG Torch 26' (8m)

Part numbers: 4,051,330 and
44,0350,4414
Parts breakdown on page 80.

320i Push/Pull MIG Torch

Part numbers: 4,051,045 and
44,0350,3173
Parts breakdown on page 78.

iWave 400i AC/DC Multiprocess
Aluminum MIG / TIG / STICK

Standard Package:

- / 400A AC/DC welding power source
- / Cooling unit
- / WF 25i wire feeder
- / TIG torch 26'
- / Push/Pull MIG torch 26'
- / Remote control foot pedal 16'
- / Ground cable, earth clamp 13'
- / TU Cart4 Pro (carriage / mount)
- / Dual bottle holder
- / Flow meter with gas adapter
- / Pre-assembled & tested

/ Package #49,0400,0126

/ MSRP: \$28,295



iWave 400i



AIR COOLED



iWave 400 LSC Adv. with DualFeeder

MIG / TIG / STICK

Standard Package:

/ 400A MV AC/DC power source
 / LSC Advanced software
 / WF 25i Dual wire feeder
 / 2 MIG Torches, aircooled, 15'
 / TU Cart4 Pro (carriage/mount)
 / Ground Cable, 16', earth clamp
 / Consumables, .035 & .045 steel
 / Flow meter with gas adapter
 / Pre-Assembled & tested

/ Package # 49,0400,0141

/ MSRP: \$28,094



Included:

500i US Style MIG Torch

Part numbers: 4,036,499

Parts breakdown on page 74.

Package price is calculated as configured. Any changes, substitutions, or deletions may increase the package price. Carts not included, unless listed (ex. TU Cart4 Pro). Gas bottles are never included in packages.



WATER COOLED



iWave 400i AC/DC Multiprocess with CMT

MIG / TIG / STICK

Standard Package:

/ 400A AC/DC welding power source
 / Cooling unit
 / CMT software
 / WF 25i wire feeder
 / Push/Pull CMT MIG torch w/c 16'
 / TIG torch 26'
 / Remote control foot pedal 16'
 / Ground cable, earth clamp 13'
 / TU Cart4 Pro (carriage / mount)
 / Dual bottle holder
 / Flow meter with gas adapter
 / Pre-assembled & tested

/ Package #49,0400,0127

/ MSRP: \$34,681



Included:

400P TIG Torch 26'

Part numbers: 4,051,330 and 44,0350,4414

Parts breakdown on page 80.

400i CMT MIG Torch

Part numbers: 4,047,813 and 44,0350,3172

Parts breakdown on page 79.

iWave 500i Key Specs

Processes	CV, Pulse, DC TIG, AC TIG, Stick
Open circuit voltage	102 Vdc
Dimensions (L-W-H)	27.8" x 11.8" x 28.41"
Weight	152.56 lbs
Safety Seals	UL, CSA

Mains Voltage	3 x 200 Vac (-10% / +6%)			3 x 230 Vac (-10% / +6%)			3 x 460 Vac (-10% / +6%)		
Max Fuse protection	63A slow - blow			63A slow - blow			35A slow - blow		
Min generator requirement	32.9 kW			36.7 kW			36.7 kW		
Mains cable	4 x AWG 4			4 x AWG 4			4 x AWG 8		
Voltage range MIG (multiprocess machine only)	14.2 - 36.5 Vdc			14.2 - 36.5 Vdc			14.2 - 36.5 Vdc		
Voltage range TIG	10.1 - 30.0 Vdc			10.1 - 30.0 Vdc			10.1 - 30.0 Vdc		
Voltage range STICK	20.4 - 40.0 Vdc			20.4 - 40.0 Vdc			20.4 - 40.0 Vdc		
Current range MIG (multiprocess machine only)	3 - 500 A			3 - 500 A			3 - 500 A		
Current range TIG	3 - 500 A			3 - 500 A			3 - 500 A		
Current range STICK	10 - 500 A			10 - 500 A			10 - 500 A		
DUTY CYCLE	40%	60%	100%	40%	60%	100%	40%	60%	100%
104° F	500A	430A	360A	500A	430A	360A	500A	430A	360A



iWave 500i



WATER COOLED



iWave 500i DC

DC TIG / STICK

Standard Package:

- / 500A DC welding power source
- / Cooling unit
- / TIG torch 26'
- / Remote control foot pedal 16'
- / Ground cable, earth clamp 13'
- / TU Cart4 Pro (carriage / mount)
- / Flow meter with gas adapter
- / Pre-assembled & tested



Included:

400P TIG Torch 26' (8m)

Part numbers: 4,051,330 and
44,0350,4414

Parts breakdown on page 80.

/ Package #49,0400,0129

/ MSRP: \$15,429

Package price is calculated as configured. Any changes, substitutions, or deletions may increase the package price. Carts not included, unless listed (ex. TU Cart4 Pro). Gas bottles are never included in packages.



WATER COOLED



iWave 500i AC/DC

TIG / STICK

Standard Package:

- / 500A AC/DC welding power source
- / Cooling unit
- / TIG torch 26'
- / Remote control foot pedal 16'
- / Ground cable, earth clamp 13'
- / TU Cart4 Pro (carriage / mount)
- / Flow meter with gas adapter
- / Pre-assembled & tested



Included:

400P TIG Torch 26' (8m)

Part numbers: 4,051,330 and
44,0350,4414

Parts breakdown on page 78.

/ Package #49,0400,0128

/ MSRP: \$20,108



WATER COOLED



Included:
400P TIG Torch 26' (8m)

Part numbers: 4,051,330 and
44,0350,4414
Parts breakdown on page 80.

500i MIG Torch

Part numbers: 4,035,960
Parts breakdown on page 75.



iWave 500i DC Multiprocess

MIG / DC TIG / STICK

Standard Package:

/ 500A AC/DC welding power source
/ Cooling unit
/ WF 25i wire feeder
/ TIG torch 26'
/ MIG torch, 14'
/ Remote control foot pedal 16'
/ Ground cable, earth clamp 13'
/ TU Cart4 Pro (carriage / mount)
/ Dual bottle holder
/ Flow meter with gas adapter
/ Pre-assembled & tested

/ Package #49,0400,0131

/ MSRP: \$21,563

Package price is calculated as configured. Any changes, substitutions, or deletions may increase the package price. Carts not included, unless listed (ex. TU Cart4 Pro). Gas bottles are never included in packages.



WATER COOLED



Included:
400P TIG Torch 26' (8m)

Part numbers: 4,051,330 and
44,0350,4414
Parts breakdown on page 80.

500i MIG Torch

Part numbers: 4,035,960
Parts breakdown on page 75.



iWave 500i AC/DC Multiprocess

MIG / TIG / STICK

Standard Package:

/ 500A AC/DC welding power source
/ Cooling unit
/ WF 25i wire feeder
/ TIG torch 26'
/ MIG torch 14'
/ Remote control foot pedal 16'
/ Ground cable, earth clamp 13'
/ TU Cart4 Pro (carriage / mount)
/ Dual bottle holder
/ Flow meter with gas adapter
/ Pre-assembled & tested

/ Package #49,0400,0130

/ MSRP: \$26,634

iWave 500i



AIR COOLED



Included:
220P TIG Torch 26'

Part numbers: 4,051,306 and 44,0350,5461

Parts breakdown on page 80.

Two 500i MIG Torches

Part numbers: 4,036,499
Parts breakdown on page 74.



iWave 500i DC Multiprocess with DualFeeder

MIG / DC TIG / STICK

Standard Package:

- / 500A DC welding power source
- / WF 25i Dual wire feeder
- / 2 MIG Torches, aircooled, 15'
- / TIG torch 26'
- / Remote control foot pedal 16'
- / Ground cable, earth clamp 13'
- / TU Cart4 Pro (carriage / mount)
- / Flow meter with gas adapter
- / Pre-assembled & tested

/ Package #49,0400,0138

/ MSRP: \$26,775

Package price is calculated as configured. Any changes, substitutions, or deletions may increase the package price. Carts not included, unless listed (ex. TU Cart4 Pro). Gas bottles are never included in packages.



WATER COOLED



Included:
220P TIG Torch 26'

Part numbers: 4,051,330 and 44,0350,4414

Parts breakdown on page 80.

Two 500i MIG Torches

Part numbers: 4,035,960
Parts breakdown on page 75.



iWave 500i DC with DualFeeder

MIG / DC TIG / STICK

Standard Package:

- / 500A DC welding power source
- / WF 25i Dual wire feeder
- / 2 MIG torches 14'
- / TIG torch 26'
- / Remote control foot pedal 16'
- / Ground cable, earth clamp 13'
- / TU Cart4 Pro (carriage / mount)
- / Flow meter with gas adapter
- / Pre-assembled & tested

/ Package #49,0400,0139

/ MSRP: \$29,934



WATER COOLED



iWave 500i AC/DC Multiprocess TIG / STICK

Standard Package:

- / 500A AC/DC welding power source
- / Cooling unit
- / WF 25i wire feeder
- / TIG torch 26'
- / Push/Pull MIG torch water cooled
- / Remote control foot pedal 16'
- / Ground cable, earth clamp 13'
- / TU Cart4 Pro (carriage / mount)
- / Dual bottle holder
- / Flow meter with gas adapter
- / Pre-assembled & tested

/ Package #49,0400,0140

/ MSRP: \$29,934

Included:

400P TIG Torch 26' (8m)

Part numbers: 4,051,330 and
44,0350,4414

Parts breakdown on page 80.

320i Push/Pull MIG Torch

Part numbers: 4,0051,045
and 44,0350,3173

Parts breakdown on page 78.



Introducing DynamicWire

Active wire control in TIG cold wire welding



The innovative advantage of Fronius TIG DynamicWire, when compared to a conventional continuous wire feed in cold wire systems, lies in its automatic self-regulation. The power source actively adjusts the wire speed to the welding behavior, torch position, and current conditions, even compensating automatically for component tolerances of up to 30%.

THE RESULT? Perfect welds every time.

Existing iWave cold wire systems can be easily upgraded with the patented TIG DynamicWire Welding Package through software activation.



/ SIMPLIFIED HANDLING AND MINIMAL TRAINING TIME

Unlike welding with a constant wirefeed, DynamicWire and the wire feeder adapt to the welder, not the other way around. The simplified handling enables even less-experienced welders to quickly produce high-quality TIG welds.



/ ALWAYS THE RIGHT WIRE SPEED

The dynamic wire feed system automatically adjusts the wire speed to the current conditions. This means that the optimum amount of wire is always available – without any manual adjustment.



WATER COOLED



iWave 300i AC/DC TIG with DynamicWire

TIG / STICK

Standard Package:

- / 300A AC/DC welding power source
- / DynamicWire package
- / Cooling unit
- / TIG torch, 26', with cold wire add on
- / Tungsten Fast Clamp (TFC) included
- / Ground cable, earth clamp 13'
- / TU Cart4 Pro (carriage / mount)
- / Flow meter with gas adapter
- / Pre-assembled & tested

/ Package #49,0400,0132

/ MSRP: \$18,744



Included: 400P TIG Torch 26' (8m)

Part numbers: 4,051,387 and
44,0350,4414,630
Parts breakdown on page 82.



Available as add-on: Dynamic Pen

Part numbers: 44,0350,4676
Parts breakdown on page 82.

Package price is calculated as configured. Any changes, substitutions, or deletions may increase the package price.
Carts not included, unless listed (ex. TU Cart4 Pro). Gas bottles are never included in packages.



WATER COOLED



iWave 300i DC TIG with DynamicWire

DC TIG / STICK

Standard Package:

- / 300A DC welding power source
- / DynamicWire package
- / Cooling unit
- / TIG torch, 26', with cold wire add on
- / Tungsten Fast Clamp (TFC) included
- / Ground cable, earth clamp 13'
- / TU Cart4 Pro (carriage / mount)
- / Flow meter with gas adapter
- / Pre-assembled & tested

/ Package #49,0400,0133

/ MSRP: \$16,511



Included: 400P TIG Torch 26' (8m)

Part numbers: 4,051,387 and
44,0350,4414,630
Parts breakdown on page 82.



Available as add-on: Dynamic Pen

Part numbers: 44,0350,4676
Parts breakdown on page 82.

DynamicWire



WATER COOLED



iWave 400i AC/DC TIG with DynamicWire

TIG / STICK

Standard Package:

- / 400A AC/DC welding power source
- / DynamicWire package
- / Cooling unit
- / WF 25i wire feeder
- / TIG torch, 26', with cold wire add on
- / Tungsten Fast Clamp (TFC) included
- / Ground cable, earth clamp 13'
- / TU Cart4 Pro (carriage / mount)
- / Flow meter with gas adapter
- / Pre-assembled & tested

/ Package #49,0400,0134

/ MSRP: \$23,501



Included: 400P TIG Torch 26' (8m)

Part numbers: 4,051,387 and
44,0350,4414,630
Parts breakdown on page 82.



Available as add-on: Dynamic Pen

Part numbers: 44,0350,4676
Parts breakdown on page 82.

Package price is calculated as configured. Any changes, substitutions, or deletions may increase the package price. Carts not included, unless listed (ex. TU Cart4 Pro). Gas bottles are never included in packages.



WATER COOLED



iWave 400i DC TIG with DynamicWire

DC TIG / STICK

Standard Package:

- / 400A DC welding power source
- / DynamicWire package
- / Cooling unit
- / TIG torch, 26', with cold wire add on
- / Tungsten Fast Clamp (TFC) included
- / Remote control foot pedal 16'
- / Ground cable, earth clamp 13'
- / TU Cart4 Pro (carriage / mount)
- / Flow meter with gas adapter
- / Pre-assembled & tested

/ Package #49,0400,0135

/ MSRP: \$19,617



Included: 400P TIG Torch 26' (8m)

Part numbers: 4,051,387 and
44,0350,4414,630
Parts breakdown on page 82.



Available as add-on: Dynamic Pen

Part numbers: 44,0350,4676
Parts breakdown on page 82.

Exento



/ MOBILE FUME EXTRACTION OPTIONS

/ PROMOTING HEALTHIER AIR DURING
WELDING PROCESSES



Exento

APPLICATION

WORKPLACE SAFETY

PROTECTION AGAINST WELDING FUMES

All welding processes produce fumes, gases, and vapors that affect the welders. How harmful the released welding fumes are depends on the combination of welding process, parent material, and filler metals, as well as the protective gas shield.

Mobile extraction devices, like our new Exento line, remove harmful fumes and particulates to ensure the health and safety of welding personnel.



/ Mobile low-vacuum extraction unit with positionable extraction arm.

/ Increased safety due to filter monitoring and contamination-free filter replacement



/ Mobile high-vacuum extraction unit for use with a wide variety of fume extraction torches: infinitely variable pre-selection of the extraction capacity

/ Intuitive, single-button operation, even while wearing gloves

FEATURES

- / Long filter life
- / Rugged design
- / Optimized flanged hood with 40% higher capture rate*
- / Modular design with several extraction arm lengths
- / Robust construction expandable with accessories

EXENTO OPTIONS ON PAGE 66

- / Accessories
- / Consumables
- / Hose options

*compared with conventional oval extraction hood

	Exento LV 115V/B	Exento LV 460v
Mains voltage (+/- 10%)	1x115v/60Hz	3x460v/60Hz
Motor power	1.5 kw / 2.04 hp	1.5 kw / 2.04 hp
Rated current	17 A	2.6 A
Max. extraction capacity	1100 m ³ /h / 647cfm	
Max. vacuum	2250 Pa / 9.04 in wc	
Noise level	70 dB(A)	
Dimensions (l x w x h)	32.9 x 31.3 x 46 in (836 x 795 x 1169 mm)	
Weight	280 lbs (127 kg)	
Filter stages	2	
Filter Surface	25 m ² / 38,750 in ²	
Type of Filter	Disposable Safe Change Filter	
Filter material	Non-woven polyester	
Filter efficiency	≥99.5%	
Filter class	E12	
Additional filter	Pre-filter (aluminium)	
Fan type	Radial fan	
Extraction arm type, lengths	Flexible extraction arm, 2m / 3m / 4m	
IFA-Certification	W3-approved	
Protection class	IP21	

Exento LowVac



Exento LowVac

Fume extraction

Standard Package:

- / Exento LV
- / Mounting frame with 10' hose
- / Extraction hood
- / Swivel joint
- / Spare upgraded filter - 452 ft²

/ Single Phase (115V only)
Package #49,0400,0003

/ MSRP: \$6,496

/ Three Phase (460V only)
Package #49,0400,0004

/ MSRP: \$6,496



FEATURES

- / High filter quality removes 99.9% fine dust
- / Intuitive one-button operation
- / Semi-automatic filter cleaning
- / Constant extraction rate control
- / Automatic stop/start control (optional)

EXENTO OPTIONS ON PAGE 66

- / Accessories
- / Consumables
- / Hose options

	Exento HighVac 460V
Mains voltage (+/- 10%)	3x460 V 50/60 Hz
Motor power	2.2 kW / 2.99 hp
Rated current	5.8 A
Max. extraction capacity	170 m ³ /h / 100.06 cfm
Max. vacuum	3100 Pa / 124.46 in wc
Noise level	77.9 dB(A)
Dimensions (l x w x h)	24.7 x 23.4 x 46.5 in (627 x 594 x 1182 mm)
Weight	143.3 lbs (65 kg)
Filter stages	1
Filter method	Cleanable filter
Filter cleaning method, trigger	Rotating nozzle, button activated
Filter Surface	10,385 in ² / 6.7 m ²
Type of Filter	Disposable Safe Change Filter
Filter material	ePTFE-membrane
Filter efficiency	≥99.9%
Dust classification	M
Fan type	Side channel blower
Compressed air supply	87-116 psi / 6-8 bar
Protection class	IP21

Exento HighVac



Torches not included with these packages.



Exento HighVac

CLEANING / PASSIVATION / MARKING

Standard Package:

- / Exento HV 460V
- / HV extraction hose ϕ 44mm 8'
- / HV extraction hose ϕ 44mm 16'
- / Reducer 63/44mm IT/IT
- / Motor cooling prefilter mats
- / Filter cartridge (ePTFE)
- / Single-use disposal container
- / Exentometer measuring tube

/ Exento HighVac 460V

(no torch or torch extraction set)

Package #49,0400,0006

/ MSRP: \$9,278

/ Exento HighVac 460V with

external extraction set for existing MTG 400US, 500US, 45/60 and robotic torches set

Package #49,0400,0008

/ MSRP: \$9,883

/ Exento HighVac 460V with

OPT/i external extraction set for existing Medium /5m torches

Package #49,0400,0014

/ MSRP: \$9,605



Exento HighVac

CLEANING / PASSIVATION / MARKING

Standard Package:

- / Exento HV 460V
- / HV extraction hose ϕ 44mm 8'
- / HV extraction hose ϕ 44mm 16'
- / Reducer 63/44mm IT/IT
- / Motor cooling prefilter mats
- / Filter cartridge (ePTFE)
- / Single-use disposal container
- / Exentometer measuring tube

/ Exento HighVac 460V with
400i MTG torch and external torch
extraction set

Package #49,0400,0007

/ MSRP: \$10,273



/ Exento HighVac 460V with
500i MTW Exento torch with
internal extraction and LED

Package #49,0400,0015

/ MSRP: \$10,129



/ Exento HighVac 460V with
500i Exento Jobmaster torch with
internal extraction and LED

Package #49,0400,0016

/ MSRP: \$10,393

EXENTO OPTIONS AND ACCESSORIES



ACCESSORIES	Exento LowVac	Exento HV	Price
Start/Stop Automatic	42,0510,0405		\$485
Exhaust air connection NW 200	42,0510,0407		\$255
Mounting frame with 2m hose	42,0510,0475		\$679
Mounting frame with 4m hose	42,0510,0477		\$894
Extraction hood with LED	42,0510,0408		\$466
Torch holder start/stop (add below cable)		44,0350,4515	\$348
Signal Cable M12ST/M12B 10m		38,0001,0159	\$60
Automatic start/stop - current detection		42,0510,0473	\$485
Tool tray		42,0510,0474	\$201
Exhaust air filter H13 cpl.		42,0510,0488	\$585
Optional Pistol grip for Exento torch		44,0350,2169	\$108
CONSUMABLES			
LV replacement filter - 42 m ²	42,0510,0406		\$959
Motor cooling prefilter mats*		42,0510,0462,10	\$53
Filter cartridge (ePTFE)*		42,0510,0472	\$548
Replacement filter set H13 (2 pc)		42,0510,0495	\$205
Single-use disposal container*		42,0510,0447	\$62
HV EXTRACTION HOSES			
HV extraction hose ø44mm 2.5m *		42,0510,0481	\$115
HV extraction hose ø44mm 5m		42,0510,0482	\$227
HV extraction hose ø63mm 5m *		42,0510,0489	\$294
HV extraction hose ø63mm 7.5m		42,0510,0490	\$443
HV extraction hose ø63mm 10m		42,0510,0483	\$590
Reducer 63/44mm IT/IT*		42,0510,0491	\$85

* included in standard package

Personal Protective Equipment



/ WELDING HELMETS

/ WELDING JACKETS



INTRODUCING: VIZOR CRYSTAL SERIES

The Vizor Crystal series features unique glare protection. In light conditions, you can perceive color almost as clearly as you would through a clear glass window. In darkness, welders have a detailed and high-contrast view of the weld pool, with unprecedented clarity.



VIZOR Crystal

Auto-darkening welding helmet

- / Panoramic field of view
- / Ultraviolet/infrared protection
- / Automated shade level (4 to 12)
- / Lithium-polymer battery (Chargeable via USB-C cable, supported by solar cells)
- / Shade level 2 in passive mode
- / Total weight 1.3 lb
- / Grind mode

Part number:

42,0510,0396 Vizor Crystal

MSRP: \$905

Vizor 4000 Crystal

Auto-darkening welding helmet



- / Ultraviolet/infrared protection
- / Automated shade level (4 to 12)
- / Sensitivity controller
- / Shade level 2 in passive mode
- / Battery for LC display
- / Total weight 1.1 lb
- / Grind mode

Part number:

42,0510,0479 Vizor 4000 Crystal

MSRP: \$743

VIZOR CONNECT

Pre-darkening bluetooth welding helmet



- / Bluetooth connection*
- / True Color view
- / Panorama field of view
- / Automated shade level (5 to 12)
- / Lithium-polymer battery (Chargeable via USB-C cable, supported by solar cells)
- / Shade level 2.5 in passive mode
- / Grind mode

Part number:

42,0510,0312 Vizor Connect

MSRP: \$830

*Compatible with TPS/i 320 - 600 (from sn 29200502 and 4,067,101 NFC/BLE/WIFI 24 inside (firmware version 2.0.1), MagicWave230i and TransTIG 230i



VIZOR 4000 Professional

AUTODARKENING WELDING HELMET

- / Sensor slide: detection angle of ambient light from 80° to 60°
- / Auto mode, SL 5 to SL 13
- / Grinding mode, remains light (protection level 4)
- / Protection level: SL 5-9 and SL 9-13
- / Sensitivity controller
- / Real color display
- / Soft Delay

Part number:

42,0510,0197 Vizor 4000 Professional

MSRP: \$655



FAZOR 1000 Plus

AUTODARKENING WELDING HELMET

- / Permanent protection from UV/IR radiation
- / Continuous shade-level settings (9 to 13)
- / Dark-to-light delay
- / Sensitivity controller
- / Battery-change for LC display
- / Total weight 1.09 lb

Part number:

42,0510,0110 - Fazor 1000 Plus

MSRP: \$304

ACCESSORIES & WEAR PARTS VIZOR / FAZOR / VIZOR CONNECT

Part No.	Accessories & Wear Parts	MSRP
42,0510,0020	Vizor chest protection/bib	\$66.00
42,0510,0326	Vizor connect /Grind Mask: Complete Headband	\$46.58
42,0510,0018	Vizor/ Fazor/ Vizor Connect: Head band	\$9.45
42,0510,0200	Comfort band (headband back)	\$11.34
42,0510,0113	Fazor 1000 Plus: Cartridge	\$236.00
42,0510,0327	Vizor Connect: USB-C cable (2 pcs per set)	\$16.88
42,0510,0329	Vizor Connect: USB-C cover cap (2 pcs per set)	\$6.62
42,0510,0527	Ergo headgear: Replacement pad	\$74.00
42,0510,0534	Ergo headgear: Forehead pad	\$12.02
42,0510,0519	Ergo headgear for the Vizor 4000, 4000 Crystal, and Fazor 1000	\$109.00
42,0510,0523	Ergo headgear for the Vizor Connect, Vizor Crystal, and Grind mask	\$109.00
42,0510,0078	Backpack for welding helmet	\$34.97
Cover Lenses		
42,0510,0315	Vizor Connect: Inside cover lens (5 pcs per set)	\$24.17
42,0510,0322	Vizor Connect: Inside cover lens 1.00 diopter	\$59.00
42,0510,0323	Vizor Connect: Inside cover lens, 1.50 diopter	\$59.00
42,0510,0324	Vizor Connect: Inside cover lens, 2.00 diopter	\$59.00
42,0510,0325	Vizor Connect: Inside cover lens, 2.50 diopter	\$59.00
42,0510,0336	Vizor Connect: Inside cover lens, shade level 1.0 (5pcs per set)	\$77.00
42,0510,0345	Vizor Connect: Inside cover lens, shade level 2.0 (5pcs per set)	\$77.00
42,0510,0317	Vizor Connect/ Vizor Crystal: Front cover lens (5 pcs/set)	\$59.00
42,0510,0092	Vizor 4000/ Vizor 4000 Crystal: Inside cover lens (5 pcs/set)	\$13.37
42,0510,0100	Vizor Pro, Plus and Fazor: Inside cover lens, shade level 1.0 (5 pcs/set)	\$25.65
42,0510,0101	Vizor Pro, Plus and Fazor: Inside cover lens, shade level 1.5 (5 pcs/set)	\$25.65
42,0510,0102	Vizor Pro, Plus and Fazor: Inside cover lens, shade level 2.0 (5 pcs/set)	\$25.65
42,0510,0112	Fazor: Cover lens (5 pcs per set) 1 pk	\$20.25
42,0510,0023	Vizor: Cover lens (2 pcs per set)	\$16.88
42,0510,0024	Vizor: Cover lens (5 pcs per set)	\$36.45

Ergo headgear

Precise adjustable liner system for a perfect fit

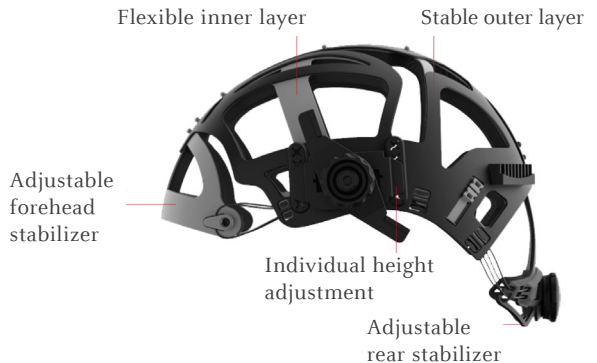

ACCESSORIES

**WELDING JACKET BASIC****BASIC WELDING JACKET BY BIZWELD**

- / Flame retardant
- / All day welding protection and comfort
- / Secure stud fasteners
- / Chest pockets
- / Concealed mobile phone pocket
- / Fabric: Bizweld 330g, 100% cotton with a flame resistant finish
- / Modern fit. If between sizes, size up.

Part number - per size

- 42,0440,0233 - S
- 42,0440,0234 - M
- 42,0440,0235 - L
- 42,0440,0236 - XL
- 42,0440,0237 - 2XL
- 42,0440,0238 - 3XL

MSRP: \$86.00**WELDING JACKET DELUXE****WELDING JACKET BY CHICAGO APPAREL**

- / Flame retardant
- / All day welding protection and comfort
- / Combo Carbon X and Marlan Fabrics retardant materials
- / Covered snap front and wrists
- / Pen/pencil pocket on upper arm
- / Fit is true to size

Part number - per size MSRP

- | | |
|--------------------|-------|
| 42,0440,0310 - S | \$266 |
| 42,0440,0311 - M | \$266 |
| 42,0440,0312 - L | \$266 |
| 42,0440,0313 - XL | \$266 |
| 42,0440,0314 - 2XL | \$293 |
| 42,0440,0315 - 3XL | \$320 |
| 42,0440,0316 - 4XL | \$346 |
| 42,0440,0317 - 5XL | \$372 |

Welding Torches

GMAW / GTAW / Exento



- / ERGONOMIC
- / LIGHT
- / COMPACT
- / RAPID COOLING

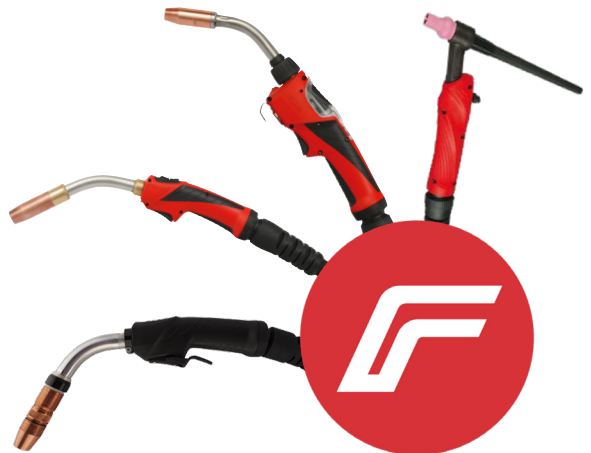

GMAW Torches

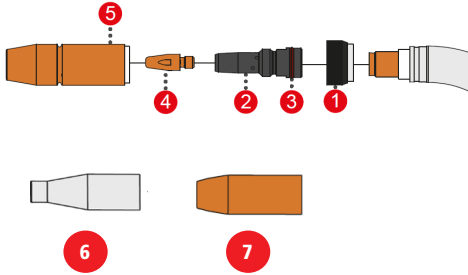

MTG 500i US Style

#	Part No.	Description
1	44,0350,4371	Insulating end ring
3	42,0402,0334	O-ring, torch gas nozzle
2	42,0001,1145,5	Diffuser, Nozzle stock
4	42,0001,6464,10	Contact tip, steel, M8, .030
	42,0001,6465,10	Contact tip, steel, M8, .035
	42,0001,6466,10	Contact tip, steel, M8, .040
	42,0001,6467,10	Contact tip, steel, M8, .045
	42,0001,6469,10	Contact tip, steel, M8, 1/16
5	44,0350,1567,5	Gas nozzle, standard

MTG 320i / MTG400i US Style

#	Part No.	Description
1	44,0350,4371	Insulating end ring
3	42,0402,0334	O-ring, torch gas nozzle
2	42,0001,6639,5	Diffuser, Nozzle stock
4	42,0001,6464,10	Contact tip, steel, M8, .030
	42,0001,6465,10	Contact tip, steel, M8, .035
	42,0001,6466,10	Contact tip, steel, M8, .040
	42,0001,6467,10	Contact tip, steel, M8, .045
	42,0001,6469,10	Contact tip, steel, M8, 1/16
5	44,0350,2028,5	Gas nozzle, standard
6	44,0350,2108,5	Gas Nozzle Narrow Gap
7	44,0350,2030,5	Gas Nozzle Heavy Duty

MTG 320i US STYLE FSC/EH/15°60° MTG 400i US STYLE FSC/EH/15°60° MTG 500i US STYLE FSC/EH/15°60°

Part Numbers: 4,036,407 / 4,036,422 /
4,036,423 / 4,036,425 / 4,036,499



MTG 320i DUTY CYCLE (104°F)

100%	60%	40%
60A	80A	320A

MTG 400i DUTY CYCLE (104°F)

100%	60%	40%
260A	320A	400A

MTG 500i DUTY CYCLE (104°F)

100%	60%	30%
300A	400A	500A

Part No.	Description
Liner (steel filler metal)	
40,0002,0052,005	.030
40,0002,0053,005	.035
40,0002,0054,005	.045
40,0002,0055,005	1/16
Clamp	
44,0350,3317,5	.035 (blue)
44,0350,3318,5	.045 (red)
44,0350,3320,5	1/16 (black)
Feeder drive rolls	
44,0001,1406,4	.035 (blue)
44,0001,1407,4	.045 (red)
44,0001,1408,4	1/16 (black)

TRANSSTEEL 2200 DRIVE ROLLERS

Part No.	Description
42,0001,6688	0.8 T
42,0001,6689	0.8/1.0 T

MTW 500i FSC/15'/20'/45° LED
MTB 500i '45° 44,0350,3173

Part Number: 4,035,960

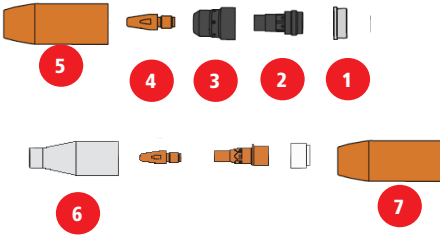

DUTY CYCLE (104°F)

100%

500A

#	Part No.	Description
1	42,0100,1329,5	Insulating ring
2	42,0001,4037,5	Nozzle stock
3	42,0405,0854,5	Spatter guard
	42,0100,0591,5	Spatter guard HD
4	42,0001,6464,10	Contact tip, steel, M8, .030
	42,0001,6465,10	Contact tip, steel, M8, .035
	42,0001,6466,10	Contact tip, steel, M8, .040
	42,0001,6467,10	Contact tip, steel, M8, .045
	42,0001,6469,10	Contact tip, steel, M8, 1/16
5	42,0001,4050,5	Gas nozzle standard
6	42,0001,4917,5	Gas nozzle, narrow gap
	42,0001,4919,5	Narrow gap nozzle stock, M6
	42,0100,1497,5	Narrow gap insulating ring
7	42,0001,4216,5	Gas nozzle heavy duty

Part No.	Description
Liner (steel filler metal)	
40,0002,0052,005	.035
40,0002,0053,005	.040
40,0002,0054,005	.045
40,0002,0055,005	1/16
Clamp	
44,0350,3317,5	.035 (blue)
44,0350,3318,5	.045 (red)
44,0350,3320,5	1/16 (black)
Feeder drive rolls	
44,0001,1406,4	.035 (blue)
44,0001,1407,4	.045 (red)
44,0001,1408,4	1/16 (black)

GMAW Torches

MTW 500i EXENTO FSC/EH/15'45°

Part Number: 4,036,479

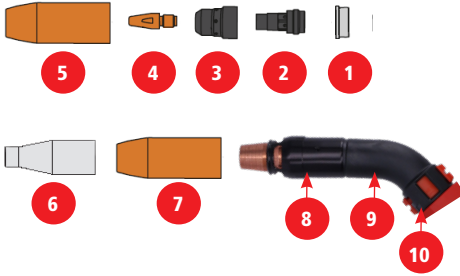

MTW 500i DUTY CYCLE (104°F)

100%

500A

MTW 500i

#	Part No.	Description
1	42,0100,1329,5	Insulating ring
2	42,0001,4037,5	Nozzle stock
3	42,0405,0854,5	Spatter guard
	42,0100,0591,5	Spatter guard HD
4	42,0001,6464,10	Contact tip, steel, M8, .030
	42,0001,6465,10	Contact tip, steel, M8, .035
	42,0001,6466,10	Contact tip, steel, M8, .040
	42,0001,6467,10	Contact tip, steel, M8, .045
	42,000,6469,10	Contact tip, steel, M8, 1/16
5	42,0001,4050,5	Gas nozzle standard
6	42,0001,4917,5	Gas nozzle narrow gap
	42,0001,4919,5	Narrow gap nozzle stock M6
	42,0100,1497,5	Narrow gap insulating ring
7	42,0001,4216,5	Gas nozzle heavy duty
8	42,1000,0755	Extraction Nozzle
	42,1500,0522	O-ring
9	42,1400,0255	Elbow piece R/L 45deg
10	42,1400,0248	Bypass controller (order 2pcs)

Part No.	Description
Liner (steel filler metal)	
40,0002,0052,005	.030
40,0002,0053,005	.035
40,0002,0054,005	.045
40,0002,0055,005	1/16
Clamp	
44,0350,3317,5	.035 (blue)
44,0350,3318,5	.045 (red)
44,0350,3329,5	1/16 (black)
Feeder drive rolls	
44,0001,1406,4	.035 (blue)
44,0001,1407,4	.045 (red)
44,0001,1408,4	1/16 (black)
Extraction items	
42,0510,0481	extraction hose 44mm /8ft
42,0510,0482	extraction hose 44mm/16ft
44,0350,2079	Exentometer measure tube

MTG 400i US STYLE FSC/EH/15°45° AND OPT/I EXENTO SET

Part Numbers: 4,036,422 / 44,0350,1536

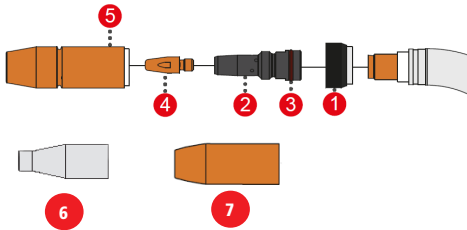

MTG 400i US Style 4,036,422

#	Part No.	Description
1	44,0350,4371	Insulating end ring
3	42,0402,0334	O-ring, torch gas nozzle
2	42,0001,6639,5	Diffuser, Nozzle stock
4	42,0001,6464,10	Contact tip, steel, M8, .030
	42,0001,6465,10	Contact tip, steel, M8, .035
	42,0001,6466,10	Contact tip, steel, M8, .040
	42,0001,6467,10	Contact tip, steel, M8, .045
	42,0001,6469,10	Contact tip, steel, M8, 1/16
5	44,0350,2028,5	Gas nozzle, standard
6	44,0350,2030,5	Gas Nozzle Heavy Duty
7	44,0350,2108,5	Gas Nozzle Narrow Gap

Part No.	Description
Liner (steel filler metal)	
40,0002,0052,005	.035
40,0002,0053,005	.040
40,0002,0054,005	.045
40,0002,0055,005	1/16
Clamp	
44,0350,3317,5	.035 (blue)
44,0350,3318,5	.045 (red)
44,0350,3320,5	1/16 (black)
Feeder drive rolls	
44,0001,1406,4	.035 (blue)
44,0001,1407,4	.045 (red)
44,0001,1408,4	1/16 (black)



MTG 400i DUTY CYCLE (104°F)

100%	60%	40%
260A	320A	400A

OPT/I EXENTO SET 44,0350,1536



#	Part No.	Description
8	44,0350,4021	Extraction Nozzle
	42,1200,0569	Centering Clips (order 2 pcs)
	42,0407,0832	Lock washer
9	42,0405,1238	Elbow piece 45°
10	44,0350,0882	Housing FumeEx R/L
11	42,0405,1236	Housing FumeEx R/L
	42,0402,0261	Locking Ring
	42,0402,0264	O-ring
	42,1000,0640	Holding Clamp
	42,0405,1235	Admixed air ring
12	42,0405,1234	Hose ring
13	40,001,0573	Hose 3'

GMAW Torches

MTG 320i PUSH PULL

Part number: Torch whip: 4,047,807

Torch body: 44,0350,3173



STANDARD CONSUMABLES

#	Part No.	Description
1	42,0100,1329,5	Insulation ring
2	42,0001,4037,5	Nozzle stock
3	42,0405,0854,5	Spatter guard
4	42,0001,6464,10	Contact tip, steel, M8, .030"
	42,0001,6465,10	Contact tip, steel, M8, .035"
	42,0001,6466,10	Contact tip, steel, M8, .040"
	42,0001,6467,10	Contact tip, steel, M8, .045"
	42,0001,6469,10	Contact tip, steel, M8, 1/16"
5	42,0001,4080,5	Gas nozzle, standard

HEAVY DUTY CONSUMABLES

1	42,0100,0530,5	Insulation ring
3	42,0100,0591,5	Spatter guard, heavy duty
5	42,0001,4216,5	Gas nozzle, heavy duty

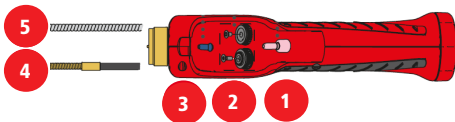

TORCH DRIVE CONSUMABLES

#	Part No.	Description
1	42,0405,2055	Guide nozzle, rear, .045"
	42,0405,2054	Guide nozzle, rear, 1/16"
2	44,0001,1490	Feeder roll set, .030"
	44,0001,1491	Feeder roll set, .035"
	44,0001,1492	Feeder roll set, .040"
	44,0001,1493	Feeder roll set, .045"
	44,0001,1495	Feeder roll set, 1/16"
	44,0001,1495	Feeder roll set, 1/16"
3	42,0405,2053	Gas nozzle, front, .030"
	42,0405,2052	Gas nozzle, front, .035"

DUTY CYCLE (104°F)

100%
320

Part No.	Description
Liner (graphite)	
40,0001,0530,010	.035"
40,0001,0531,030	.045"
40,0001,0532,100	1/16"
Clamps	
44,0350,4082,5	.035" (blue)
44,0350,4083,5	.045" (red)
44,0350,4084,5	1/16" (black)
Feeder drive rolls (WF25i)	
44,0001,1406,4	.035" (blue)
44,0001,1407,4	.045" (red)
44,0001,1408,4	1/16" (black)

#	Part No.	Description
3	42,0405,2051	Gas nozzle, front, .040"
	42,0405,2050	Gas nozzle, front, .045"
	42,0405,2047	Gas nozzle, front, 1/16"
4	44,0350,3173	Torch body insert, Al, .030"
	44,0350,3174	Torch body insert, Al, .035"
	44,0350,3175	Torch body insert, Al, .045"
	44,0350,3716	Torch body insert, Al, 1/16"
	44,0350,3716	Torch body insert, Al, 1/16"
5	See manual	steel and stainless options

MTB400i /MHP 400i CMT

Part Number: Torch whip 4,047,813

Torch body: 44,0350,3168

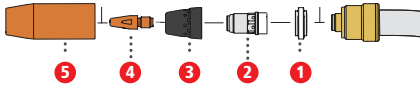

STANDARD CONSUMABLES

#	Part No.	Description
1	42,0100,1329,5	Insulating ring
2	42,0001,4037,5	Nozzle stock
3	42,0405,0854,5	Spatter guard
4	42,0001,6464,10	Contact tip, steel, M8, .030"
	42,0001,6465,10	Contact tip, steel, M8, .035"
	42,0001,6466,10	Contact tip, steel, M8, .040"
	42,0001,6467,10	Contact tip, steel, M8, .045"
	42,0001,6469,10	Contact tip, steel, M8, 1/16"
5	42,0001,4051,5	Gas nozzle standard
	42,0001,4496,5	Gas nozzle aluminum

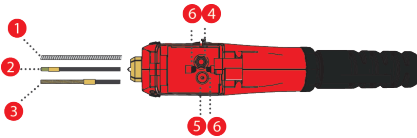

TORCH DRIVE CONSUMABLES

#	Part No.	Description
1, 3, 11	See manual	Steel and stainless options
2	44,0350,3713	Torch body insert, Al, .030"
	44,0350,3714	Torch body insert, Al, .035"
	44,0350,3715	Torch body insert, Al, .045"
	44,0350,3716	Torch body insert, Al, 1/16"
4	42,0001,5774	Feeder roll .035"
5	42,0001,5772	Pressure roll .035"
4	42,0001,5735	Feeder roll .045"
5	42,0001,5730	Pressure roll .045"
6	42,0100,1119	Guide nozzle, rear, .035"
	42,0100,1003	Guide nozzle, rear, .045"

DUTY CYCLE (104°F)	
100% (CMT)	100% (CV)
280A	400A

Part No.	Description
Liner (steel filler metal)	
40,0002,0041,005	.035"
40,0002,0042,005	.045"
40,0002,0043,005	1/16"
Clamp	
44,0350,4082,5	.035" (blue)
44,0350,4083,5	.045" (red)
44,0350,4084,5	1/16" (black)
Feeder drive rolls (WF25i)	
44,0001,1406,4	.035" (blue)
44,0001,1407,4	.045" (red)
44,0001,1408,4	1/16" (black)

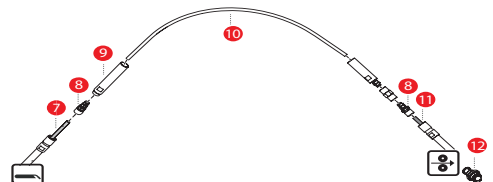

#	Part No.	Description
7	44,0450,1967	Graphite Inner liner
8	42,0001,3583	Clamping piece graphite liner
	42,0001,5833	Clamping piece steel liner
9	42,0001,5724	Slide Piece wire buffer .030" - .052"
	42,0001,5728	Slide Piece wire buffer 1/16" - 3/32"
10	44,0350,2444	Liner wire buffer .045"
	42,0404,1012	Liner wire buffer 1/16"

GTAW Torches

Used with these machines:
iWave 300i, 400i, 500i

DUTY CYCLE (220P / 400P)

	100%	60%	35%
AC	100A / 250A	130A / 320A	180A / NA
DC	130A / 300A	170A / 400A	220A / NA

44,0350,5461 TTB 220P

44,0350,4414 TTB 400P

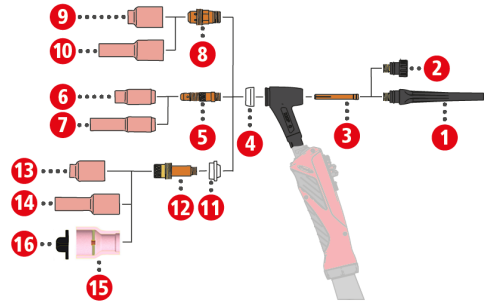

#	Part No.	Description
1	44,0350,1597	Torch cap, long
2	44,0350,1596	Torch cap, short
3	42,0001,1057	Clamping sleeve MS 1,0/ø6,35x52
	42,0001,1058	Clamping sleeve MS 1,6/ø6,35x52
	42,0001,0682	Clamping sleeve MS 2,0/ø6,35x52
	42,0001,1071	Clamping sleeve MS 2,4/ø6,35x52
	42,0001,1127	Clamping sleeve MS 3,2/ø6,35x52
	42,0001,1128	Clamping sleeve MS 4,0/ø6,35x51,5
4	42,0100,0408	Head shield standard ø22/ø15x10
5	42,0001,3032	Clamping sleeve case 1,0/ø11,1x46,8
	42,0001,3033	Clamping sleeve case 1,6/ø11,1x46,8
	42,0001,3034	Clamping sleeve case 2,4/ø11,1x46,8
	42,0001,3035	Clamping sleeve case 3,2/ø11,1x46,8
	42,0001,3036	Clamping sleeve case 4,0/ø11,1x46,8
6	42,0300,2276	Gas nozzle ceramic ø6,5/ø18x47
	42,0300,2277	Gas nozzle ceramic ø8/ø18x47
	42,0300,2278	Gas nozzle ceramic ø9,5/ø18x47
	42,0300,2279	Gas nozzle ceramic ø11/ø18x47
	42,0300,2280	Gas nozzle ceramic ø12,5/ø18x47
	42,0300,2281	Gas nozzle ceramic ø16/ø20,5x47
	42,0300,2282	Gas nozzle ceramic ø19,5/ø23,5x50
7	42,0300,2283	Gas nozzle ceramic ø8/ø18x76
	42,0300,2284	Gas nozzle ceramic ø9,5/ø18x76
	42,0300,2285	Gas nozzle ceramic ø11/ø18x76
8	42,0001,2862	Clamping sleeve case 2,4/ø19x33
	42,0001,2863	Clamping sleeve case 3,2/ø19x33
	42,0001,2864	Clamping sleeve case 4,0/ø19x33
9/13	42,0300,2009	Gas nozzle ceramic ø6,5/ø24,5x42
	42,0300,2010	Gas nozzle ceramic ø8/ø24,5x42
	42,0300,2011	Gas nozzle ceramic ø9,5/ø24,5x42

#	Part No.	Description
	42,0300,2012	Gas nozzle ceramic ø11/ø24,5x42
	42,0300,2013	Gas nozzle ceramic ø12,5/ø24,5x42
	42,0300,2304	Gas nozzle ceramic ø19/ø24,5x42
10/14	42,0300,2273	Gas nozzle ceramic ø8/ø24x76
	42,0300,2826	Gas nozzle ceramic ø9,5/ø24x59
	42,0300,2274	Gas nozzle ceramic ø9,5/ø24x76
	42,0300,2275	Gas nozzle ceramic ø11/ø24x76
11	42,0100,0401	Insulating ring ø23/ø12,3x13,6
12	44,0350,1595	Gas lens 1,0/ø19x50
	44,0350,1362	Gas lens 1,6/ø19x50
	44,0350,1363	Gas lens 2,4/ø19x50
	44,0350,1364	Gas lens 3,2/ø19x50
	44,0350,1365	Gas lens 4,0/ø19x50
15	44,0350,1685	Gas Nozzle Set ceramic champagne ø1.0
	44,0350,1686	Gas Nozzle Set ceramic champagne ø1.6
	44,0350,1687	Gas Nozzle Set ceramic champagne ø2.0
	44,0350,1508	Gas Nozzle Set ceramic champagne ø2.4
	44,0350,1688	Gas Nozzle Set ceramic champagne ø3.2
	44,0350,1689	Gas Nozzle Set ceramic champagne ø4.0
16	44,1100,0149	Positioning pin ø23,5 12,5mm
17	44,0350,1343	Gas lens small TTB220/400P TFC
18	44,0350,1282	Clamping unit TTB220/400 P TFC
19	42,0001,1025	Collet chuck ø1.6 M6x0.75 TFC
	42,0001,1009	Collet chuck ø2.4 M6x0.75 TFC
	42,0001,1022	Collet chuck ø3.2 M6x0.75 TFC

44,0350,4412 TTB 300P

Used with these machines:
iWave 300i

DUTY CYCLE (104°F)	
100%	60%
230A / 190A	300A/ 250A

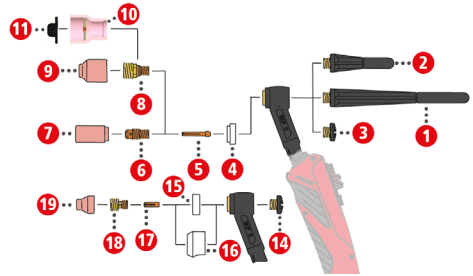

#	Part No.	Description
1	44,0350,1495	Torch cap, long
2	44,0350,1496	Torch cap, medium
3	44,0350,1761	Torch cap, short
4	42,0100,0391	Head shield standard $\varnothing 20/\varnothing 10, 1 \times 7$
5	42,0001,3000	Clamping sleeve 1,0/ $\varnothing 4,5 \times 25$
	42,0001,2571	Clamping sleeve 1,6/ $\varnothing 4,5 \times 25$
	42,0001,2572	Clamping sleeve 2,4/ $\varnothing 4,5 \times 25$
	42,0001,2573	Clamping sleeve 3,2/ $\varnothing 4,5 \times 24,3$
6	42,0001,2827	Clamping sleeve case 1,0/ $\varnothing 9,5 \times 20,6$
	42,0001,0260	Clamping sleeve case 1,6/ $\varnothing 9,5 \times 20,6$
	42,0001,0261	Clamping sleeve case 2,4/ $\varnothing 9,5 \times 20,6$
	42,0001,0262	Clamping sleeve case 3,2/ $\varnothing 9,5 \times 20,6$
7	42,0300,0105	Gas nozzle ceramic $\varnothing 6,3/\varnothing 14,2 \times 29,5$
	42,0300,0106	Gas nozzle ceramic $\varnothing 8,0/\varnothing 14,2 \times 29,5$
	42,0300,0107	Gas nozzle ceramic $\varnothing 9,5/\varnothing 14,2 \times 29,5$
	42,0300,0108	Gas nozzle ceramic $\varnothing 11,2/\varnothing 16,2 \times 29,5$
	42,0300,0109	Gas nozzle ceramic $\varnothing 12,7/\varnothing 17,6 \times 29,5$
	42,0300,0110	Gas nozzles ceramic $\varnothing 16/\varnothing 21 \times 30$
8	42,0001,1343	Gas lens 1,0/ $\varnothing 14 \times 22,5$
	42,0001,1344	Gas lens 1,6/ $\varnothing 14 \times 22,5$
	42,0001,1345	Gas lens 2,4/ $\varnothing 14 \times 22,5$
	42,0001,1346	Gas lens 3,2/ $\varnothing 14 \times 22,5$
9	42,0300,0982	Gas nozzle ceramic $\varnothing 6,3/\varnothing 20 \times 25,5$
	42,0300,0983	Gas nozzle ceramic $\varnothing 8/\varnothing 20 \times 25,5$
	42,0300,0984	Gas nozzle ceramic $\varnothing 9,5/\varnothing 20 \times 25,5$
	42,0300,2007	Gas nozzle ceramic $\varnothing 11,2/\varnothing 20 \times 25,5$
	42,0300,2008	Gas nozzle ceramic $\varnothing 12,5/\varnothing 19 \times 25,5$
10	44,0350,1681	Gas Nozzle Set ceramic champagne $\varnothing 1.0$
	44,0350,1682	Gas Nozzle Set ceramic champagne $\varnothing 1.6$
	44,0350,1683	Gas Nozzle Set ceramic champagne $\varnothing 2.0$
	44,0350,1690	Gas Nozzle Set ceramic champagne $\varnothing 2.4$

#	Part No.	Description
	44,0350,1684	Gas Nozzle Set ceramic champagne $\varnothing 3.2$
	42,1600,0050	Gas Nozzle ceramic champagne $\varnothing 25/\varnothing 19 \times 29$
11	42,1100,0141	Positioning pin $\varnothing 19$
14	44,0350,1497	Torch cap short
15	42,0100,0387	Head shield short $\varnothing 12/\varnothing 20 \times 6$
16	42,0100,0388	Head shield short $\varnothing 10, 1/\varnothing 23 \times 16$
17	42,0001,3002	Clamping sleeve 1,0/ $\varnothing 3,2 \times 14$
	42,0001,3003	Clamping sleeve 1,6/ $\varnothing 3,2 \times 14$
	42,0001,3004	Clamping sleeve 2,4/ $\varnothing 4 \times 13,5$
18	44,0350,1489	Gas lens 1,0/ $\varnothing 11,5 \times 15$
	44,0350,1490	Gas lens 1,6/ $\varnothing 11,5 \times 15$
	44,0350,1491	Gas lens 2,4/ $\varnothing 11,5 \times 15$
19	42,0300,2244	Gas nozzle ceramic $\varnothing 6,5/\varnothing 16 \times 16$
	42,0300,2245	Gas nozzle ceramic $\varnothing 8/\varnothing 16 \times 16$
	42,0300,2246	Gas nozzle ceramic $\varnothing 9,5/\varnothing 16 \times 16$

GTAW Torches

DYNAMICWIRE SPAREPARTS

Used with:
iWave DynamicWire systems
TTB 220P/400P

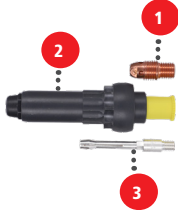

#	Part No.	Description
1	44,0350,1343	Gas lens small TTB220/400P TFC
2	44,0350,1282	Clamping unit TTB220/400 P TFC
3	42,0001,1025	Collet chuck ϕ 1.6 M6x0.75 TFC
	42,0001,1009	Collet chuck ϕ 2.4 M6x0.75 TFC
	42,0001,1022	Collet chuck ϕ 3.2 M6x0.75 TFC
4	44,0350,1585	CW Mounting
	42,1200,0499	Multitool TFC
5	42,1700,0042	Dynamic Pen
6	42,1000,1159	Support Disc
7	42,1000,1158	Support Disc
8	42,1000,1160	Nozzle
9	42,0001,4461,10	M6 contact tip 0.030"
	42,0001,4462,10	M6 Contact tip 0.035"
	42,0001,4464,10	M6 contact tip 0.045"
	42,0001,4466,10	M6 contact tip 1/16"
10	42,1000,1172	Connection piece
11	40,0001,0418	Hose PUR 5.5x1.2x8
12	44,0350,4080,5	Clamping pc 0.8mm/0.030"
	44,0350,4082,5	Clamping pc 0.9mm/0.035"
	44,0350,4083,5	Clamping pc 1.2mm/0.040"
	44,0350,4084,5	Clamping pc 1/16 / 1.6mm
13	40,0001,0274	Teflon liner 0.030" 4.8m/14.5ft
	40,0001,0258	Teflon liner 0.035" 4.8m/14.5ft
	40,0001,0272	Teflon liner 0.040" 4.8m/14.5ft
	40,0001,0275	Teflon liner 1/16" 4.8m/14.5ft

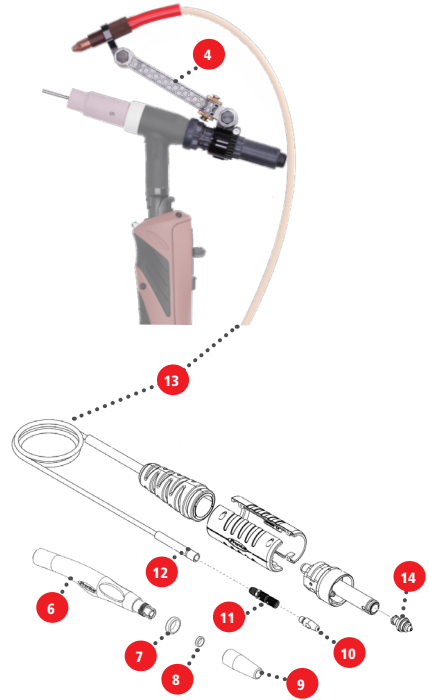

Machine options and carts



Options

Machine options		TPS/i Compact	TPS/i split Series	TransSteel	iWave MP PRO	
Part No	Description					MSRP
4,100,811,CK	Dust filter		•			\$99.00
4,100,805,CK	Second Earth Rear dinse		•			\$254.00
4,100,928,CK	TPSi second plus socket dinse front		•			\$217.00
4,100,801,CK	TPSi C Second plus socket rear	•				\$290.00
4,100,810,CK	Second Speednet port	•				\$321.00
4,100,812,CK	Second Speednet port*		•			\$398.00
4,044,031	Key Fob		•			\$41.85
4,044,032	Key Card		•			\$24.30
4,100,907,CK	TIG Kit	•				\$329.00
4,100,803,CK	Push Pull kit	•				\$1,153.00
4,051,030	Polarity reversal HP		•			\$342.00
4,101,058,IK	Key Lockout Switch			•		\$193.00
Contact Tips						MSRP
42,0001,6464,10	.030 Contact tips M8	•	•	•	•	\$25.00
42,0001,6465,10	.035 Contact tips M8	•	•	•	•	\$25.00
42,0001,6467,10	.045 Contact tips M8	•	•	•	•	\$25.00
42,0001,4751,10	.045 Aluminum tips M8	•	•	•	•	\$25.00
42,0001,6468,10	.052 Contact tips M8	•	•	•	•	\$25.00
42,0001,6469,10	1/16 Contact tips M8	•	•	•	•	\$25.00
Clamps						MSRP
44,0350,3315,5	Clamping piece .030	•	•	•	•	\$114.00
44,0350,3317,5	Clamping piece .035	•	•	•	•	\$114.00
44,0350,3318,5	Clamping piece .045	•	•	•	•	\$114.00
44,0350,3320,5	Clamping piece .052 1/16	•	•	•	•	\$114.00
Software options						
Part No	Description					MSRP
4,066,014	Welding process LSC	•	•		•	\$2,138.00
4,066,015	Welding process PMC	•	•		•	\$1,484.00
4,066,016	Welding process CMT	•	•		•	\$6,014.00
4,067,002	Option Jobs	•	•		•	\$477.00
4,067,003	Option Documentation	•	•		•	\$1,092.00
4,067,004	Option Limit Monitoring	•	•		•	\$1,148.00

All hardware options are ordered separately and come uninstalled, in a separate box.

All software options are ordered separately and come pre-installed.

Wire Feeder options		TPS/i Compact	TPS/i split Series	TransSteel	
Part No	Description				MSRP
4,100,605,U	C-Kit Cooling lines for feeder		•		\$130.00
4,100,660,U	Crain lift		•		\$236.00
4,100,872,CK	Basic Display (volts/wf)		•		\$239.00
4,100,779,CK	External Start signal		•		\$308.00
4,100,773,CK	Display Cover		•		\$95.00
4,100,775,CK	Gas purge / wire jog		•		\$154.00
4,100,829,CK	Push Pull Kit		•		\$1,170.00
4,101,005,CK	Digital Display		•		\$995.00
4,100,658,U	Dinse connector (gouge)		•	•	\$239.00
4,100,890	Quick connect for wire conduit		•	•	\$130.00
4,100,606,U	Gas purge / wire jog			•	\$138.00
4,100,609,U	Remote control port			•	\$103.00
4,100,689	Display cover VR 5000			•	\$43.78
4,100,764	Trigger on/off switch			•	\$297.00
4,101,051,U	Digital Display			•	\$602.00
Cooling options					MSRP
4,100,718,U	Coolant line connection, front	•			\$64.00
4,100,612,U	Cooling filter	•	•	•	\$204.00
4,100,778,CK	Level sensor	•	•		\$242.00
40,0009,0180	FCL 10 (Cooling liquid)	•	•	•	\$43.88
Drive Rolls					MSRP
44,0001,1405,4	Drive wheels .030 U Groove	•	•	•	\$159.00
44,0001,1406,4	Drive wheels .035/.040 U Groove	•	•	•	\$159.00
44,0001,1407,4	Drive wheels .045 U Groove	•	•	•	\$159.00
44,0001,1408,4	Drive wheels .052 1/16 U Groove	•	•	•	\$159.00
44,0350,3687	Plastic rollers	•	•	•	\$69.00
44,0001,1432,4	Drive wheels .045 knurled	•	•	•	\$214.00
44,0001,1433,4	Drive wheels .052 1/16 knurled	•	•	•	\$214.00

All hardware options are ordered separately and come uninstalled, in a separate box.

Cart Options

Cart Matrix		Part number	4,077,009	4,077,014	4,077,020	4,077,019	4,077,001	4,077,016	4,077,026	
TU - Transport Unit Car 2 - Carriage with 2 wheels Car 4 - Carriage with 4 wheels O - Optional S - Comes standard R - Required			\$ 308	\$ 392	\$ 683	\$ 560	\$ 301	\$ 740	\$ 211	
			TU Car 4 Basic ⁽³⁾	TU Car 4 Std.	TU Car 4 Pro ⁽³⁾	TU Car 2 Easy	TU Podium ⁽³⁾	TU lifting facility	TU Wall Mount	
POWER SOURCE										
TSt 2200C / TT/MW 230i			•	•	•	•			•	
TSt 3500 / 5000 Syn					•		•		•	
TSt 3500C / TPS 320iC			•	•	•		•	•	•	
TSt 2700C / TPS 270iC ⁽²⁾			•	•	0		•		•	
TPS 320/400/500/600i					•		•		•	
OPTIONS										MSRP
Turning pintle mount WF15i-30i / VF5000		4,100,613			0					\$189.00
Compact connection plate TU Car 4 Pro		4,100,730			R					\$142.00
Turning pintle mount TU Car 4 Pro (max 50m)		4,100,681			0					\$311.00
Hose pack holder TU Car 4 Pro		4,100,661			0					\$73.00
Crane transport TU Car 4 Pro		4,100,628			0					\$242.00
Turning pintle extension TU Car 4 Pro		4,100,630			0					\$198.00
Extension bottle mounting TU Car 4 Pro		4,101,075			0					\$181.00
Dual bottle mount TU Car 4 Pro		4,101,076			0					\$306.00
Wheel brake TU Car Pro		4,100,321			0					\$549.00
E-set wheel brake Podium		4,100,340					0			\$458.00
I-Kit crane transport		4,100,660,U			0					\$236.00
Distributor double head TSt		4,100,864			0					\$2,087.00
Mounting Case D200		4,100,877			0					\$369.00
OPT/TU Storage tray		4,100,889	0	0	0		0			\$290.00
OPT/TU Pintle mounting platform		4,100,901					0			\$363.00
OPT/TU Tray for Accessories ⁽¹⁾		4,100,906			0		0			\$167.00
OPT/TU Platform Easy		4,101,128				0				\$132.00
OPT/TU assembly set TPS 270i C		4,100,915, CK	S	S	R		R		R	\$48.45
Assembly set TT/ MW 2200 /2500 /3000		4,100,540	R		R		R			\$154.00
Mounting TT/ iWave230i/ MW190/ TSt 2200		4,100,780	R	R	R	S			R	\$144.00
Human 5000 ⁽¹⁾		4,077,007			0					\$1,318.00
Mounting Bracket TPS/FK (requires 2 pcs) ⁽⁵⁾		BY2,0200,8837			R		R			\$7.16
Toolbox 210 L ⁽⁴⁾		4,101,229	0	0	0	0				\$338.00
Toolbox 260 XL ⁽⁴⁾		4,101,230	0	0	0		0			\$470.00
Toolbox 300 XXL ⁽⁴⁾		4,101,231	0	0	0		0		0	\$583.00

 <p>4,077,009 TU Car 4 Basic</p>	 <p>4,077,014 TU Car 4 Standard*</p>	 <p>4,077,020 TU Car 4 Pro</p>	 <p>4,077,019 TU Car 2 Easy</p>
 <p>4,077,001 TU Podium</p>	 <p>4,077,004 Trabant</p>	 <p>4,100,613 Turning pintle mount</p>	 <p>4,100,730 Connection plate</p>
 <p>4,100,681 Turning pintle mount</p>	 <p>4,100,628 Crane transport</p>	 <p>4,100,660 I-Kit Crane transport</p>	 <p>4,100,889 Storage Tray</p>
 <p>4,100,901 Pintle mount platform</p>	 <p>4,100,906 Accessories tray</p>	 <p>4,077,007 Human 5000</p>	 <p>Tool Box Example</p>

* The TU Car 4 Std only holds 150 cu.ft. cylinders, it will not fit 300 cu.ft. cylinders.

- 1) just in combination with 4,100,613 Optional TU turning pintle mounting VR5000/WF15i-30i
- 2) for TU Car 4 Pro and TU Podium 4,100,915 is necessary
- 3) also suitable for TPS and MW/TT/i/Wave welding machine generations and accessories
- 4) per system just one ToolBox is allowed (also if a cooling unit is already mounted) **EXCEPTION** 4,077,010 TU car 2; 4,077,019 TU car 2 Easy; 4,077,014 TU Car 4 Std - only one cooling OR one ToolBox may be used
- 5) the use of a ToolBox in combination with 4,077,007 Human 5000 is not possible
- 6) a water cooled system with a ToolBox can only be used with TU Car 4 Pro - In this case 4,101,075 Verlängerung Flaschenhalter TU Car 4 Pro is necessary
- 7) to mount a ToolBox 210 on a TU Car 4 Std. & TU Car 4 Pro with TT/MW 230i, MW190, and TransSteel 2200 4,100,780 Opt/TU Mounting MW230i/TS 2200 is necessary
- 8) when mounting a TT/MW 3000 or smaller to FK4000 the mounting bracket BY2,0200,8837 (order 2 pcs) must be added separately. This configuration must also include the 8,045,284 mount.



Fronius USA, LLC
Headquarters
6797 Fronius Dr.
Portage, IN 46368
United States
(877) Fronius (376-6487)
sales.usa@fronius.com

Northeast Office
Wixom, MI
(810) 844-2800
sales.northeast@fronius.com
Southeast Office
Chattanooga, TN
(423) 697-1777
sales.southeast@fronius.com

Central Office
Houston, TX
(219) 734-5500
sales.central@fronius.com
Southwest Office
Riverside, CA
(219) 734-5500
sales.southwest@fronius.com

Northwest Office
Oregon City, OR
(219) 734-5500
sales.northwest@fronius.com